



# Powerology

## 27" Portable Smart TV

SKU: PG27FWH



# Table of Contents

Getting Started	2
Accessories	2
Safety Precautions	3
Safe Recycling	6
Warning	6
Precautions for Using Batteries	7
FCC and IC Statement	7
Connections and Ports	9
Remote Control Guide	10
Install Remote Control Batteries	11
Manual Control Button	12
Troubleshooting Guide	13
Specifications	14
Disposal	15
Warranty	16
Contact Us	16

# Getting Started

1. Open the package, remove the device, and place it on a flat surface.

2. Connect the power cord to the device.

**Note:** This is a portable display with a built-in lithium-ion battery. You can either connect the power cord or use the device's battery. For optimal battery health, fully charge the battery after completely draining it, especially when using the device for the first time.

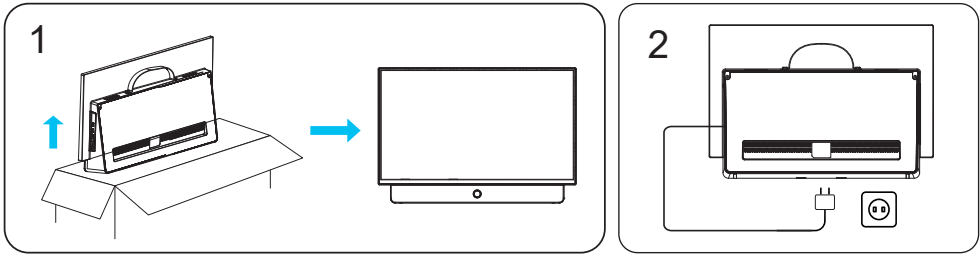

## Accessories

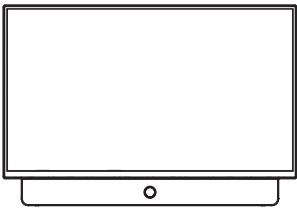

Portable Smart TV



Remote Control

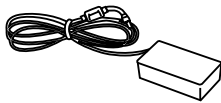

Power Adapter

## Safety Precautions

Please read all instructions before operating the unit.

- 1.** All safety and operating instructions should be read carefully before using this display.
- 2.** Keep these safety and operating instructions for future reference.
- 3.** Adhere to all warnings on the display and in the operating instructions.
- 4.** Operate and use the display according to the manufacturer's guidelines.
- 5.** For safety reasons, do not place this display near pools, basements with wet flooring, or any area exposed to moisture.
- 6.** Clean only with a dry cloth.
- 7.** Do not block any ventilation openings. Use the display in accordance with the manufacturer's ventilation instructions.
- 8.** Do not install the display near heat sources such as direct sunlight, radiators, heat registers, stoves, or amplifiers that produce heat.
- 9.** Do not defeat the safety purpose of the polarized or grounding plug. A polarized plug has two blades with one wider than the other. A grounding plug has two blades and a third grounding prong. If the plug does not fit your outlet, consult an electrician to replace the obsolete outlet.
- 10.** Ensure the power cord is not walked on or pinched, especially at plugs, convenience receptacles, and where it exits the display. Use only accessories recommended by the manufacturer.
- 11.** Use only a cart, stand, tripod, bracket, or table specified by the manufacturer or sold with the display. When moving the unit on a cart, use caution to avoid injury from tip-over.
- 12.** Unplug the display during lightning storms or when not in use for long periods. Refer servicing to qualified personnel if the power cord or plug is damaged, liquid has been spilled, objects have fallen into the display, the display has been exposed to moisture, does not operate normally, or has been dropped.

- 13.** These instructions are for qualified service personnel only. To reduce the risk of electric shock, do not perform any servicing other than that described in the operating instructions unless qualified to do so.
- 14.** Do not install the display in confined spaces such as bookcases or cabinets without proper ventilation. Avoid blocking airflow with items like newspapers, tablecloths, or curtains.
- 15.** Refer to the information on the rear of the display for electrical and safety details before installation or operation.
- 16.** Do not expose the display to rain or moisture to reduce the risk of fire or electric shock.
- 17.** The display should not be exposed to dripping or splashing, and no objects filled with liquids (such as vases) should be placed on it. Do not use the display near dusty environments.
- 18.** The terminals marked with the symbol ( ⚡ ) may contain sufficient voltage to pose a risk of electric shock.
- 19.** The wiring connected to these terminals should be installed by a professional or use ready-made leads or cords.
- 20.** If the remote control battery is replaced incorrectly, it may cause a fire.
- 21.** Always replace the battery with the same or an equivalent type.
- 22.** The remote control battery (or batteries) must not be exposed to excessive heat.
- 23.** Do not expose it to sunlight, fire, or similar heat sources.
- 24.** Listening to music at high volume levels for extended durations can cause hearing damage.
- 25.** To minimize risk, lower the volume to a safe, comfortable level.
- 26.** Limit the amount of time spent listening at high volumes.
- 27.** Before moving the display, turn off the device and unplug it to prevent damage.
- 28.** Periodically inspect the power cord to ensure it is in good condition and not damaged.
- 29.** Proper disposal of batteries is essential to protect the environment.

- 30.** Always dispose of batteries according to local regulations.
- 31.** Do not expose the display to direct flame sources such as candles or any open flames.
- 32.** Keep all sources of fire away from the display.
- 33.** If the display has the symbol (□) in its rating label and the power cord has two pins, it indicates:
- 34.** The equipment is Class II, meaning it is double insulated and does not require a safety connection to an electrical ground.
- 35.** The remote control supplied with this product contains a coin/button cell battery.
- 36.** If swallowed, it can cause severe internal burns within 2 hours, leading to serious injury or even death.
- 37.** Keep both new and used batteries out of reach of children.
- 38.** What to do if the battery compartment doesn't close securely: Stop using the product immediately. Keep the product away from children and contact a service center.
- 39.** DANGER! Seek immediate medical attention if a battery has been swallowed or placed inside any part of the body.

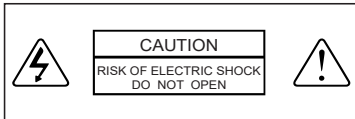

This lightning flash with an arrowhead symbol inside an equilateral triangle is intended to alert the user to the presence of non-insulated "dangerous voltage" within the product's enclosure, which could be of sufficient magnitude to pose a risk of electric shock.

- 40.** To reduce the risk of electric shock, do not remove the cover (or back). There are no user-serviceable parts inside. Please refer to qualified service personnel for assistance.
- 41.** The exclamation point within an equilateral triangle is used to alert the user to important operating and maintenance instructions provided in the accompanying literature.
- 42.** The following symbols are commonly used and should be included as applicable:

~ Refer to alternating current (AC)	⏻ Refer to power ON
⋮ Refer to direct current (DC)	I Refer to power ON
■ Refer to Class II equipment	⚡ Refer to dangerous voltage

## Safe Recycling



The product should not be disposed of with other household waste. To prevent potential harm to the environment or human health from improper waste disposal, please recycle it responsibly to promote the sustainable reuse of material resources. To return your used device, please use the designated return and collection systems or contact the retailer where the product was purchased. They will ensure the product is taken for environmentally safe recycling.

## Warning

To prevent the risk of serious injury or death, especially to children, it is essential to take the following precautions to ensure the stability of your device set:

1. Always place the device on furniture that can safely support it.
2. Ensure the device is not hanging over the edge of the supporting surface.
3. Warn children about the risks of climbing on furniture to reach the device or its controls.
4. Securely collect any cords or cables connected to the device to avoid tripping, pulling, or grabbing hazards.
5. Never position the device on unstable surfaces.
6. Avoid placing the device on tall furniture, such as cupboards or bookcases, unless both the furniture and device are securely anchored to a stable support.

7. Never place the device on cloth or other materials that may create instability between the device and its support surface.
8. Avoid placing tempting items, such as toys or remote controls, on top of the device or the furniture to discourage children from climbing.
9. When relocating or maintaining an existing device set, always follow the same safety considerations to ensure stability.

## **Precautions for Using Batteries**

Improper battery usage can lead to leakage. Please follow these instructions carefully to ensure proper use:

1. Always ensure the correct polarity to avoid damage.
2. When the battery voltage becomes weak, it loses its functionality. Replace the battery promptly. If you do not intend to use the display or remote control for an extended period, remove the batteries from the remote unit.
3. Do not mix different types of batteries (e.g., non-alkaline and alkaline batteries) together.
4. Never place batteries into fire or attempt to charge non-rechargeable batteries.
5. Dispose of batteries in accordance with local environmental protection regulations.

**Warning:** Batteries (battery pack or installed batteries) must not be exposed to excessive heat, such as direct sunlight, fire, or similar sources.

## **FCC and IC Statement**

FCC Statement:

This equipment has been tested and found to comply with the limits for a Class B digital device, pursuant to Part 15 of the FCC Rules.



These limits are designed to provide reasonable protection against harmful interference in a residential installation. The equipment generates, uses, and can radiate radio frequency energy and, if not installed and used in accordance with the instructions, may cause harmful interference to radio communications. However, there is no guarantee that interference will not occur in a particular installation. If this equipment causes harmful interference to radio or television reception, which can be determined by turning the equipment off and on, the user is encouraged to correct the interference by one or more of the following measures:

1. Reorient or relocate the receiving antenna.
2. Increase the separation between the equipment and receiver.
3. Connect the equipment to an outlet on a circuit different from that to which the receiver is connected.
4. Consult the dealer or an experienced radio/TV technician for help.

Changes or modifications to this unit not expressly approved by the party responsible for compliance could void the user's authority to operate the equipment. This equipment complies with part 15 of the FCC Rules, subject to the following two conditions:

1. This device may not cause harmful interference, and
2. This device must accept any interference received, including interference that may cause undesired operation.

This equipment complies with FCC radiation exposure limits set forth for an uncontrolled environment. The equipment should be installed and operated with a minimum distance of 20 cm (8") between the radiator and your body. The device and its antenna(s) must not be co-located or operating with any other antenna or transmitter.

IC Caution:

This equipment complies with Industry Canada's licence-exempt RSS standard(s).

Operation is subject to the following two conditions:

- 1. This device may not cause interference, and
- 2. This device must accept any interference, including interference that may cause undesired operation of this equipment.

This equipment complies with IC radiation exposure limits set forth for an uncontrolled environment. The equipment should be installed and operated with a minimum distance of 20 cm between the radiator and your body. The device and its antenna(s) must not be co-located or operating with any other antenna or transmitter.

The manufacturer is not responsible for any radio or TV interference caused by unauthorized modifications to this equipment. Such modifications could void the user’s authority to operate the equipment.

For operation in the band 5150–5250 MHz, this device is only for indoor use to reduce the potential for harmful interference to co-channel mobile satellite systems. The worst-case tilt angle(s) necessary to remain compliant with the EIRP elevation requirement set forth in Section (3).6.2.2 shall be clearly indicated.

## Connections and Ports

USB 2.0: Connect a USB storage device to the USB port.



HDMI 2.1: Receive a digital input signal from HDMI devices such as a DVD, Blu-ray player, media player, or set-top box.

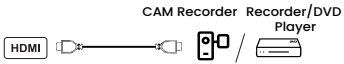

Digital Audio Out: Use an optical cable to output your device's audio signal to a compatible digital audio receiver.



LAN: Connect to a wired network port.



DC IN: Use this port for power input.

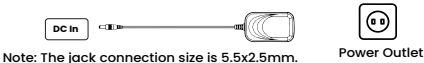

## Remote Control Guide

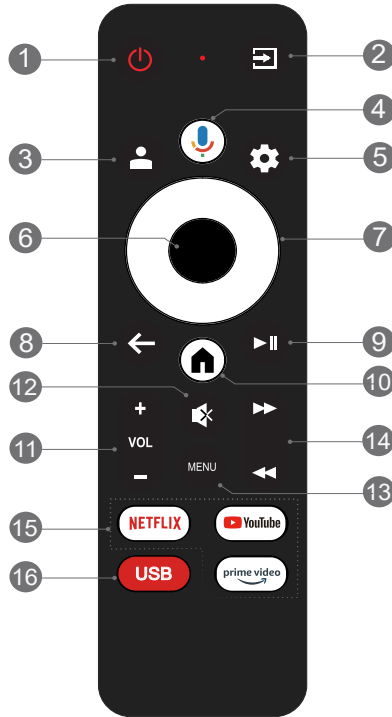

- 1. Power (⏻):** Turn the device on or switch it to standby mode.
- 2. Source (📺):** Access the source menu.
- 3. Account (👤):** Access the account menu.
- 4. MIC (🎤):** Start using the near field voice function.  
Short press the MIC button to wake up the Google Assistant.  
Long press the MIC button to start receiving your voice command.  
After your voice command, release the MIC button to initiate the voice function.
- 5. Dashboard (⚙️):** Access the settings dashboard of your Google Display.

- 6. OK: Confirm, enter, or execute the selected item, or show the list of Quick Buttons.
- 7. Navigation Buttons (UP/DOWN/LEFT/RIGHT): Navigate the menu to select the content you need.
- 8. Back ( ← ): Return to the upper-level content or exit the current screen or operation.
- 9. Pause ( ►|| ): Pause playback.
- 10. Home ( 🏠 ): Access the home screen.
- 11. Volume Up/Down ( +/ - ): Adjust the sound volume.
- 12. Mute ( 🔊 ): Mute or restore the device sound.
- 13. Menu: Show options when playing.
- 14. Skip Forward/Backward ( ►/◄ ): Skip to the next or previous content.
- 15. Application Buttons: Access specific applications quickly and directly.
- 16. USB: Access flash drive contents.

## Install Remote Control Batteries

Insert two AAA size batteries into the battery compartment of the remote control, ensuring that the polarity markings inside the compartment are correctly aligned with the battery ends.

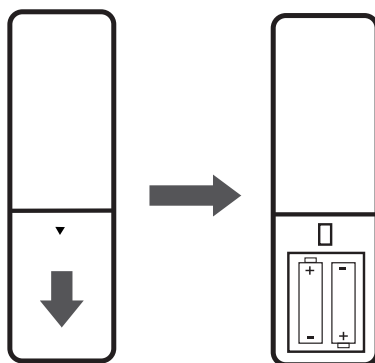

## Manual Control Button

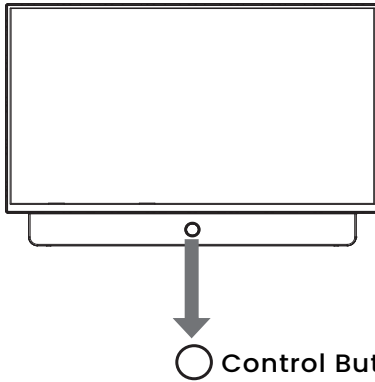

Control Button

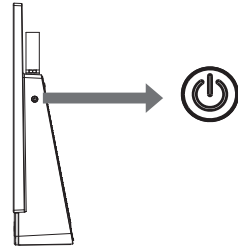

Battery Switch Button

### Turning on the Portable Display

1. To power on the display, first connect the power cable to enter standby mode. Then press the Control button or the power button on the remote control.
2. Alternatively, press the Battery Switch button to enter standby mode, followed by pressing the Control button or the power button on the remote control to turn on the display.

### Notes:

1. Upon connecting the power cable, the device will enter standby and charging mode. The Battery Switch button will be inactive until the power cord is disconnected.
2. For safety reasons and to prevent potential damage to the device or the surrounding environment, disconnect the power cable when the device is not in use for an extended period.
3. To turn off the display, press and hold the Battery Switch button. In battery-powered standby mode, the device will automatically shut down after 2 minutes of inactivity.

## Troubleshooting Guide

Before contacting a service technician, please review the table below for common issues and suggested solutions. This can help resolve the problem quickly.

### **1. General Issues & Solutions:**

#### **1.1 Remote Control Not Working**

Ensure the batteries are installed correctly.

Verify that the remote's power is on.

Check for any obstructions around the remote sensor.

#### **1.2 Weak or No Signal**

Check the signal source to ensure it's connected properly.

Test by plugging another device into the same outlet to confirm functionality.

Ensure that the power plug is securely connected to the outlet.

### **2. Picture & Sound Issues:**

#### **2.1 No Picture or Sound**

Confirm that the signal source is working.

Ensure the power plug is properly connected.

Check that the device is receiving a signal and the input is correct.

#### **2.2 No Sound, Picture OK**

If the picture is fine, but there's no sound, increase the volume or check sound settings.

Open the audio menu and verify the "Balance" settings to ensure sound is output from the desired speakers.

#### **2.3 Abnormal Picture Quality**

For a distorted picture or lack of color, adjust the color settings in the menu.

Keep the device at a safe distance from other electronic devices to avoid interference.

**3. Multimedia Player Issues: Audio and Video Playback Issues** If you see error messages such as “Invalid file” or “Unsupported audio,” ensure the file is compatible with the device.

If only the audio or video is functioning, check the file format and the device’s supported codecs.

Ensure the media file is not corrupted by playing it on a different device.

**4. Network & Connection Issues: Network Connectivity Problems** Ensure the router is functioning properly.

Confirm that the Display is connected to the network and that there are no interruptions.

**5. Browser Issues:**

**5.1 Web Page Not Displayed Fully**

Some third-party extensions or web pages might not be fully compatible. Try closing the current page and reloading it.

**5.2 Browser Shutdown Unexpectedly**

This may be caused by insufficient system memory. Try closing unnecessary programs or tabs to free up memory for the browser.

## Specifications

Model	PG27F
Screen Size	27-Inch
Display Type	TFT-LCD
Resolution	1080 x 1920p
Brightness	300–350 cd/m2
Contrast Ratio	1000:1
Refresh Rate	60Hz
Rated Power	65W
Working Time	7 hours

Viewing Angle	H: 178°, V: 178°
Color Saturation	1.07B (8bit)
Input Voltage (DC)	19V Normal (9V Min - 30V Max)
Input Voltage (AC)	100-240V, 60/50Hz (AC Adapter)
Battery Capacity	38400mAh (21700 cells, 4 series)
RAM	1GB
EMMC Flash	8GB
CPU	CA55×4
GPU	G3IMP2
Operating System	Google OS 5.0, Android 14
Wireless Connection	WiFi 2.4GHz/5GHz
Built-in Speakers	10W x 2,8Ω
Ports	DC Port, RJ45, SPDIF, HDMI 2.1, USB2.0
Product Size	99×418×616.5mm
Product Weight	5.45kg±0.3kg

To view the manual in other languages, please refer to the website and the product page

## Disposal

This product must not be disposed of as unsorted household waste. It is important to separate such waste for proper treatment and recycling, in compliance with local waste management regulations.



## **Warranty**

Products that you buy directly from our **Powerology** website or shop come with a 24-month warranty.

The 24-month warranty applies to products purchased directly from our **Powerology** website or store. If **Powerology** products are bought from any of our verified retailers, then the product is eligible for only a 12-month warranty. To extend your product's warranty, visit our website **powerology.me/warranty** and fill in your details in the provided form along with an uploaded picture of the product to process your request. Once approved, you will receive a confirmation email of the extended product warranty. Upload the required information within 48 hours of purchase to be eligible for a 24-month warranty period.

For more info, please check:  
**powerology.me/warranty**

## **Contact Us**

If you have any questions about this Privacy Policy, please contact us at: **hey@powerology.me**

Website: **powerology.me**

Instagram: **powerology\_official**

Facebook: **powerology.ME**