



**Powerology**

**VIVANT Mini Thermal Printer**

SKU: PKDCZ2WH

# Table of Contents

Product Overview	2
Indicator Status	3
Consumable Installation Instructions	3
Printing Instructions	5
Precautions	6
Specifications	7
Battery Charging	7
FCC Statement	8
Disposal	9
Warranty	10
Contact Us	10

# Product Overview

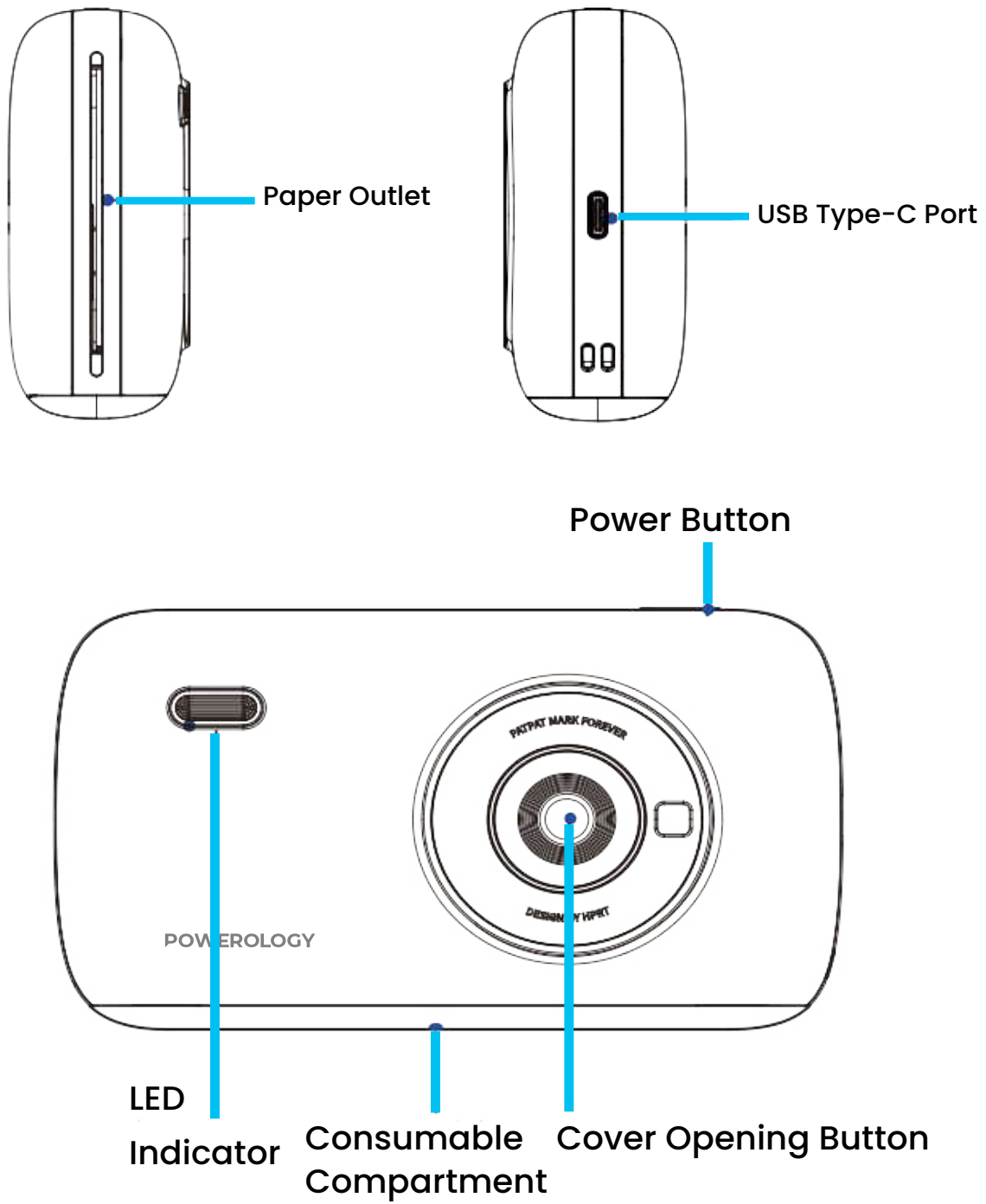

## Accessories



USB Cable



Quick Start Guide



Consumables

## Important Note

If you encounter a paper or ribbon jam that cannot be resolved, please do not attempt to forcefully remove it. Instead, contact a service center for assistance.

## Indicator Status

### Red LED

**Solid ON:** Paper jam / Paper end / Printed photo not removed / Ribbon end / Ribbon abnormal

**Slow Flash:** Low power

**Quick Flash:** Printer is overheated

### Blue LED

**Solid ON:** Charging complete / Printer is ready / Printing in progress

**Slow Flash:** Charging

**Quick Flash:** Powering on

### Red and Blue LEDs

**Alternating Flash:** Firmware upgrade in progress

**Note:** Please verify the Bluetooth connection status of the printer through the app.

## Consumable Installation Instructions

1. Press the cover release button to open the consumable compartment.



**2.** Insert the consumable into the compartment, following the orientation indicated below. Place your finger in the "Push" position and press until you hear a "click" sound.

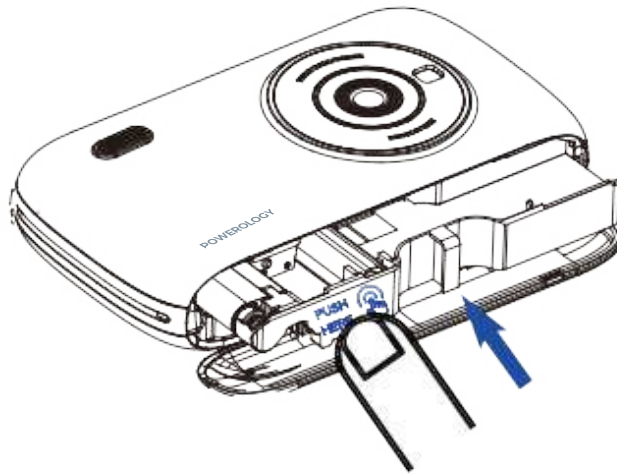

**3.** Close the consumable compartment securely.

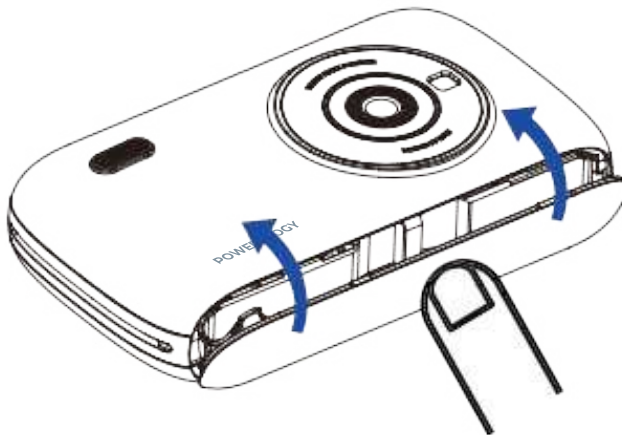

### **Important Notes:**

- 1.** The photo paper is highly sensitive to moisture. Please use it as soon as possible after opening.
- 2.** This device is only compatible with the official photo paper that comes with the ribbon. Do not attempt to replace it yourself.
- 3.** Store the consumables in a place where they are protected from excessive direct sunlight and extreme temperatures.
- 4.** If the consumable is damaged or deformed by external force, do not forcefully insert it into the device.

## Printing Instructions

**1.** Press and hold the power button for 3 seconds until the blue light flashes quickly. Then release it to turn on the printer.

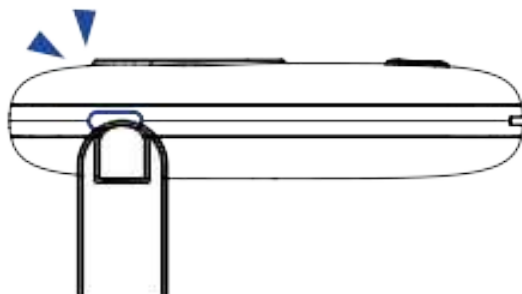

**2.** Scan the QR code to download the app. Open the app, click "Add Device", and "Connect" with "CP2100-XXXX" (XXXX are the last four digits of the Bluetooth address).

**3.** Choose the photo you want to print and adjust it in the preview section.



**4.** Click "Print" to start the printing process.

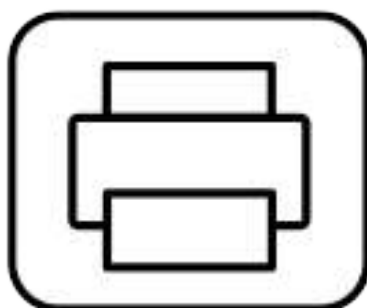

## Important Notes:

1. After the initial connection, you only need to click the print icon for subsequent use. The printer will automatically connect and print.
2. Do not exit the app during the printing process, as this may cause printing failure.

## Precautions

1. The optimal operating temperature for the printer is between 5°C and 40°C. High ambient temperatures may affect print quality.
2. Always use official ribbons and photo paper to ensure optimal printing results.
3. Avoid disassembling the ribbon and photo paper yourself. If the glossy surface of the photo paper is contaminated, print quality may be affected.
4. Do not forcibly remove the consumables during printing, as this may damage the printer.
5. When not in use for extended periods, close the consumable compartment to keep out dust and debris.
6. After printing multiple photos consecutively, the device may trigger overtemperature protection. This is normal, and the printing process will resume once the device cools down.
7. Do not perform any operations while the device is powering on.
8. Place the printer on a flat, stable surface such as a desktop.
9. Ensure there is at least 10 cm of clearance around the paper outlet to avoid obstruction.

## Specifications

Input	5V/2A
Resolution	300 DPI
Battery Capacity	800mAh
Recharge Time	3H
Print Speed	40 Seconds per Sheet
Paper Width	5.5cm
Bluetooth Version	5.0
Printing Mode	Thermal / Inkless
Charging Interface	USB-C
Connectivity	Bluetooth 4.0+
Product Weight	280g

## Precautions

- 1.** When the battery power is low, the red LED indicator will flash slowly. Please charge the device using the included USB cable. If you continue printing without charging, the device may automatically power off.
- 2.** Plug one end of the USB cable into the printer's port and the other end into the power adapter. After connection, the blue LED indicator will flash slowly to indicate charging.
- 3.** The charging time is approximately 90-120 minutes. Once charging is complete, the blue LED indicator will remain solid.

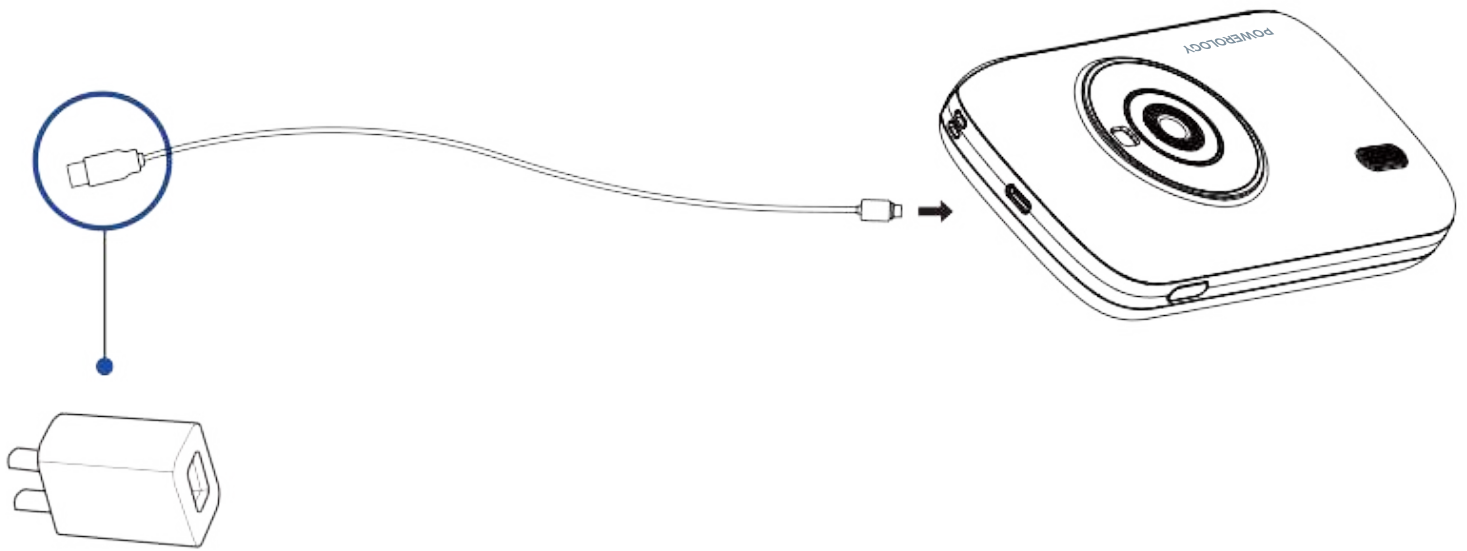

## Precautions

This device complies with part 15 of the FCC Rules. Operation is subject to the following two conditions:

This device must not cause harmful interference.

This device must accept any interference received, including interference that may cause undesired operation.

Any changes or modifications not expressly approved by the responsible party for compliance could void the user's authority to operate the equipment.

**Note:** This equipment has been tested and found to comply with the limits for a Class B digital device, pursuant to Part 15 of the FCC Rules. These limits are designed to provide reasonable protection against harmful interference in a residential installation. This equipment generates, uses, and can radiate radio frequency energy and, if not installed and used in accordance with the instructions, may cause harmful interference to radio communications.

However, there is no guarantee that interference will not occur in a particular installation. If this equipment does cause harmful interference to radio or television reception, which can be determined by turning the equipment off and on, the user is encouraged to try correcting the interference by one or more of the following measures:

Reorient or relocate the receiving antenna.

Increase the separation between the equipment and receiver.

Connect the equipment to an outlet on a circuit different from that to which the receiver is connected.

Consult the dealer or an experienced radio/TV technician for help.

To maintain compliance with FCC's RF Exposure guidelines, this equipment should be installed and operated with a minimum distance of 20 cm from the radiator body. Use only the supplied antenna.

FCC ID: 2AUTE-2TS22H

## **Disposal**

This product must not be disposed of as unsorted household waste. It is important to separate such waste for proper treatment and recycling, in compliance with local waste management regulations.



## **Warranty**

Products that you buy directly from our **Powerology** website or shop come with a 24-month warranty.

The 24-month warranty applies to products purchased directly from our **Powerology** website or store. If **Powerology** products are bought from any of our verified retailers, then the product is eligible for only a 12-month warranty. To extend your product's warranty, visit our website **powerology.me/warranty** and fill in your details in the provided form along with an uploaded picture of the product to process your request. Once approved, you will receive a confirmation email of the extended product warranty. Upload the required information within 48 hours of purchase to be eligible for a 24-month warranty period.

For more info, please check:  
**powerology.me/warranty**

## **Contact Us**

If you have any questions about this Privacy Policy, please contact us at: **hey@powerology.me**

Website: **powerology.me**

Instagram: **powerology\_official**

Facebook: **powerology.ME**