



Powerology

Portable Electric Tire Inflator

SKU: PSM018

Table of Contents

Schematic View	2
Components	3
Presta Valve Installation Method	3
Schrader Valve Installation Method	4
Usage Steps	6
Charging and Battery Display	6
Usage of Accessories	7
Detect Air Pressure	7
Recommended Pressure	7
Recommended pressure Values	8
Mode Switching	9
Default Value Fine-Tuning	9
Start Inflation	10
Stop Inflation	10
Battery and Endurance	10
Turn Off	11
Important Notes	11
Specifications	12
Troubleshooting	13
Error Code Table	14
Disposal	15
Warranty	16
Contact Us	16

Before using the product, please carefully read this User Manual to guarantee correct usage and keep it secure for future reference.

Schematic View

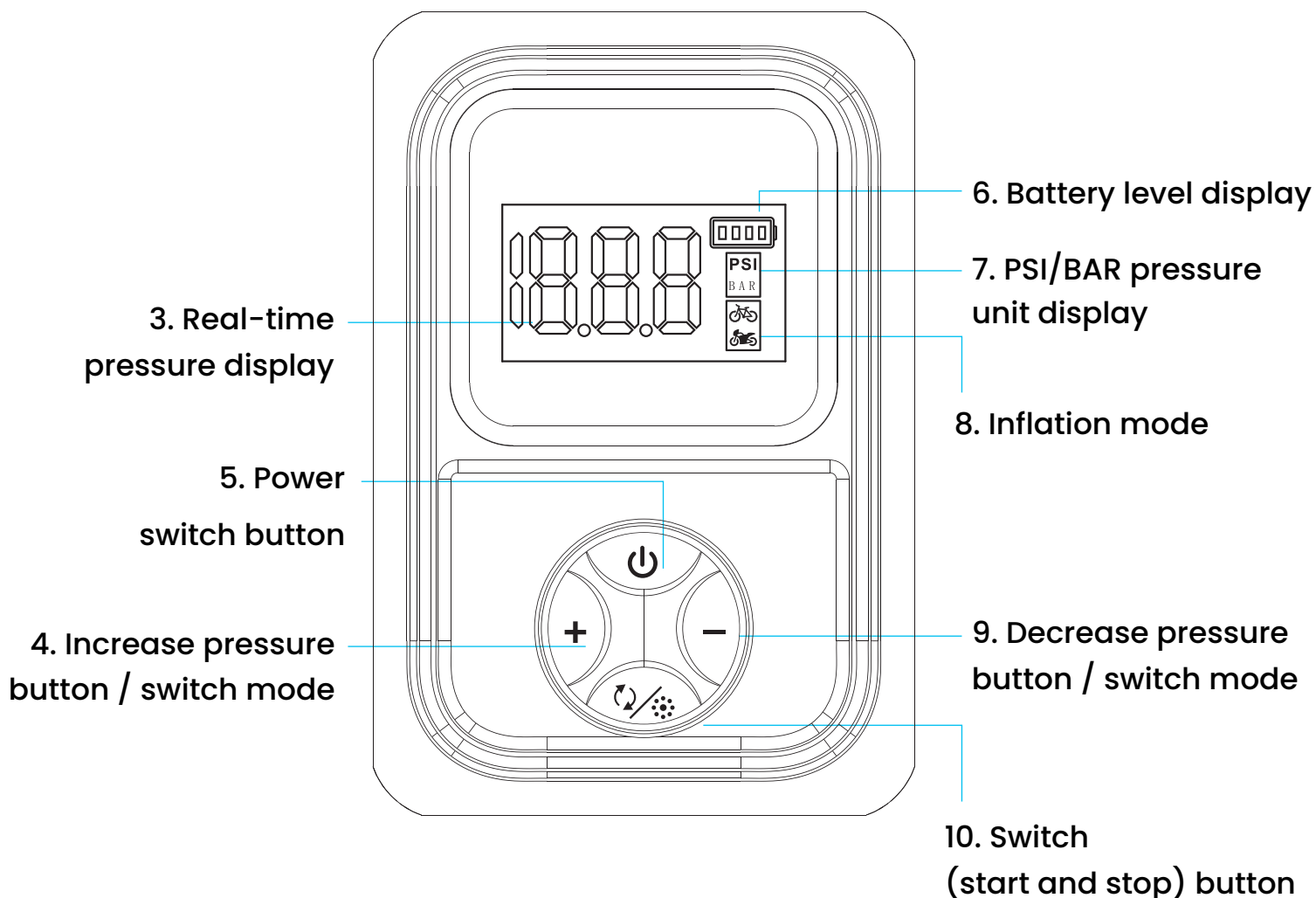

11. Type-C charging port

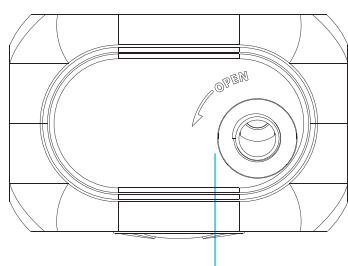

1. Outlet

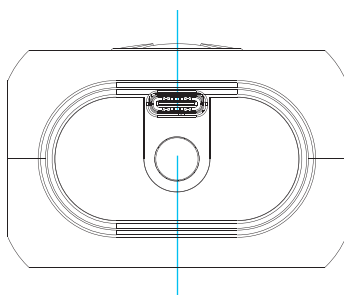

12. Light

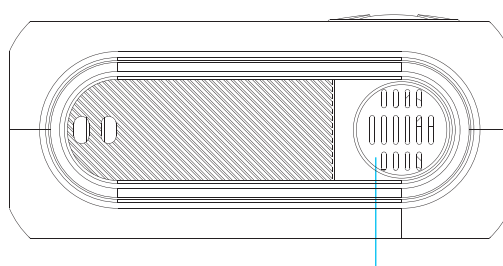

2. Heat dissipation air outlet

Components

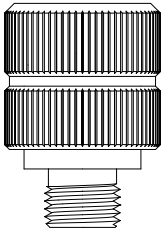

Schrader Valve/
Presta Valve *1

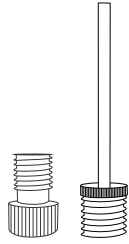

Multiple
Nozzles *2

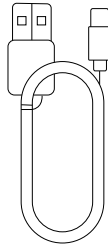

Type-C Charging
Cable *1

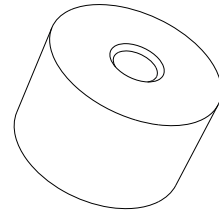

Nozzle Seal
Ring *1



Air Hose *1

Presta Valve Installation Method



Assemble in the order shown in the diagram

Nut

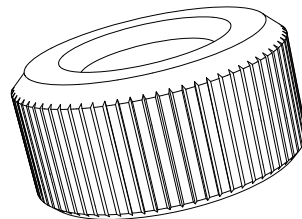

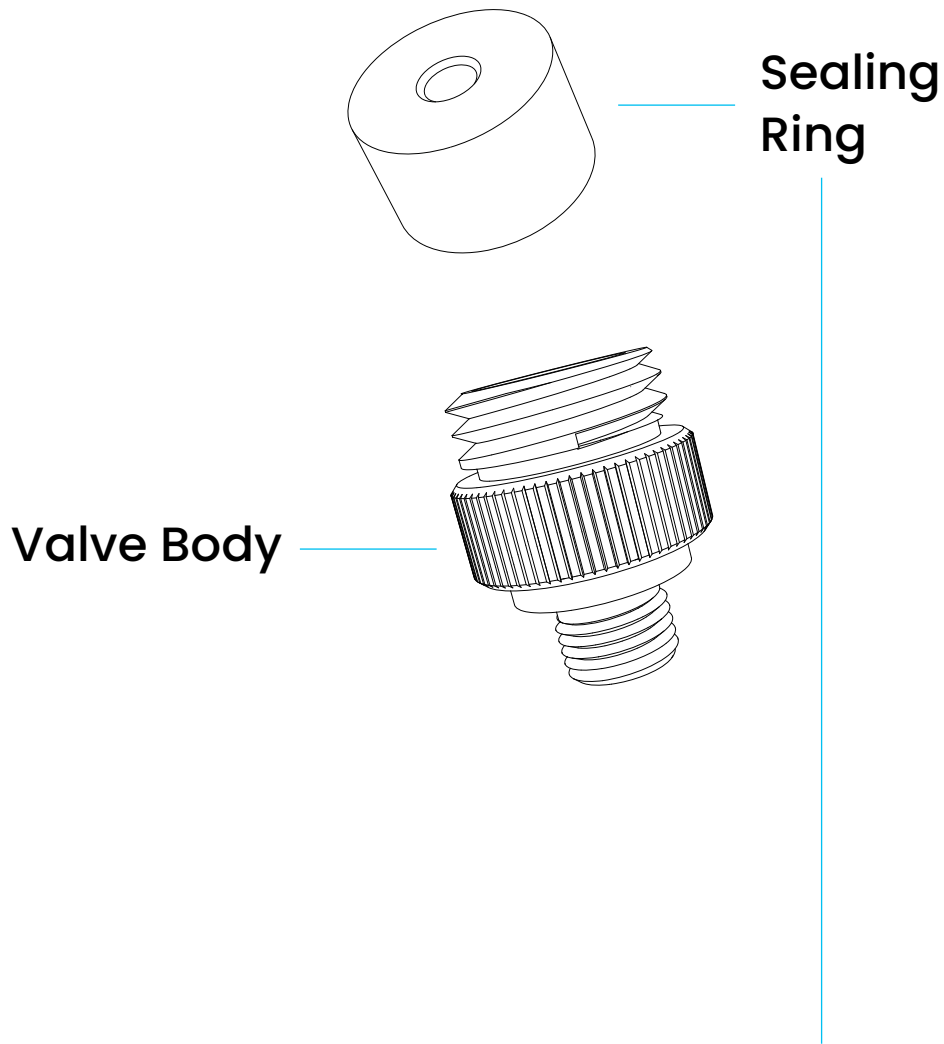

Install the sealing ring with the small opening facing outward, and then tighten the nut.

Schrader Valve Installation Method



Assemble in the order shown in the diagram

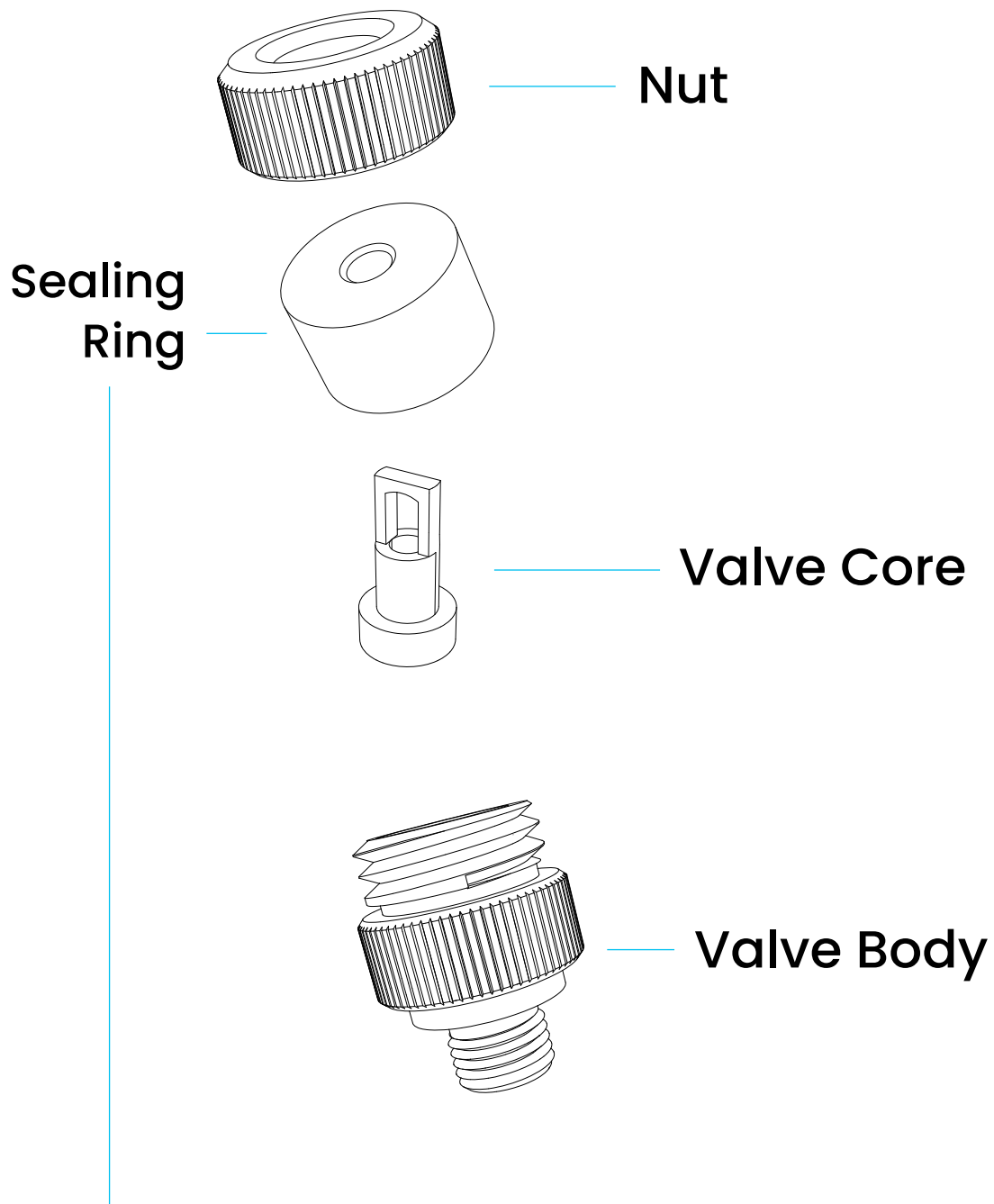

Install the sealing ring with the large opening facing outward, and then tighten the nut.

Note: After the air pump runs continuously for three minutes, it should rest for eight minutes before being used again. Be cautious, as the air pump's outlet may become hot—do not touch it!

Usage Steps

- 1. Connect Hose or Nozzles:** Screw the hose or nozzle into the outlet port.
- 2. Turn On the Device:** Press and hold the switch button for 3 seconds to turn on the device.
- 3. Switch Modes:** Long press the '+'/'-' buttons to switch modes when the preset pressure value stops flashing.
- 4. Adjust Pressure:** Short press the '+'/'-' buttons. When the preset value begins to flash, press again to adjust the value.
- 5. Turn Off the Device:** Long press the switch button to turn off the device.
- 6. Switch Units ():** Short press the button to switch between PSI and bar; long press for 3 seconds to turn on the flashlight, and press again for 3 seconds to turn it off.
- 7. Store the Product:** Store the product in a dry place to prevent moisture buildup.

Charging and Battery Display

- 1. Charging:** Use a 5V/2A charger and insert it into the Type-C charging port. The four battery level bars will flash in sequence (indicating charging). Once the battery is fully charged, the battery bars will stop flashing (indicating full charge).
- 2. Low Battery:** When the battery level drops to the specified voltage, the battery display will flash. The product will continue to operate until the voltage drops below the shutdown threshold, at which point it will automatically shut down. At this time, the product needs to be charged.

Usage of Accessories

- 1. Schrader Valve:** Mountain bikes, electric bikes, and motorcycles usually use the Schrader valve. Connect it directly for inflation.
- 2. Presta Valve:** Road bikes and some mountain bikes use the Presta valve. When inflating, connect the Presta valve to the pump hose and inflate as usual.
- 3. Needle:** For inflating balls such as basketballs and soccer balls, use the "Needle." Connect the needle to the pump hose, then insert the needle into the air hole for inflation.

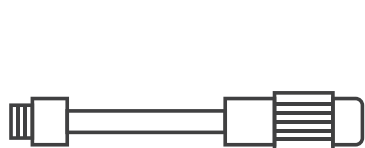

1

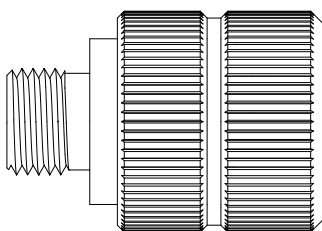

2

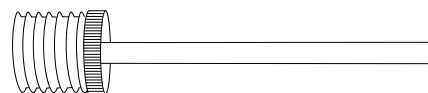

3

Detect Air Pressure

When powered on and correctly connected to the device, the displayed pressure value represents the real-time pressure of the tested device.



Recommended Pressure

To ensure safety, please check the required pressure for each product. Avoid over-inflation, as it may lead to explosion and cause personal injury.

Recommended Pressure Values

Product Category	Product Type	Recommended Pressure Range
Bicycle	Folding Bike Tire	45-50psi
	16 ,14 ,12 inch Bicycle Tires	30-50psi
	24 ,22 ,20 inch Bicycle Tires	40-50psi
	29 ,27.5 ,26 inch Bicycle Tires	45-65psi
	700c Road Bike Hard Tire	100-110psi
	700c Road Bike Soft Tire	100-130psi
Motorcycle	Motorcycle, Electric Motorcycle Wheel Rim	30-43psi
Ball	Basketball	7-9psi
	Soccer Ball	8-16psi
	Volleyball	4-5psi
	Rugby	2-14psi

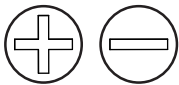
Mode Switching

-  Long press the (+) or (−) button to toggle between Bicycle Mode and Motorcycle Mode when the preset pressure value stops flashing.
-  Short press this button to switch between modes; long press for 3 seconds to turn on the light, and press again for 3 seconds to turn it off.

Note: There is no special mode. The factory preset pressure is 45 psi, and the preset pressure can be adjusted within the range of 3–150 psi before use.

Inflation Mode	Default Pressure Valve	Adjustable Range
	Bicycle Mode 45psi	30–145psi
	Motorcycle Mode 32psi	25–45psi
	Free Mode Preset Pressure Valve	3–150psi

Default Value Fine-Tuning

Short press the (+) and (−) buttons to manually increase and decrease the preset tire pressure value.

Start Inflation

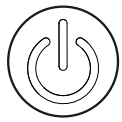

Press the 'Start/Stop' button briefly to begin inflation. During inflation, the display will show real-time pressure changes. Please note that inflation generates noise around 75–80dB, so take appropriate precautions. Prolonged operation may cause noticeable temperature increases in the high-pressure hose and the device body. Please avoid prolonged contact with the high-pressure hose.

Stop Inflation



The inflation pump will automatically stop when the pressure reaches the preset value. During inflation, you can also manually stop the inflation process by pressing the 'Start/Stop' button.

Note

For inflatable products such as balloons, toy balls, swim rings, etc., if the inflation pressure is lower than the air inflatable pump's range, it will not automatically stop inflation through preset pressure. Caution is advised during use.

Battery and Endurance

In a fully charged state, at an ambient temperature of 25°C, the continuous working time without load is approximately 2 minutes. Increased pressure load or lower ambient temperature will result in reduced endurance.

Turn Off

In the powered-on state, press and hold the power button for 3 seconds to turn off (or the product will auto-stop after 120 seconds of inactivity). Short press the LED light button to turn the LED on/off. When the LED light is turned off and the product is not in operation, it will auto-stop after 120 seconds.

Important Notes

- 1.** Before inflation, please ensure that you confirm the required pressure value to avoid over-inflation, which can cause personal injury.
- 2.** The product contains a non-removable lithium battery. Do not throw it into fire or discard it casually, as it presents risks such as overheating, impact, and water ingress, which can lead to fire, spontaneous combustion, or explosion. Avoid exposing it to high temperatures.
- 3.** Do not fold or step on the inflation hose during inflation to ensure smooth airflow.
- 4.** While the inflation pump is in operation, the operator must stay onsite. Always monitor the process to prevent overpressure due to unplanned events or excessively long inflation times.
- 5.** The inflation pump contains a DC motor, which may generate sparks during operation. Do not place it near flammable liquids or gases.
- 6.** The product's storage temperature should not fall below -10°C or exceed 60°C . Both extreme heat and cold can shorten the

- product's lifespan and damage the battery.
- 7.** If the product is not in use for an extended period, the battery may be damaged. It is recommended to recharge the product at least every three months.
- 8.** This product is not a toy and is not intended for use by children. Users should be at least 16 years of age. During the inflation process, ensure that children remain at a safe distance from the inflator.
- 9.** Before setting the inflation pressure value, confirm that the correct unit of measurement is selected. Choosing the wrong unit may result in dangerously high pressure. Common unit conversions are as follows: 1 bar = 14.5 psi = 100 kPa.

Specifications

Model Number	SM018
Input	5V/1A
Rated Power	48W
Battery Capacity	600mAh
Inflation Pressure	3-150 PSI
Cylinder Diameter	13mm
Charging Interface	USB-C
Product Size	56 x 36×83mm
Product Weight	180g

Troubleshooting

1. Issue: Slow inflation speed.

Solution: Ensure the battery is fully charged. Check for air leaks in the hose and ensure tight connections at both ends of the hose.

2. Issue: Unable to inflate although the device is turned on.

Solution: Check if the battery is fully charged and verify that the current tire pressure is higher than the preset value.

3. Issue: Unable to adjust pressure up or down.

Solution: Make sure the correct mode is selected. In free mode, there should be no illuminated icons. Adjust the pressure value within the range of 150–3 psi.

4. Issue: Normal inflation, but pressure shows zero.

Solution: Products like balloons with low pressure may not fall within the measurable range of the device.

5. Issue: Pump automatically shuts off after attaching the nozzle.

Solution: Press and hold the "Power" button to turn the device on again.

6. Issue: Air leakage when connecting the hose.

Solution: Tighten the air hose.



Error Code Table

Er0 = Sensor calibration error, detected during calibration process.

Er1 = Battery low voltage alarm, detected during the discharge process. Displays "LO" or "Er1", shuts down all outputs, then enters hibernation mode.

Er2 = Motor overcurrent protection, detected when the motor is running. Displays "Er2", stops the motor, enters standby mode.

Er3 = Motor short circuit protection, detected when the motor is running. Displays "Er3", stops the motor, enters standby mode.

Er4 = Motor over-temperature protection, detected when the motor is running. Displays "Er4", stops the motor, enters standby mode.

Er5 = Motor NTC damaged, open or short circuit, detected when the motor is running. Displays "Er5", stops the motor, enters standby mode.

Er6 = Sensor NTC damaged, open or short circuit, detected during the power-on process. Displays "Er6", stops the motor, enters standby mode.

Er7 = Pressure exceeds 150 psi, detected during the pressure measurement process. Displays "Er7", serves as a reminder.

Er8 = Battery over-temperature (high or low temperature), detected during the charge/discharge process. Displays "Er8", shuts down all outputs and enters standby mode. During the discharge process, stops charging and displays error code until protection is removed.

EOP = When the air pump's protection mechanism is activated, please refer to the user manual for detailed instructions on correcting errors.

Disposal

This product must not be disposed of as unsorted household waste. It is important to separate such waste for proper treatment and recycling, in compliance with local waste management regulations.



Warranty

Products that you buy directly from our **Powerology** website or shop come with a 24-month warranty.

The 24-month warranty applies to products purchased directly from our **Powerology** website or store. If **Powerology** products are bought from any of our verified retailers, then the product is eligible for only a 12-month warranty. To extend your product's warranty, visit our website **powerology.me/warranty** and fill in your details in the provided form along with an uploaded picture of the product to process your request. Once approved, you will receive a confirmation email of the extended product warranty. Upload the required information within 48 hours of purchase to be eligible for a 24-month warranty period.

For more info, please check:
powerology.me/warranty

Contact Us

If you have any questions about this Privacy Policy, please contact us at: **hey@powerology.me**
Website: **powerology.me**
Instagram: **powerology_official**
Facebook: **powerology.ME**