



Powerology

2300W Universal Travel Adapter

SKU: PWCUQC043

Table of Contents

Schematic View	2
Specifications	3
Applicable Outlets	4
Instructions for Use	5
Replacement of the Fuse	6
Caution	7
Disposal	7
FCC Statement	8
Warranty	9
Contact Us	9



Schematic View

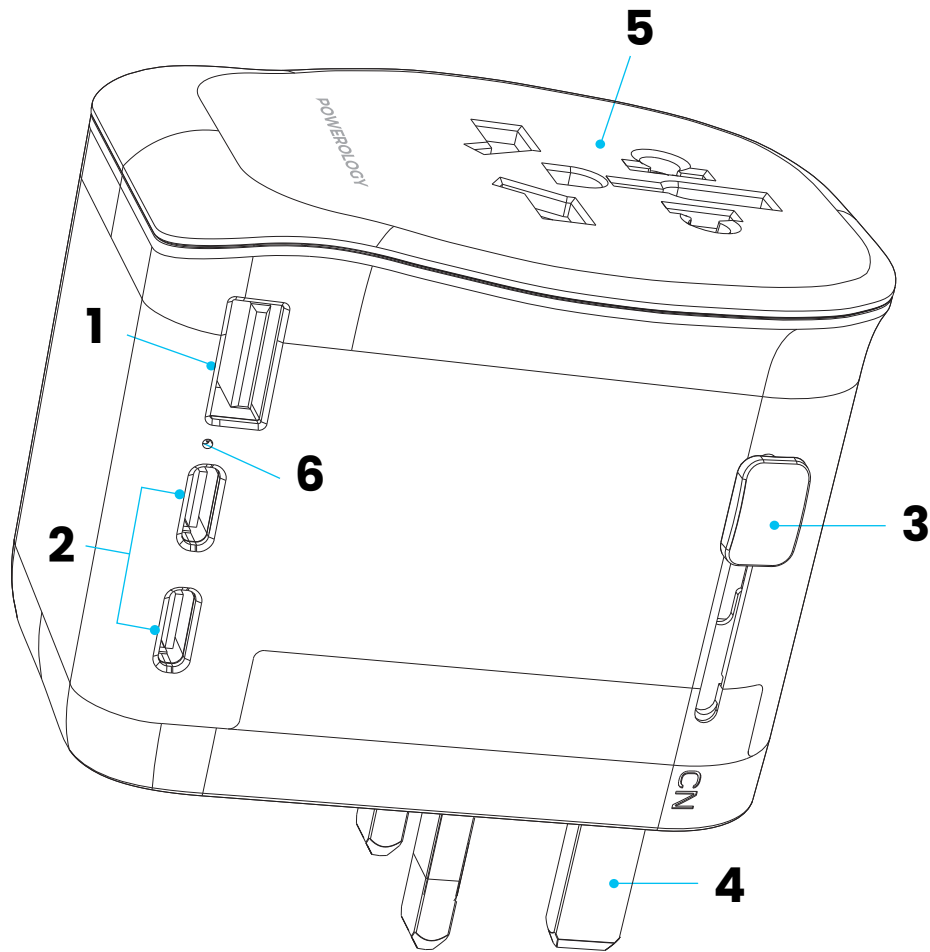

1. USB-A1 Port

2. USB-C2/C1 Ports

3. Slider

4. US/CN/UK/DE Plugs

5. Multi-socket

6. LED Indicator

6.1 LED solid: normal operation

6.2 LED does not light:

Possible overload. Unplug one device and check the status indicator again.

Fuse burn-out. Please check the fuse.

Specifications

Model Number	PWC043
Ratings (US)	125V~60Hz, 10A Max, 1250W Max
Ratings (DE/UK/CN)	250V~50Hz, 10A Max, 2300W Max
USB-C1 Output	5V/3A, 9V/3A, 12V/3A, 15V/3A, 20V/2.25A (45W)
USB-C2 Output	5V/2.1A (10.5W)
USB-A1 Output	5V/2.1A (10.5W)
USB-C1 Output	5V/2.4A, 9V/2.77A, 12V/2.25A, 15V/1.8A, 20V/1.35A (27W)
Sharing Output	
USB-C1	5V/2.4A, 9V/2.77A, 12V/2.25A, 15V/1.8A, 20V/1.35A, 27W
USB-C2 + A1	5V/2.1A, 10.5W Max
USB-C2 + A1 Output	5V/2.1A (10.5W Max)
Total DC Output	45W
Dimensions	79.5x62.9×66.3mm
Operating Temperature	0°C~ 35°C

Applicable Outlets

1. The adapter supports Type A, B, I, G, and L plugs. Compatible with outlets in the USA, Canada, UK, China, Italy, and more.

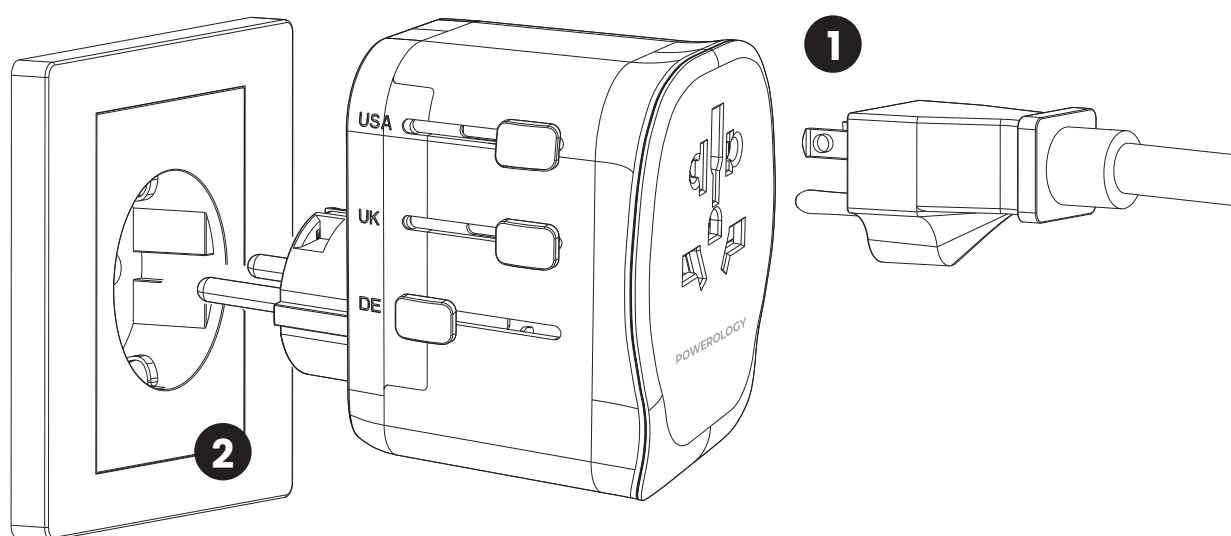
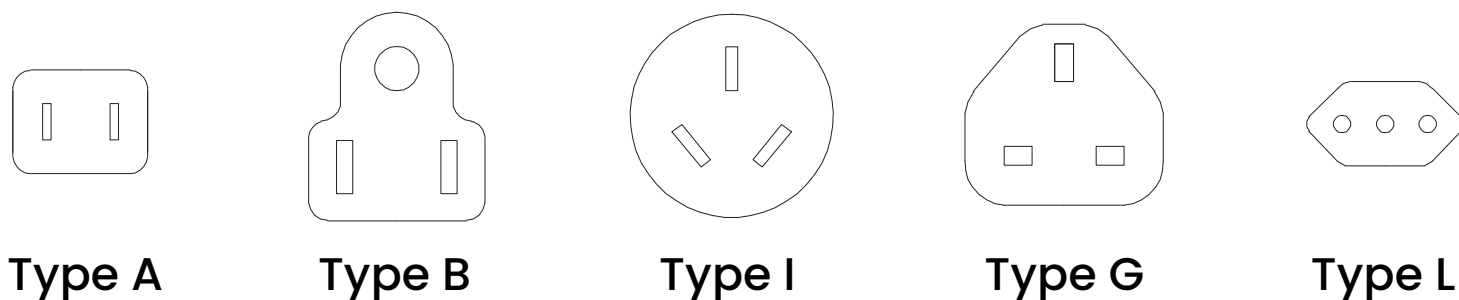

2. The adapter can also plug into Type B, G, I, F, and E outlets. Suitable for use in the USA, Canada, UK, China, Germany, France, and others.

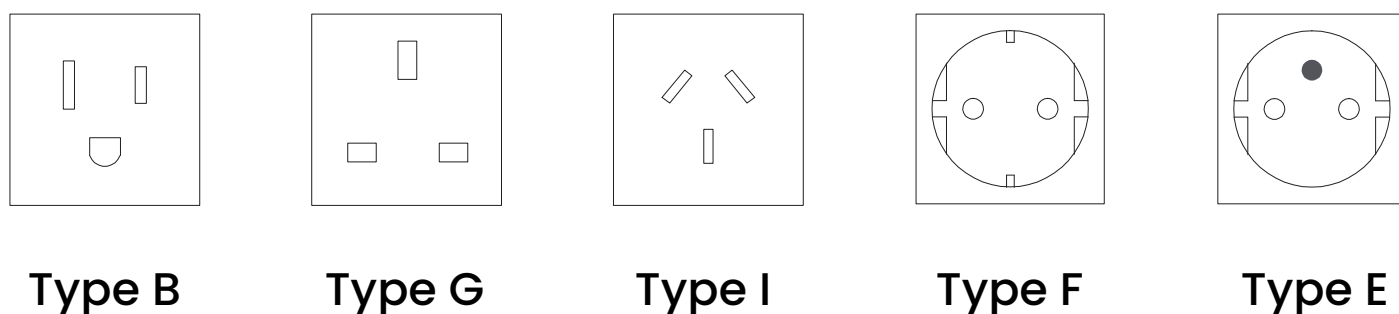

Instructions for Use

Important Notes:

1. Ensure the button is properly reset when pushed out and retracted to the bottom. If the button is not reset, it means the plug has not been inserted correctly, which may affect normal operation.
2. Only one plug type can be used at a time. Slide the knob to select the plug type. Other plug pins will be automatically locked.

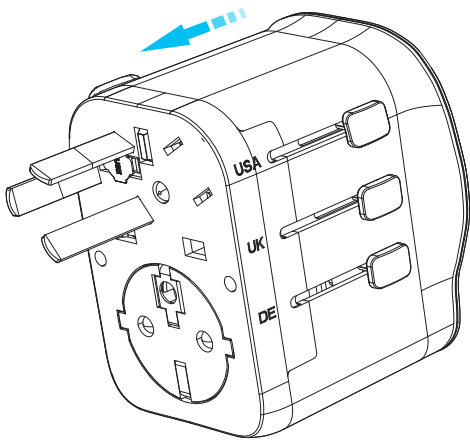

Using the CN Plug:

Slightly press the button and slide it down to fully insert the CN plug, as shown. Press and hold the "CN" button to release the plug. Continue pulling it up until the plug is fully ejected. Once released, the button will reset and lock the plug.

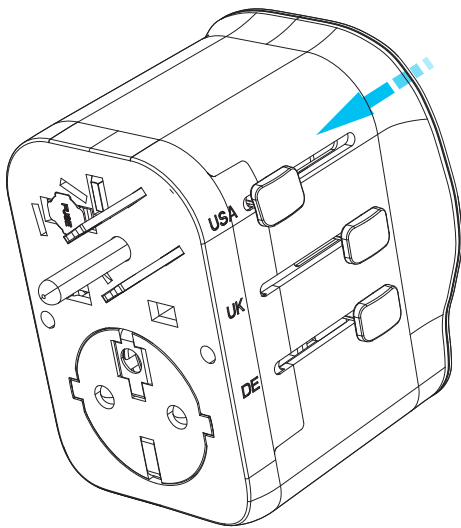

Using the US Plug:

Slightly press the button and slide it down to fully insert the US plug, as shown. Press and hold the "USA" button to release the plug. Continue pulling it up until the plug is fully ejected. Once released, the button will reset and lock the plug.

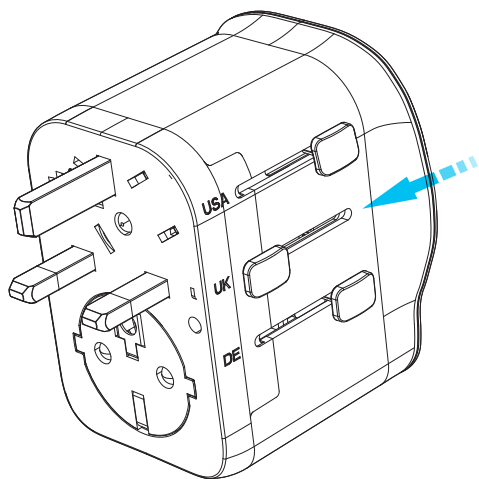

Using the UK Plug:

Slightly press the button and slide it down to fully insert the UK plug, as shown. Press and hold the "UK" button to release the plug. Continue pulling it up until the plug is fully ejected. Once released, the button will reset and lock the plug.

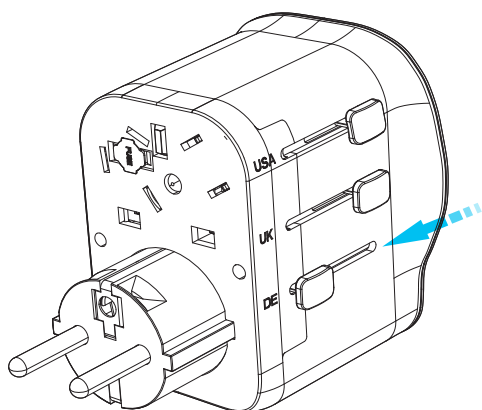

Using the DE Plug:

Slightly press the button and slide it down to fully insert the DE plug, as shown. Press and hold the "DE" button to release the plug. Continue pulling it up until the plug is fully ejected. Once released, the button will reset and lock the plug.

Replacement of the Fuse

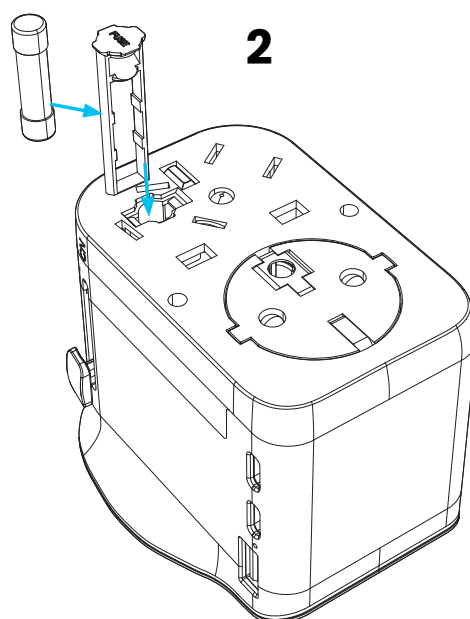
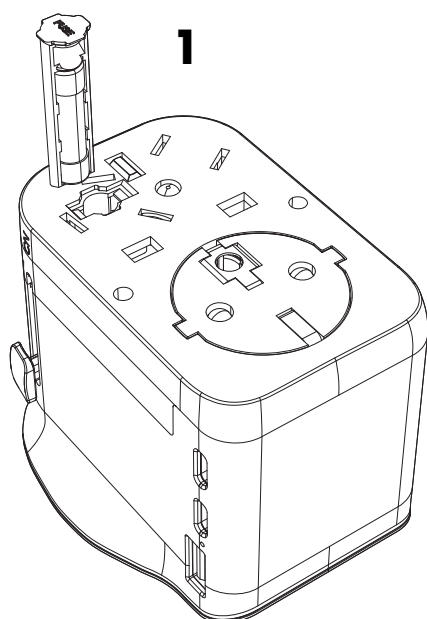

1. Tap the fuse box marked "fuse" with a hard object to release the fuse, then remove it as shown in Figure 1.
2. Insert a new fuse into the fuse box and then place the fuse box back into the product, as shown in Figure 2.
3. Fuse Specification: BS240 ,1362Vac, Max 10A, 6.3 x 25.4mm

Caution

1. Always disconnect the adapter from the outlet when not in use.
2. Before use, please read these instructions carefully! This product does not convert voltage (AC-AC). To avoid possible damage to your device or other safety hazards, ensure the power outlet you intend to use has the proper voltage before using this adapter.
3. For indoor use only.
4. Misuse can lead to electrical shock.
5. The length of the USB cable should not exceed 3 meters.
6. This travel adapter is for temporary use only and should not be used permanently.
7. Do not insert an adapter into another adapter unless specified by the manufacturer.

Disposal



This product must not be disposed of as unsorted household waste. It is important to separate such waste for proper treatment and recycling, in compliance with local waste management regulations.

FCC Statement

For a Class B digital device or peripheral:

The instructions provided to the user should include the following or a similar statement, placed prominently in the manual:

Note: This equipment has been tested and found to comply with the limits for a Class B digital device, pursuant to part 15 of the FCC Rules. These limits are designed to provide reasonable protection against harmful interference in a residential installation. This equipment generates, uses, and can radiate radio frequency energy. If not installed and used according to the instructions, it may cause harmful interference to radio communications. However, there is no guarantee that interference will not occur in a particular installation. If this equipment does cause harmful interference to radio or television reception (which can be determined by turning the equipment on and off), the user is encouraged to try to correct the interference by one or more of the following measures:

Reorient or relocate the receiving antenna.

Increase the separation between the equipment and the receiver.

Connect the equipment to an outlet on a circuit different from that to which the receiver is connected.

Consult the dealer or an experienced radio/TV technician for help.



Warranty

Products that you buy directly from our **Powerology** website or shop come with a 24-month warranty.

The 24-month warranty applies to products purchased directly from our **Powerology** website or store. If **Powerology** products are bought from any of our verified retailers, then the product is eligible for only a 12-month warranty. To extend your product's warranty, visit our website **powerology.me/warranty** and fill in your details in the provided form along with an uploaded picture of the product to process your request. Once approved, you will receive a confirmation email of the extended product warranty. Upload the required information within 48 hours of purchase to be eligible for a 24-month warranty period.

For more info, please check:
powerology.me/warranty

Contact Us

If you have any questions about this Privacy Policy, please contact us at: **hey@powerology.me**

Website: **powerology.me**

Instagram: **powerology_official**

Facebook: **powerology.ME**