



Powerology

8800mAh Jump Start Air Compressor

SKU: PPBCHA47

Table of Contents

Product Overview	2
Specifications	2
Package Contents	3
Instructions for Use	4
Initiate Inflation	6
Jump Starting a Car	7
Charging	8
Over-Discharge Protection	9
Temperature Protection Feature	9
Precautions	10
Pressure Maintenance Mode	10
Troubleshooting	11
Notice	12
Disposal	13
Warranty	14
Contact Us	14

Product Overview

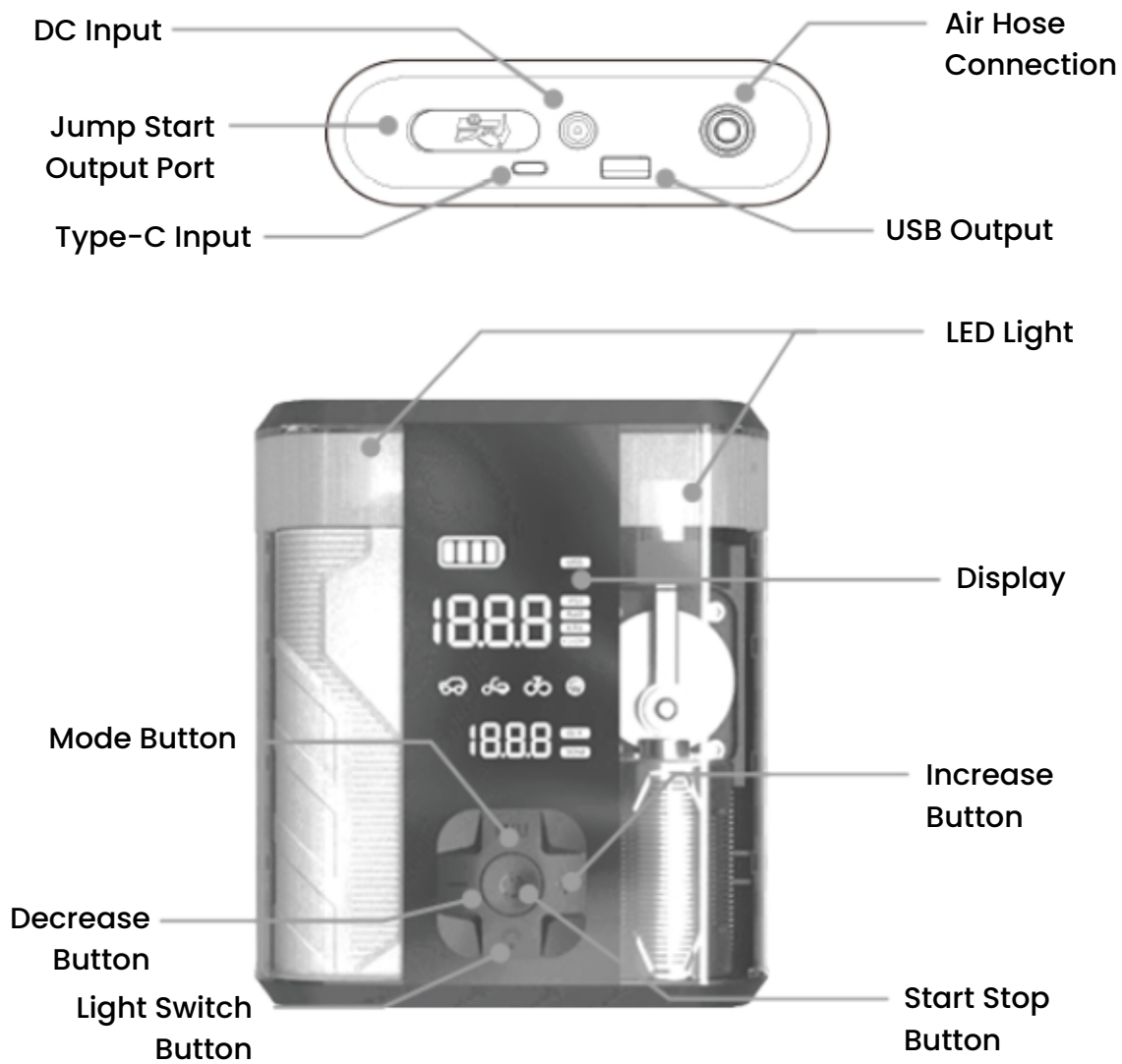

Specifications

Battery Capacity	8800mAh (2200mAh*4)
USB-C Input	5V/2A, 9V/2A, 12V/1.8A, PD 20W
USB-A Output	5V/2A, 9V/2A, 12V/1.8A, 21.6W
Recharge Time	2H
Inflation Pressure	4PSI (Minimum), 150PSI (Maximum)

Pressure Accuracy	±0.1 Bar
Inflation Speed	31.4L/Min
Jump Start Car Volume	5L Petrol, 3L Diesel
Start Current	500A
Peak Current	1000A
Working Temperature	-20 to 50°C
Product Weight	740g
Product Dimension	41×157×136mm

Package Contents



Storage Bag

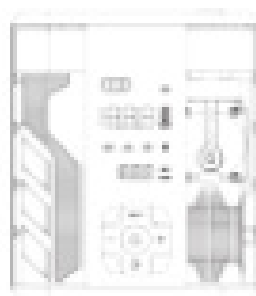

Jump Start Air
Compressor



Battery Clip

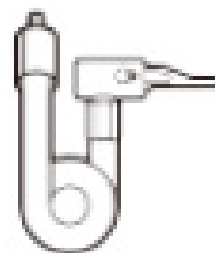

Air Hose



USB Cable



Cigarette Lighter

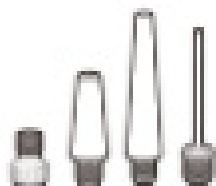

Nozzles 4

Instructions for Use

1. Power On/Off

1.1 Powering On/Off: Press the () button for 1 second to turn the inflator on or off.

1.2 Standby Mode: If no operation is detected within 5 seconds, the inflator will automatically enter standby mode.

2. Mode Selection: Press the M/U button to switch between the five available inflation modes.



Car

Default Pressure: 2.5 Bar

Adjustable Range: 0.28 to 6.0 Bar



Motorcycle

Default Pressure: 2.4 Bar

Adjustable Range: 1.8 to 3.0 Bar



Bicycle

Default Pressure: 2.06 Bar

Adjustable Range: 0.28 to 10.35 Bar



Ball

Default Pressure: 0.6 Bar

Adjustable Range: 0.28 to 1.1 Bar

Customized Mode Setting

Default Pressure: 8.27 Bar

Adjustable Range: 0.28 to 10.34 Bar

3. Adjusting the Preset Pressure:

3.1 Initial Adjustment: After selecting an inflation mode, use the (+) or (-) buttons to adjust the preset pressure value.

3.2 Rapid Adjustment: Press and hold the (+) or (-) button to quickly modify the pressure value.

Operating Instructions

4. Selecting the Pressure Unit

4.1 Adjusting Units: After choosing an inflation mode, press and hold the M/U button for 3 seconds to select your preferred unit of pressure (PSI, Bar, Kpa, kg/cm²).

4.2 Conversion Tip: 1 Bar = 14.5 PSI = 100 kPa = 1.02 kg/cm²

5. Lighting Modes

5.1 Turning On the Light: Press the () button once to turn on the light.

5.2 Activating SOS Mode: Press the () button a second time to enter SOS mode.



5.3 Turning Off the Light: Press the () button a third time to turn off the light.

6. USB Device Charging

Charging Process: Use the original USB cable that came with your device. Connect it to the USB-A output port to start charging your device.

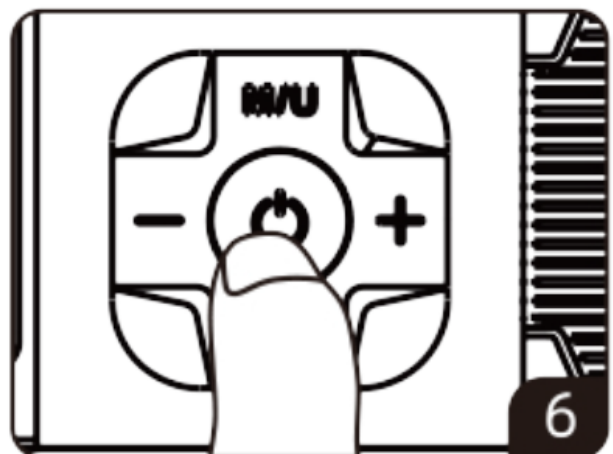
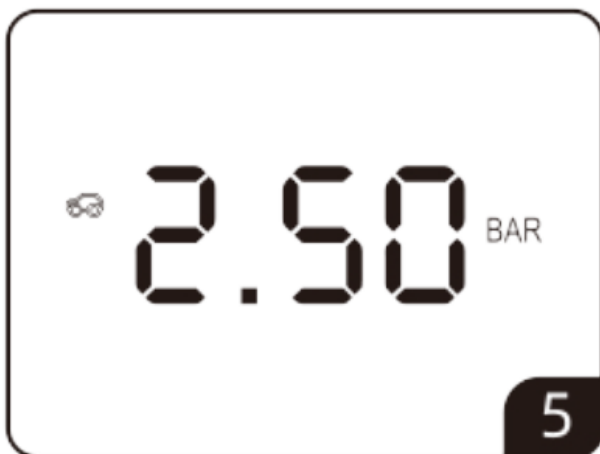
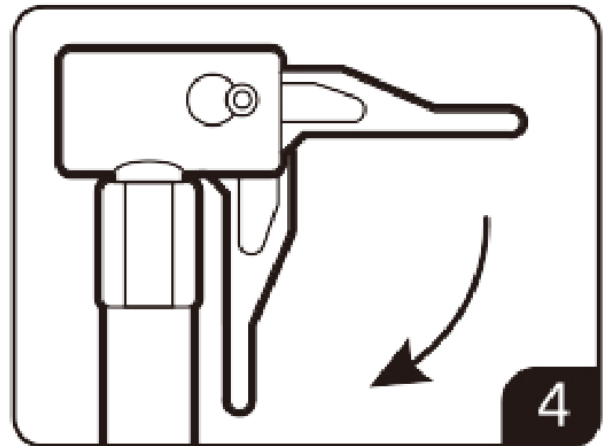
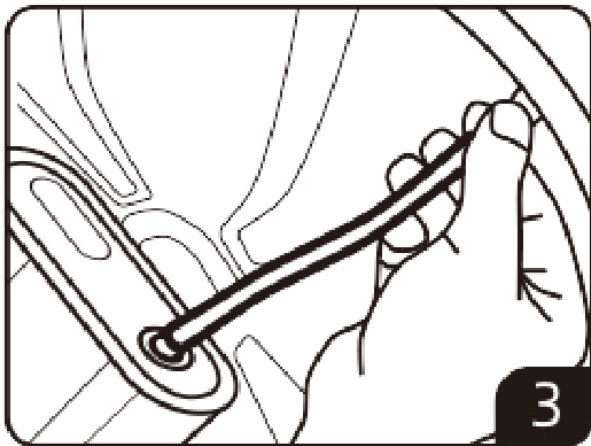
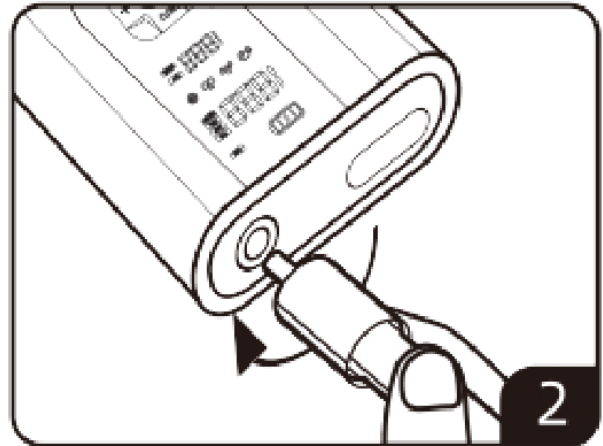
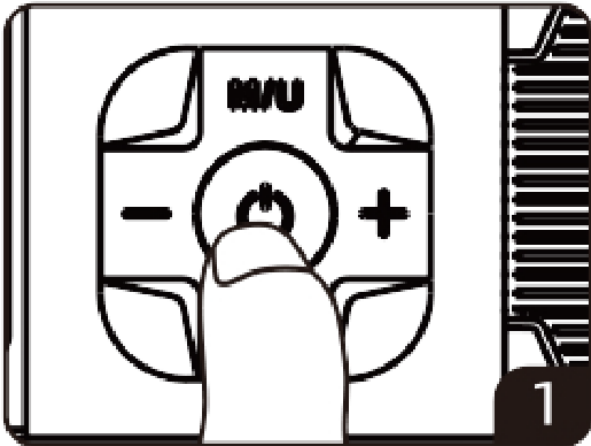
Initiate Inflation



1. Turn on the device by pressing a power button.
 2. Attach the air hose to the device's outlet.
 3. Connect the other end of the air hose to the valve stem of the tire.
 4. Press down on the air chuck to lock it onto the valve stem.
 5. Choose the desired mode, pressure value, and unit using the device's controls.
 6. Press the () button to start inflating.
- Tip:** The air compressor will automatically stop once the preset pressure value is reached. You can manually stop the inflation process by pressing the () button at any time.

Jump Starting a Car

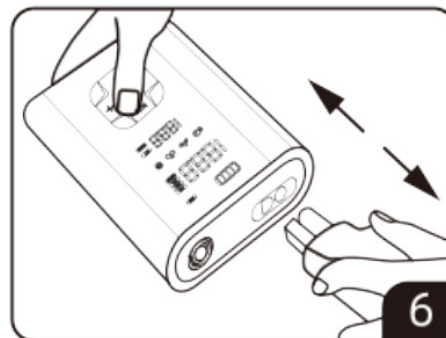
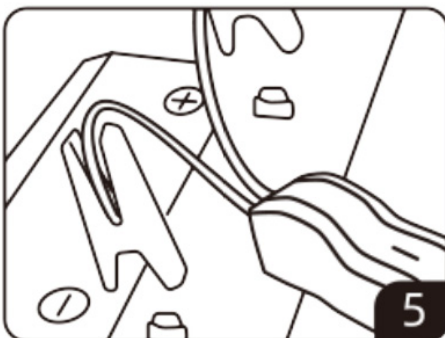
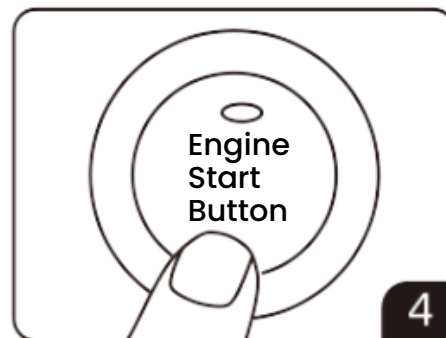
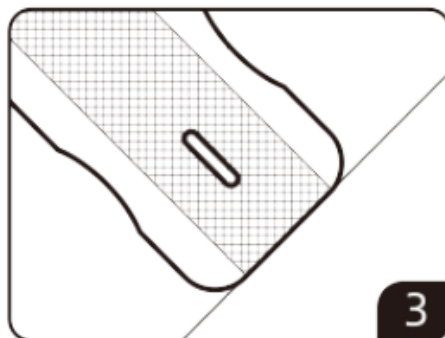
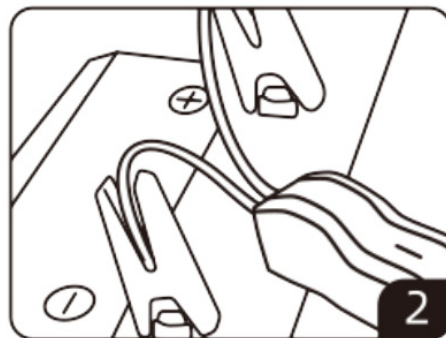
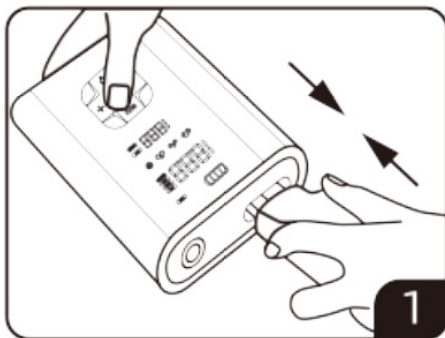

1. Plug the battery clip into the output port of the jump starter.
 2. Attach Clamps to Battery:
Red Clamp: Connect to the positive (+) terminal of the car battery.
Black Clamp: Connect to the negative (-) terminal of the car battery.
 3. Wait for the indicator on the battery clip to turn green, signaling readiness.
 4. Turn on the ignition to start the car.
 5. Disconnect the clamps from the car battery within 30 seconds after the car starts successfully.
 6. Remove the battery clip from the jump starter.
- Tip:** Before attempting to jump-start, check the battery icon on the display to ensure that the battery has at least %30 or higher charge remaining.

Charging

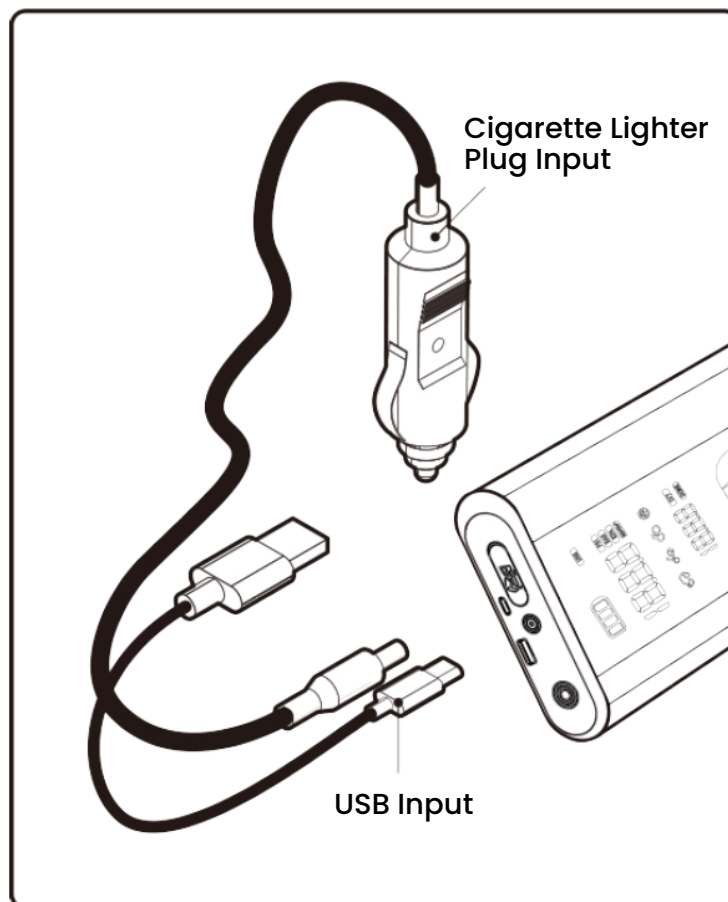

Choose one method to charge the product. The battery symbol will flash to indicate that charging is in progress.

Over-Discharge Protection

1. The system will automatically activate over-discharge protection when the over-discharge function is triggered in a low temperature environment.
2. The display will remain off until the charging cable is connected to reactivate the system.

Temperature Protection Feature

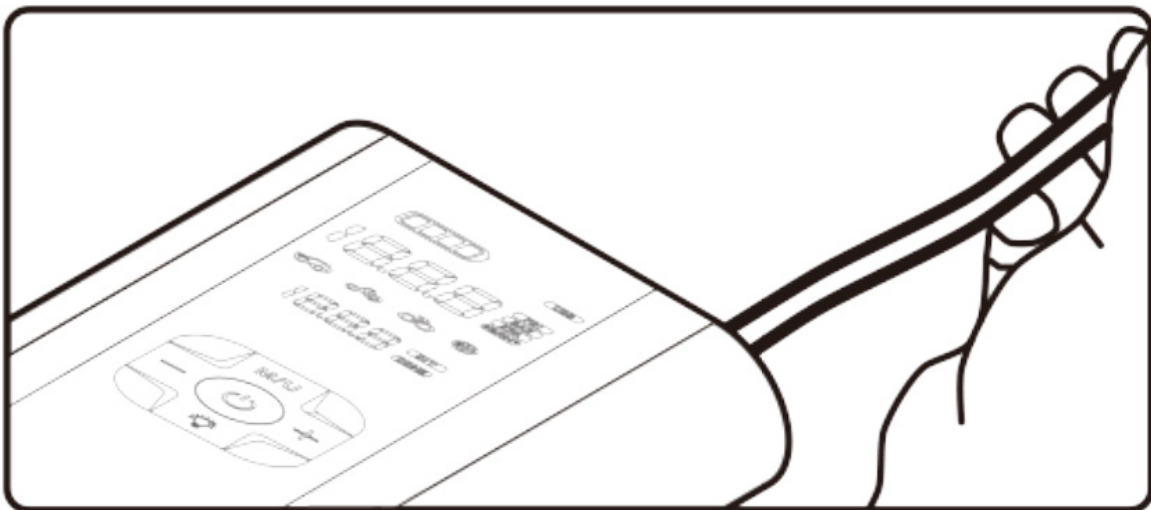



1. After extended operation, the inflator will automatically enter temperature protection mode and temporarily pause its function.
2. During this mode, the screen will display "HI" for 5 seconds and continue to provide reminders every minute.
3. The inflator will resume normal operation once the temperature has cooled down to a safe level.

Precautions

1. Avoid exposing the inflator to extreme heat or cold, as this can significantly shorten its service life.
2. Do not leave the charging cable connected for extended periods to prevent overcharging and help extend the battery's lifespan.
3. Keep away from children and pets.
4. Avoid exposure to water.

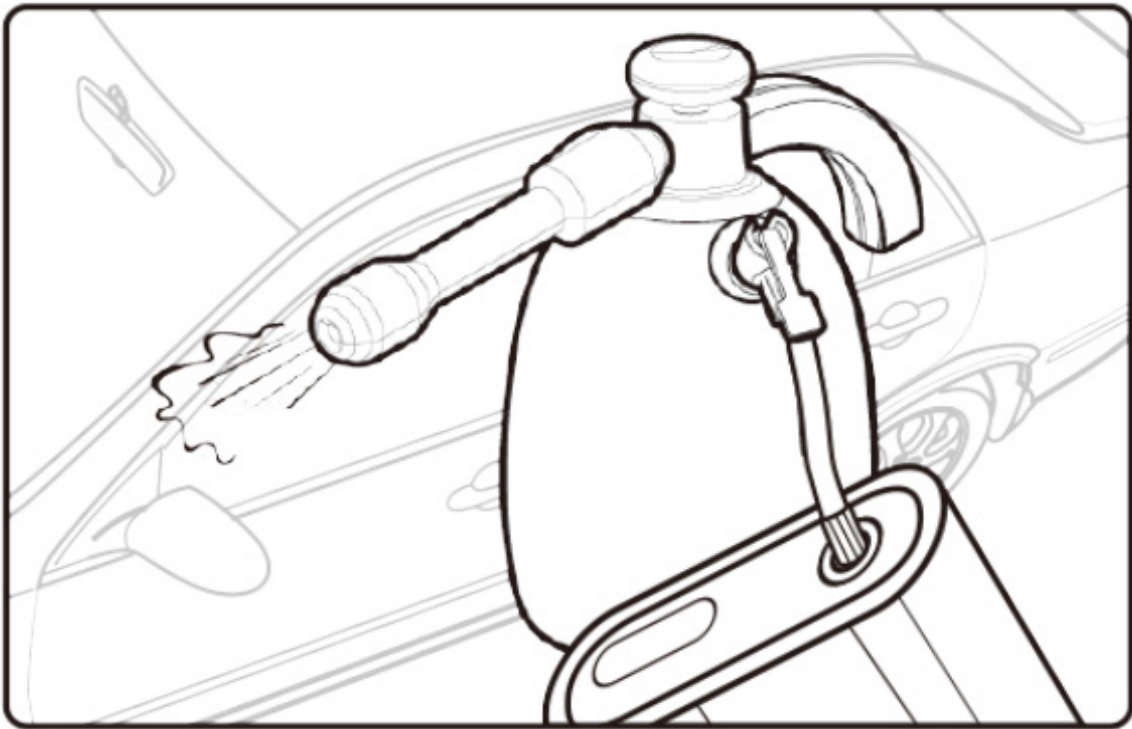
Pressure Maintenance Mode



1. While the unit is powered on, press and hold the () button for 5 seconds to initiate pressure maintenance mode.
2. Once activated, the unit icon will flash continuously, signaling that the pressure maintenance mode is turned on.

Problem	Possible Cause and Solution
Jump Starter Indicator Shows Red Light	<ol style="list-style-type: none"> 1. Ensure the "+" and "-" terminals are not reversed. 2. If the car does not start within 60 seconds of connection, re-plug to reactivate. 3. Confirm compatibility with your vehicle: up to 8.5L gas engines and 6L diesel engines. 4. If used to start a car more than 5 times continuously, re-plug to reactivate the device.
Does Not Inflate	<ol style="list-style-type: none"> 1. The air pump will enter over-current protection mode. It will be reactivated after charging. 2. If the air pump has insufficient power, please recharge it before use. 3. The air pump has activated temperature protection. Cool down for 15 to 20 minutes before using again. 4. Ensure the inflation tube is properly sealed with the tire valve. Check for any air leaks. 5. If used on truck tires requiring inflation higher than 87 PSI, note that this product is not suitable for such use.
Inaccurate Air Pressure Display	<ol style="list-style-type: none"> 1. Ensure the connection between the inflation pipe joint and the tire air nozzle is not too tight. Gradually loosen for testing if necessary. 2. Continuous operation of the air pump will cause the internal air to expand, increasing temperature and causing slight errors in air pressure measurement. Allow the device to cool down to return to normal operation.

Inflatable Tube is Too Hot to Unplug	<ol style="list-style-type: none"> 1. It is normal for the inflation tube to become hot after prolonged use. 2. To remove the tube safely, rotate the nylon part instead of the silicone part.
Power Consumption is Too Fast	<ol style="list-style-type: none"> 1. Due to our battery algorithm, the initial 50% of power consumption occurs quickly, whereas the remaining %50 will deplete more slowly. 2. This consumption pattern does not affect the number of inflation cycles.
Cannot Be Charged	<ol style="list-style-type: none"> 1. Ensure the charger output is more than PD 20W. If not, replace the charger. 2. Verify if there is a battery icon flashing when charging. If it does not flash, replace the data cable. 3. If the device still fails to charge, please contact a service center for assistance.
Cannot Inflate Balls Normally	<ol style="list-style-type: none"> 1. Verify the connection between the ball needle and the inflation tube is correct. 2. Ensure the end of the ball needle is flat with the inflation port and not pushed in.

Notice

1. This product is not a toy and should not be used by children. Keep children at a safe distance during inflation.
2. If the product is seldom used, it is recommended to charge it at least once every month.
3. Ensure to select the correct measurement unit to avoid over-inflation. Common units include: 1 PSI = 6.89 kPa, 1 PSI = 0.068 bar, 1 PSI = 0.07 kg/cm²

4. Use the product in a dry and clean environment. It is not water-proof and should not be rinsed with water.
5. If there is abnormal noise or the temperature is too high during operation, shut down the product immediately.
6. Inflating can cause the device to heat up due to the high-pressure operation. Be cautious when handling the air pipe and avoid touching the silicone part of the inflation tube when hot. Instead, handle the black nylon part.

Disposal

This symbol on the product or within the instructions indicates that your electrical and electronic equipment should be disposed of separately from household waste at the end of its life.

Notes for Battery Disposal:

The batteries used in this product contain chemicals that are harmful to the environment. To protect the environment, dispose of used batteries according to local laws or regulations. Batteries should not be discarded with regular household waste. For more information, please contact local authorities.



Warranty

Products that you buy directly from our **Powerology** website or shop come with a 24-month warranty.

The 24-month warranty applies to products purchased directly from our **Powerology** website or store. If **Powerology** products are bought from any of our verified retailers, then the product is eligible for only a 12-month warranty. To extend your product's warranty, visit our website **powerology.me/warranty** and fill in your details in the provided form along with an uploaded picture of the product to process your request. Once approved, you will receive a confirmation email of the extended product warranty. Upload the required information within 48 hours of purchase to be eligible for a 24-month warranty period.

For more info, please check:
powerology.me/warranty

Contact Us

If you have any questions about this Privacy Policy, please contact us at: **hey@powerology.me**
Website: **powerology.me**
Instagram: **powerology_official**
Facebook: **powerology.ME**