



Powerology

Turbo Jet Fan and Vacuum

SKU: PPBCHA78



Table of Contents

Schematic View	2
Instructions for Use	3
Indicator Light Guide	4
Charging	5
Specifications	5
Important Notice	6
Notes on Usage and Storage	6
Disclaimer	7
Disposal	8
Warranty	9
Contact Us	9

Schematic View

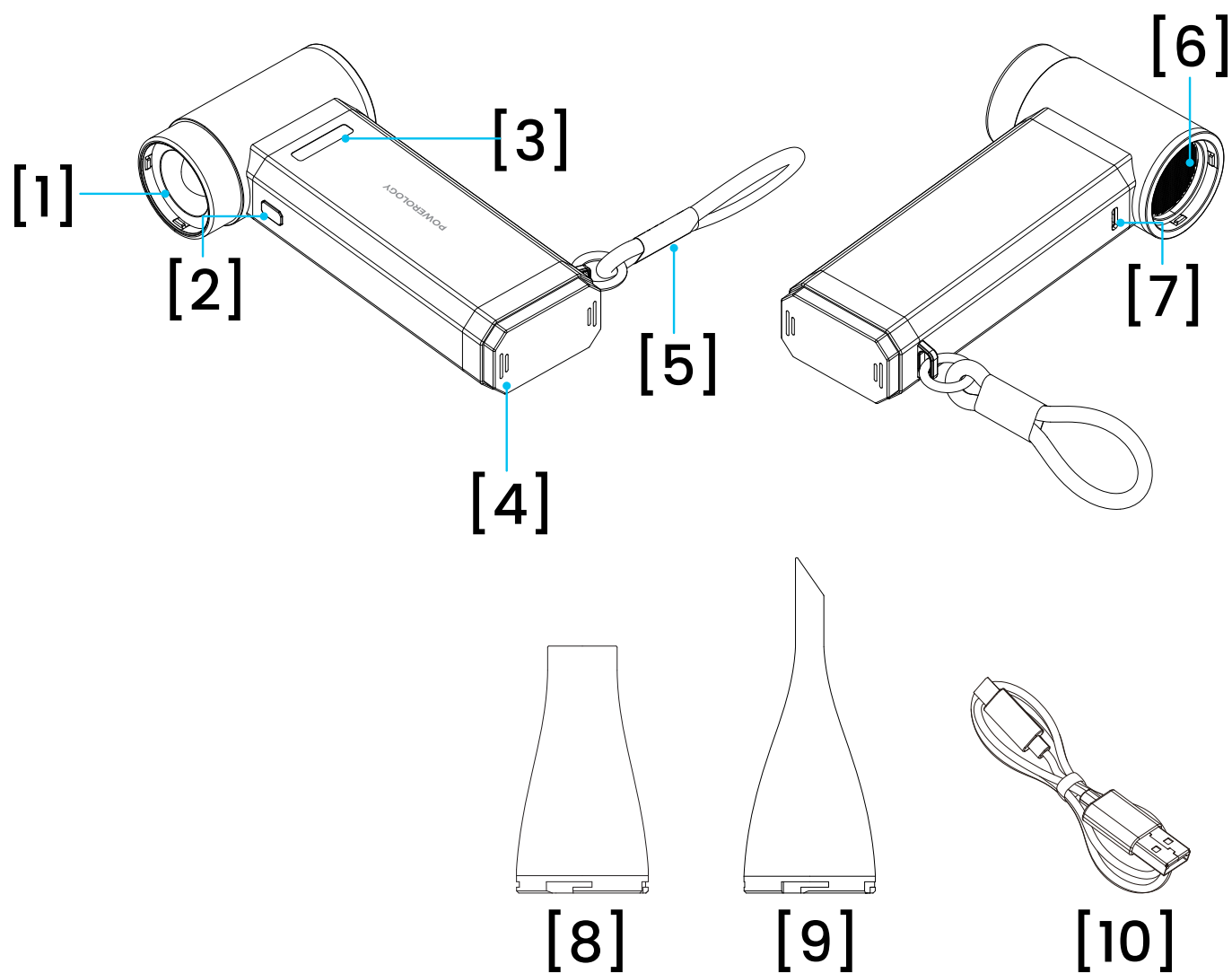

- 1.** Blower Outlet
- 2.** Multi-functional Button
- 3.** Multi-functional Indicator Light
- 4.** Heat Dispersion Vent
- 5.** Hanging Hook
- 6.** Air Inlet
- 7.** Charging Port
- 8.** Fan Head
- 9.** Air Outlet Head
- 10.** Type-C Charging Cable

Instructions for Use

1. Blowing Function

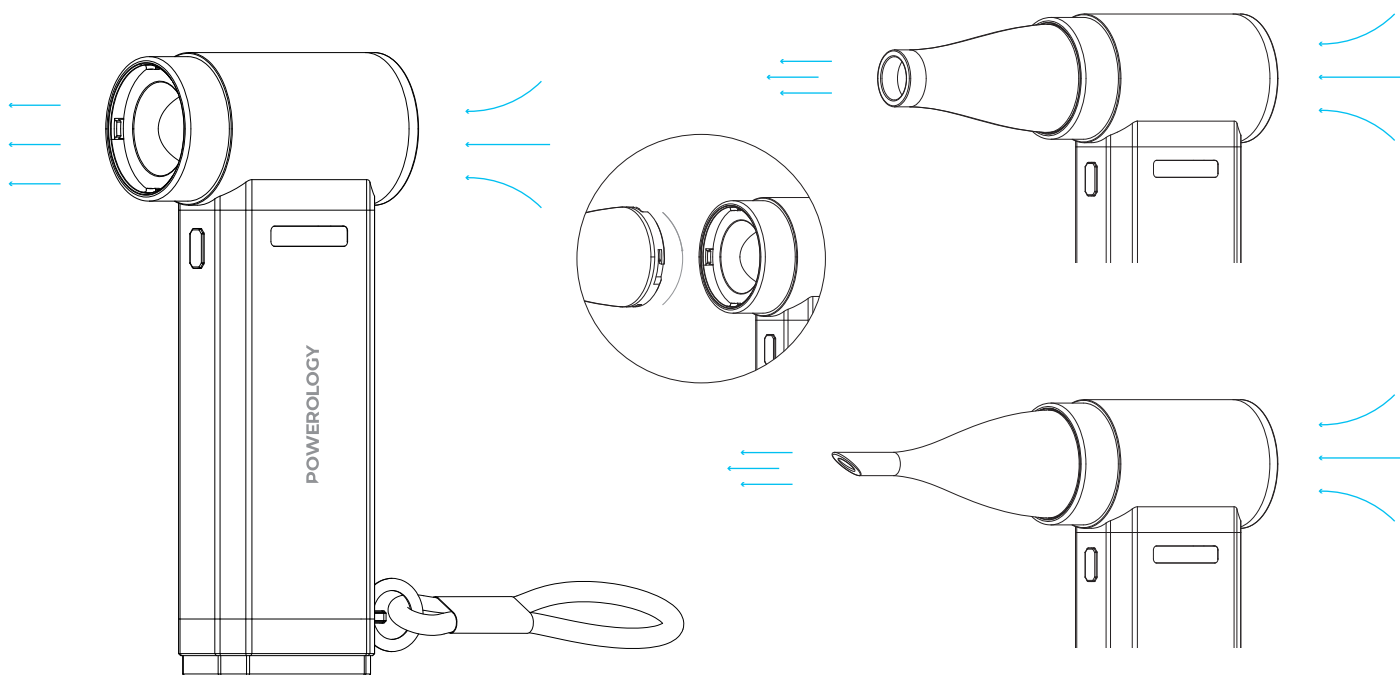

2. Operating Instructions

To turn on the device, press and hold the multi-function button. The device will display the battery level and enter standby mode.

2.1 Press the mode button briefly: 1st gear → 2nd gear → 3rd gear → Turbo mode → standby mode.

2.2 In Turbo mode, press the mode button again to activate it. At the same time, the device will increase power consumption.

2.3 Once the battery is depleted, Turbo mode will automatically stop, requiring recharging.

2.4 During the charging process, the device can be used again, and the mode can be adjusted as needed.

2.5 In the 1st, 2nd, 3rd gears, or standby mode, press and hold the multi-function button for 1.2 seconds to turn off the device.

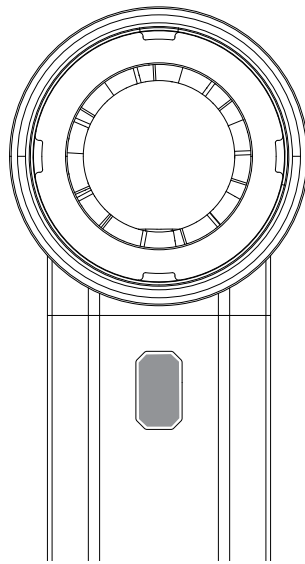

Indicator Light Guide

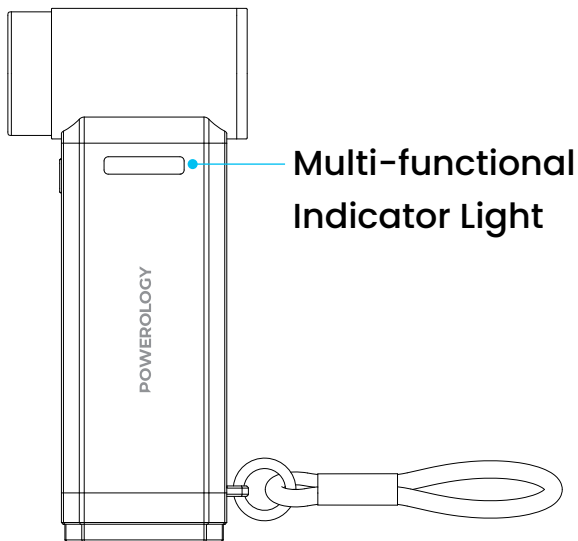

Multi-functional Indicator Light		Device Status
Two blue indicator lights: Indicates normal brightness.		First operating level
Four blue indicator lights: Indicates normal brightness.		Second operating level
Six blue indicator lights: Indicates normal brightness.		Third operating level
Six blue-green indicator lights: Indicates normal brightness.		Turbo mode
Battery Level Indication		Battery Status
Six green indicator lights: Full battery		80% to 100%
Five green indicator lights: High battery		60% to 80%
Four yellow indicator lights: Medium battery		40% to 60%
Three yellow indicator lights: Low battery		20% to 40%
Two red indicator lights: Very low battery		15% to 20%
One red indicator light flashing: Critical battery level		0% to 5%

Charging

- 1. Before the first use, make sure the battery is fully charged to prevent any impact on battery performance.
 - 2. Ensure the device is powered off during charging.
- Note:** This product can not operate while charging.
- 3. While charging, the indicator lights will flash sequentially. Once fully charged, all six indicator lights will remain turned on.

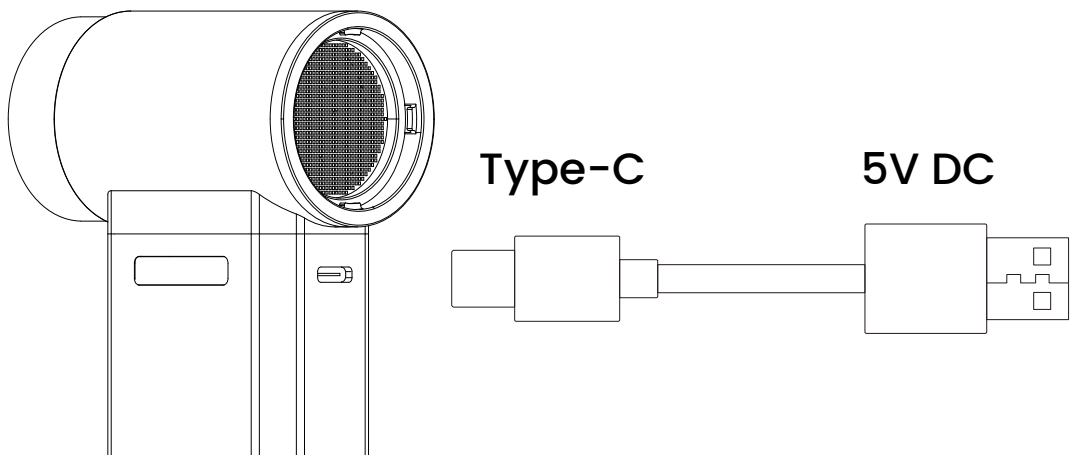

Specifications

Battery Capacity	4000mAh
Input Voltage	5V
Working Time	5h (gear 1), 72Min (gear 2) 30Min (gear 3), 12Min (Turbo)
Charging Port	Type-C
Motor Speed	130000RPM
Weight	395g
Working Temperature	0°C to 40°C
Product Size	37.5 x 69 x 153mm

Important Notice

Before using the product, please carefully read the instruction manual to ensure proper use and maintenance. To minimize the risk of fire, property damage, or personal injury, please adhere to the following safety precautions:

- 1.** Avoid using the product in wet environments.
- 2.** Do not place the product in a freezer or expose it to high humidity.
- 3.** Do not insert any foreign objects into the product's working areas, such as the air intake or fan outlet.
- 4.** Avoid directing the airflow towards the product's air inlet.
- 5.** Do not place the product near heat sources (e.g., stoves or heating appliances) or in hot vehicles.
- 6.** Keep the product away from flammable substances (e.g., aerosol sprays, paints, etc.) as they may lead to fire or explosion.
- 7.** Avoid dropping or striking the product, as this could cause damage. If malfunction occurs, please contact after-sales service.
- 8.** Use only the designated charging cable and refrain from pulling, bending, or altering it. If the charging cable overheats or shows signs of damage, stop using it immediately and replace it.
- 9.** If the product emits unusual sounds, smells, or high temperatures, or if the fan operates abnormally, cease use immediately.
- 10.** In case of malfunction due to improper handling, please contact a service center immediately.

Notes on Usage and

- 1.** This product emits cool air. When in use, keep the head at a distance from the air outlet to avoid direct airflow into the outlet.

- 2.** Avoid directing the airflow towards your eyes, ears, or any other body parts.
- 3.** Always turn off the product when not in use.
- 4.** Keep the product out of reach of children and pets during storage.
- 5.** Store the product in a dry environment, avoiding exposure to moisture-prone areas such as bathrooms, kitchens, or places near water sources.
- 6.** Use the product within the recommended temperature range, and avoid exposure to extreme environmental conditions.
- 7.** Place the product on a stable, flat surface and avoid direct exposure to sunlight.
- 8.** This product is not waterproof. Do not use alcohol, detergent, or other harsh cleaning agents. Use a damp cloth for cleaning instead.
- 9.** Regularly clean the air intake and exhaust vents to ensure smooth airflow.
- 10.** Clean the air inlet and outlet using your finger or a soft brush.
- 11.** Disconnect the power supply when not in use to avoid damaging the battery.
- 12.** The battery in this product is recyclable. Please ensure it is disposed of at an authorized recycling center. Safely remove the battery from the product before disposal.
- 13.** Use the appropriate tools to remove the product's cover.
- 14.** Safely remove the battery from the product.
- 15.** Dispose of the battery at a designated recycling facility.

Disclaimer

Thank you for choosing this product. Please ensure that you read the instructions carefully and follow the guidelines for correct installation and use of the product. Failure to follow the provided

instructions and safety precautions may result in personal injury, damage to the product, or surrounding items. The product must not be used for any unlawful purposes. The user assumes full responsibility for the purchase and use of this product. Our company does not accept liability for any risks or damages associated with its use, including direct or indirect losses caused by improper use by the user or third parties.

Disposal

This product must not be disposed of as unsorted household waste. It is important to separate such waste for proper treatment and recycling, in compliance with local waste management regulations.



Warranty

Products that you buy directly from our **Powerology** website or shop come with a 24-month warranty.

The 24-month warranty applies to products purchased directly from our **Powerology** website or store. If **Powerology** products are bought from any of our verified retailers, then the product is eligible for only a 12-month warranty. To extend your product's warranty, visit our website **powerology.me/warranty** and fill in your details in the provided form along with an uploaded picture of the product to process your request. Once approved, you will receive a confirmation email of the extended product warranty. Upload the required information within 48 hours of purchase to be eligible for a 24-month warranty period.

For more info, please check:
powerology.me/warranty

Contact Us

If you have any questions about this Privacy Policy, please contact us at: **hey@powerology.me**

Website: **powerology.me**

Instagram: **powerology_official**

Facebook: **powerology.ME**