



**Powerology** Universal Adapter 140W X2  
Type C port and X2 USB A 15W port

**SKU: P140WPD**

# Table of Contents

Schematic View -----	2
Specifications -----	3
Compatible Outlets -----	4
2-Pole Unearthed Devices -----	4
USB Devices -----	5
Instruction for Use -----	5
1. Using USA plugs -----	6
2. Using AUS plug -----	6
3. Using UK plug -----	6
4. Using EU plug -----	7
Replacing the Fuse -----	7
Caution -----	8
Environmental Notice -----	8
Global Electric Plug Guide -----	9
Warranty -----	13
Contact Us -----	13

Before installing and using the product, please carefully read this User Manual to guarantee correct usage and keep it secure for future reference.

## Schematic View

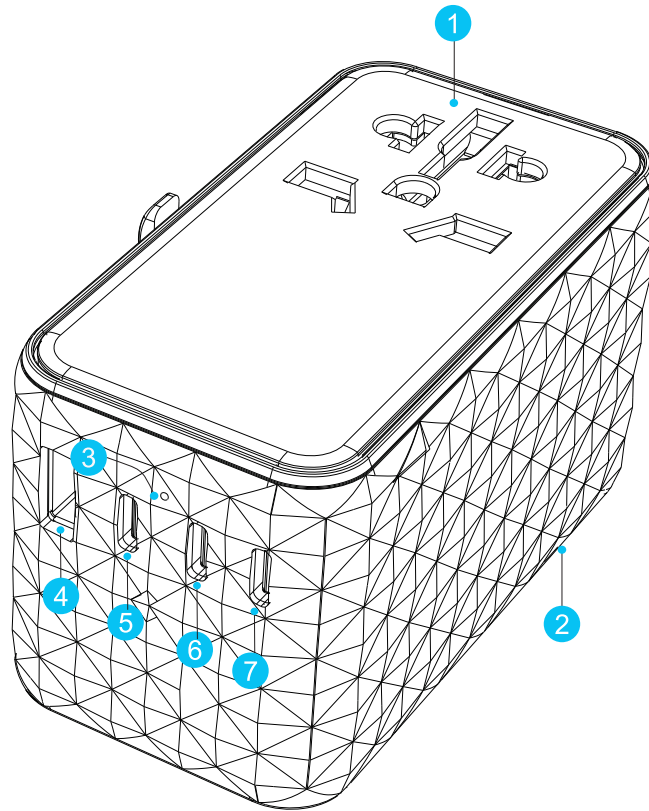

**1.** Multi-socket

**2.** US/AU/UK/EU plugs

**3.** LED indicator

**A. Solid light:**

The adapter operates normally.

**4.** USB-A1 port

**5.** USB-C3 port

**6.** USB-C2 port

**7.** USB-C1 port

**B. LED light is off:**

**B.1** Possible cause could be that the device is subjected to overload. To resolve this issue unplug one or more devices connected to the adapter and re-check the indicator light status.

**B.2** The reason could be that the electrical fuse is burned out. Check the fuse is working correctly.



# Specifications

Model	P140WPD
AC Input	100–250V AC, 10A (Max.), 2500W (Max.)
Single Port Output Mode	C1 :140W (Max.) C2 :140W (Max.) C3:180W (Max.) A1 :18W (Max.)
Combined Output Mode	C1+C2:100W+35W (Max.) C2+C3:100W+18W (Max.) C1+A1:100W+18W (Max.) C2+A1:100W+18W (Max.) C3+A1:15W (Max.) C1+C2+C3:65W+35W+8W (Max.) C1+C2+A1:65W+35W+18W (Max.) C1+C2+C3+A1:65W+35W+15W (C3+A1) (Max.)
Total DC Output	140W (Max.)
Support	PD 3.1, QC4+, FCP, AFC, PPS, BC1-2 and more
Size	92.7*55*53.37mm

# Compatible Outlets

**1** This Adapter can accept Type A, B, C, E, F, G, I, J, L, N plugs.

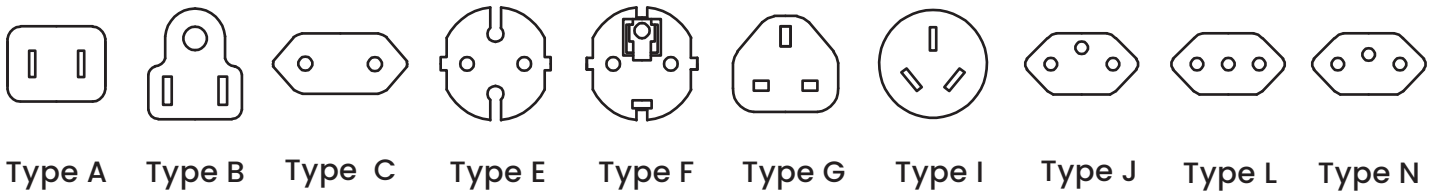

Please notice that Type D, H, K, M, and O plugs are NOT accepted.

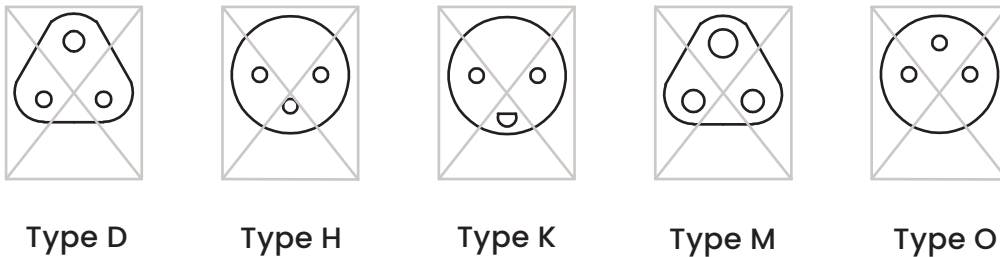

**2** The Adapter can be plugged into Type A, B, C, D, E, F, G, I, J, K, L, M, N, and O plugs.

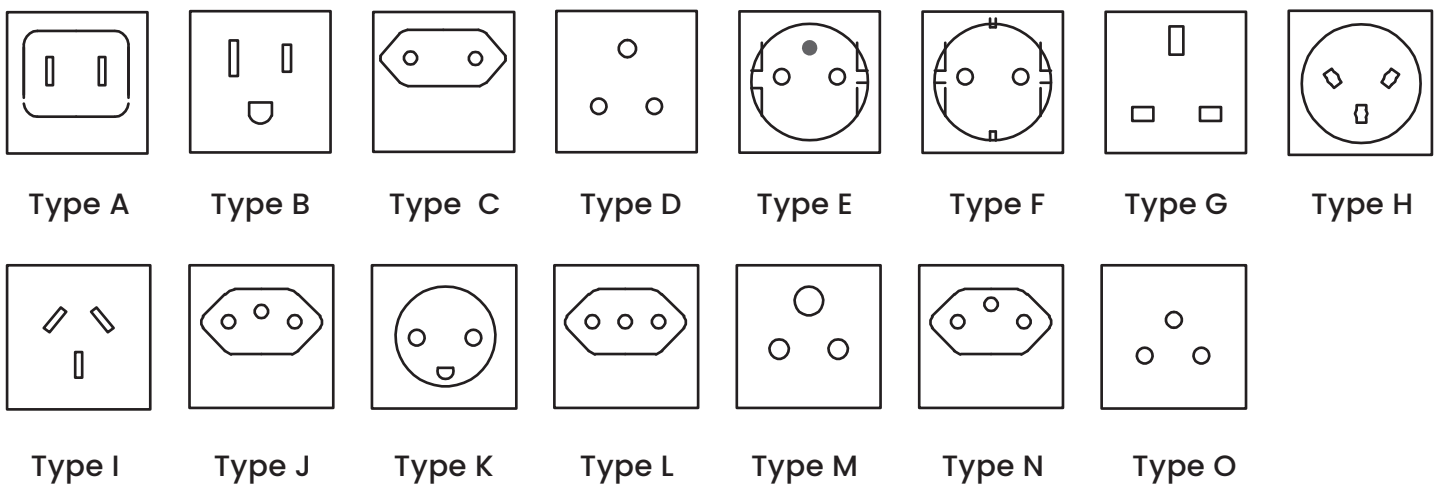

## 2-Pole Unearthed Devices

The product is suitable for use with most electronic devices up to 2500W at 250V and 1000W at 100V. It can be used with a multitude of appliances such as: Laptops, Small travel hair dryers, Travel irons, Electric fans, Table lamps, Electric razors, etc.

Please check the safety data sheet or data plate on the device to find this information before plugging it in.



Laptops



Small Travel  
Hair Dryer



Travel Iron



Electric Fan



Table Lamp



Electric Razors

## USB Devices

Camera, Smartphone, Tablet, Portable Game Console, Bluetooth Speaker, Power Bank, etc.



Camera



Smartphones



Tablets



Portable Game Console



Headsets

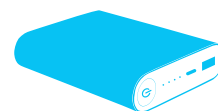

Power Banks

## Instructions for Use

### Features

1. Equipped with built-in multi-national plugs to fit a variety of outlets in different countries.
2. Incorporates a safety function switch that ensures only one plug is energized at a time.

### Attentions

1. Ensure that the button is reset after the plug is pushed out and retracted back into the bottom. If the button does not reset, it indicates that the plug has not been secured properly, which can impede normal operation.

**2.** Only one plug type can be used each time by sliding the knob selector; this mechanism automatically locks the unused plug-pins.

### 1. Using USA plugs

Gently press the button and slide it downwards to fully extend the USA plug. Ensure the contact blades are aligned in the parallel position.

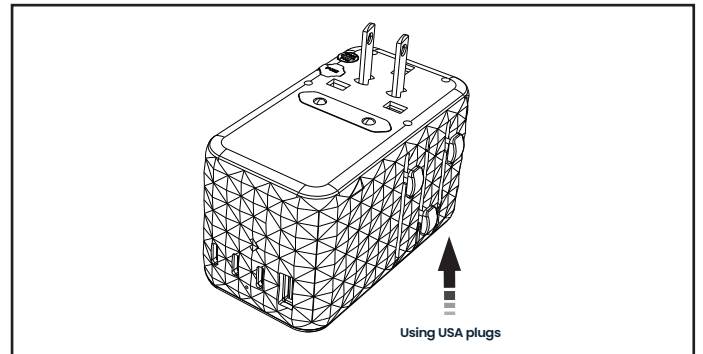

**To retract the plug:** press and hold the "USA" button to disengage it, then continue to pull upwards until the plug is fully retracted. Upon releasing the button, it will reset and secure the plug in place.

### 2. Using AUS plug

Gently press the button and slide it down. Ensure the contact blades are positioned parallel to each other.

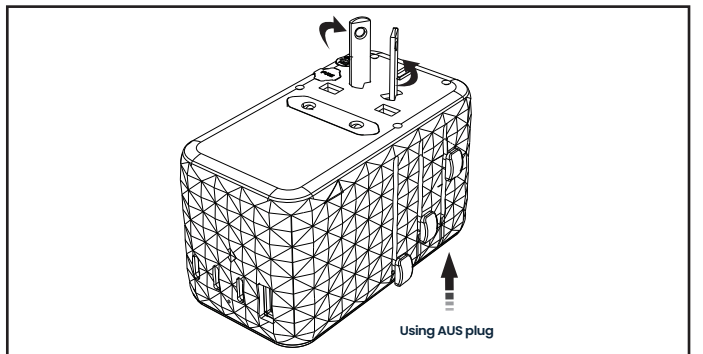

**To retract the plug:** firmly press and hold the "AUS" button to release it, then continue pulling upwards until the plug is fully retracted to the top. Upon releasing the button, it will automatically reset and secure the plug.

### 3. Using UK plug

Gently press the button and slide it downwards. Extract the insulated ground pin from its housing.

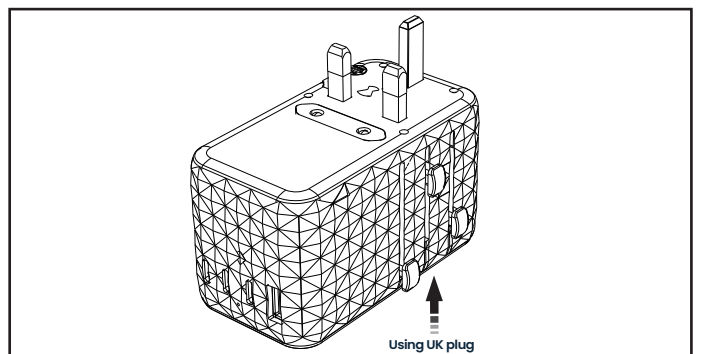

To retract the plug: press and hold the "UK" button to release it, then continue to pull upwards until the plug is completely retracted to the top. After releasing the button, it will reset and secure the plug.

#### 4. Using EU plug

Lightly press the button and slide down. Ensure that the contact blades are aligned in a parallel position.

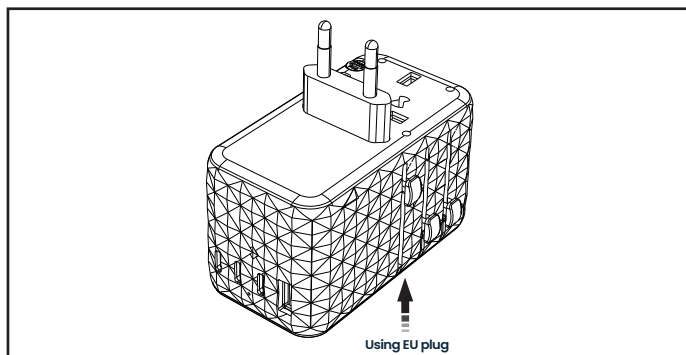

To retract the plug: hold down the "EU" button to release, then continue pulling upward until the plug is fully retracted. Once released, the button will automatically reset and secure the plug.

## Replacing the Fuse

1. Remove the first fuse ① .
2. Extract the second fuse ② , and place the ② in the original position of the first fuse ① to enable the adapter to function again.
3. If necessary, you may replace it with a new fuse that meets the following specifications: 250VAC 10A, size 6.3 \* 25.4 mm.

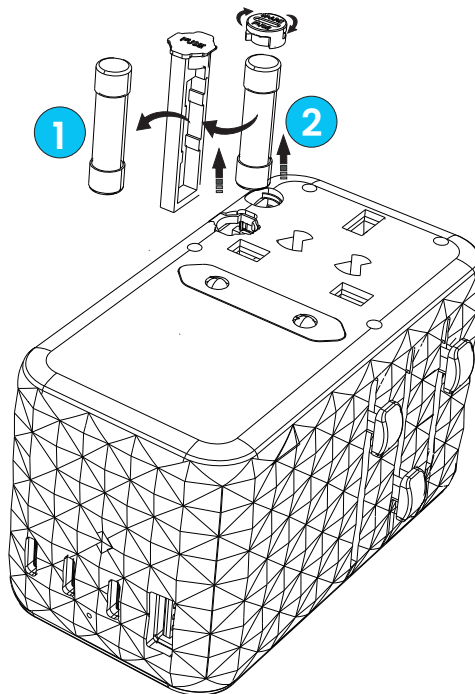

### Notes:

1. Ensure all devices are disconnected before replacing the fuse.



2. Check to see if any water has leaked from the connected equipment.
3. The device should not be wet or damp.

## Caution

1. Always unplug the Adapter from the outlet when it's not in use.
2. Please review these instructions thoroughly before use. This product does not convert voltage (AC-AC); to prevent potential damage to your device or other safety risks, ensure the power outlet has the correct voltage to operate your device before using this adapter.
3. For indoor use only.
4. Improper use may result in electrical shock.
5. The USB cable length should not exceed 3 meters.
6. This travel adapter is designed for temporary use and should not be utilized as a permanent power solution.
7. Do not insert an adapter into another adapter without approval from the manufacturer.
8. This product lacks grounding and should only be used with unearthed or double insulated appliances.

## Environmental Notice

1. Do not dispose of waste electrical products along with household waste.
2. Recycle these items at designated facilities where available.
3. Consult your local waste authority for recycling advice and regulations.





# Global Electric Plug Guide

## EU Plug

**A**

Albania  
Algeria  
Angola  
Argentina  
Austria  
Azores

**B**

Balearic Islands  
Bangladesh  
Belgium  
Bolivia  
Bosnia  
Brazil  
Bulgaria  
Burkina Faso  
Burundi

**C**

Cameroon  
Canary Islands  
Cape Verde  
Central African Republic  
Channel Islands  
Chile  
Comoros  
Congo  
Croatia  
Cote d'Ivoire  
Cyprus

**D**

Denmark  
Djibouti

**E**

Egypt  
El Salvador  
Equatorial Guinea  
Eritrea

**F**

Faeroe Island  
Finland  
France

**G**

Gabon  
Germany  
Gibraltar  
Greece  
Greenland  
Guadeloupe  
Guinea  
Guinea-Bissau

**H**

Hungary

**I**

Iceland  
India  
Indonesia  
Iran  
Iraq  
Israel  
Italy

**K**

Kazakhstan  
Korea  
Kuwait

**L** Laos  
Lebanon  
Lithuania  
Luxembourg

**M** Macedonia  
Madagascar  
Madeira  
Mali  
Mali  
Martinique  
Mauritania  
Mauritius  
Monaco  
Morocco  
Mozambique  
Myanmar

**N** Nepal  
Netherlands  
Niger  
Norway

**O** Oman

**P** Pakistan  
Paraguay  
Peru  
Philippines  
Poland  
Portugal

**R** Romania  
Russia  
Rwanda

**S** Senegal  
Somalia  
Spain  
Sudan  
Suriname  
Sweden  
Switzerland  
Syria

**T** Thailand  
Togo  
Tunisia  
Turkey

**U** Uruguay

**U** Vietnam

**Z** Zambia

### **AUS Plug**

**A** American Samoa  
Argentina  
Australia

**C** China

**E** El Salvador

**F** Fiji

**G** Guatemala

**K** Kiribati

**N** Nauru  
New Zealand

**P** Panama  
Papua New Guinea

**S** St. Vincent

**T** Tajikistan  
Tonga

**U** Uruguay

### USA Plug

**A** American Samoa  
Anguilla  
Antilles  
Aruba

**B** Bahamas  
Bangladesh  
Barbados  
Bermuda  
Bolivia  
Brazil

**C** Cambodia  
Canada  
Cayman Islands  
China  
Colombia  
Costa Rica  
Cuba

**E** Ecuador  
El Salvador

**G** Guam  
Guatemala  
Guyana

**H** Haiti  
Honduras

**J** Japan  
Jamaica

**L** Laos  
Lebanon  
Liberia

**M** Maldives  
Mexico  
Micronesia  
Montserrat

**N** Netherlands  
Nicaragua  
Niger

**O** Okinawa

**P** Panama  
Peru  
Philippines  
Puerto Rico

**S** St. Vincent  
Saudi Arabia

**T** Tahiti  
Taiwan  
Thailand

**U** United States

**V** Venezuela

Vietnam

Virgin Islands (US & British)

**Y** Yemen

## UK Plug

**B** Bahrain

Bangladesh

Belize

Botswana

Brunei

**C** Cameroon

Channel Islands

Cyprus

**D** Dominica

**E** El Salvador

**E** Gambia

Ghana

Gibraltar

Grenada

Guatemala

Guyana

**H** Hong Kong

**H** Iraq

Ireland

Isle of Man

**J** Jordan

**K** Kuwait

**L** Lebanon

**M** Macau

Malawi

Malaysia

Maldives

Malta

Mauritius

Myanmar

**N** Nigeria

**O** Oman

**Q** Qatar

**S** St. Lucia

St. Vincent

Saudi Arabia

Seychelles

Sierra Leone

Singapore

**T** Tanzania

**U** Uganda

United Arab Emirates

United Kingdom

**V** Vietnam

**Y** Yemen

## **Warranty**

Products that you buy directly from our **Powerology** website or shop come with a 24-month warranty. The 24-month warranty applies to products purchased directly from our **Powerology** website or store. If **Powerology** products are bought from any of our verified retailers, then the product is eligible for only a 12-month warranty. To extend your product's warranty, visit our website **powerology.me/warranty** and fill in your details in the provided form along with an uploaded picture of the product to process your request. Once approved, you will receive a confirmation email of the extended product warranty. Upload the required information within 48 hours of purchase to be eligible for a 24-month warranty period.

For more info, please check:

## **Contact Us**

If you have any questions about this Privacy Policy, please contact us at: **hey@powerology.me**

Website: **powerology.me**

Instagram: **powerology\_official**

Facebook: **powerology.ME**