



Powerology

Quad ENC

True-Wireless Buds

SKU: PWLAU005

Table of Contents

Features	2
Package Contents	2
Product Overview	3
Touch Controls	3
Wearing Earbuds	3
Power ON/OFF	4
Pairing	5
Single Mode	5
Connection Range	6
Reset	6
Touch Panel Instructions	7
A. Left Earbud	7
B. Right Earbud	8
Low Battery Alarm	9
Charge the Buds	9
Specifications	10
Safety Warnings	11
Warranty	12
Contact Us	12

Before installing and using the product, please carefully read this User Manual to guarantee correct usage and keep it secure for future reference.

Features

1. Quad Mic ENC (Four Mic ENC) equipped with Environmental Noise Cancellation.
2. Features a high-quality battery with a long lifespan.
3. Exclusive private mold product with a unique design.
4. Fast charging capabilities, allowing 10 minutes of charging provides about 1.5 hours of listening time.
5. Two modes available: music mode and gaming mode.

Package Contents

1. Charging Case
2. Earbuds
3. Type-C Charging Cable

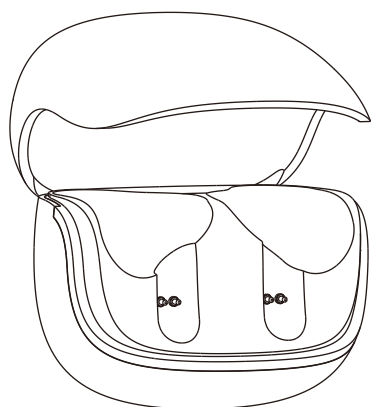

1

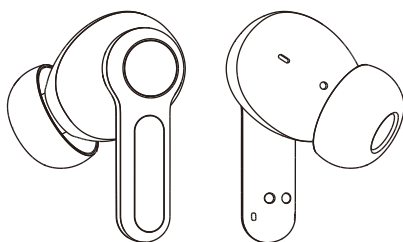

2

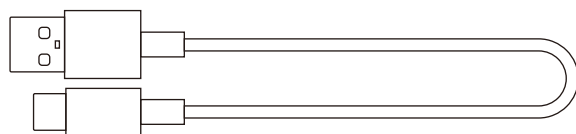

3

Product Overview

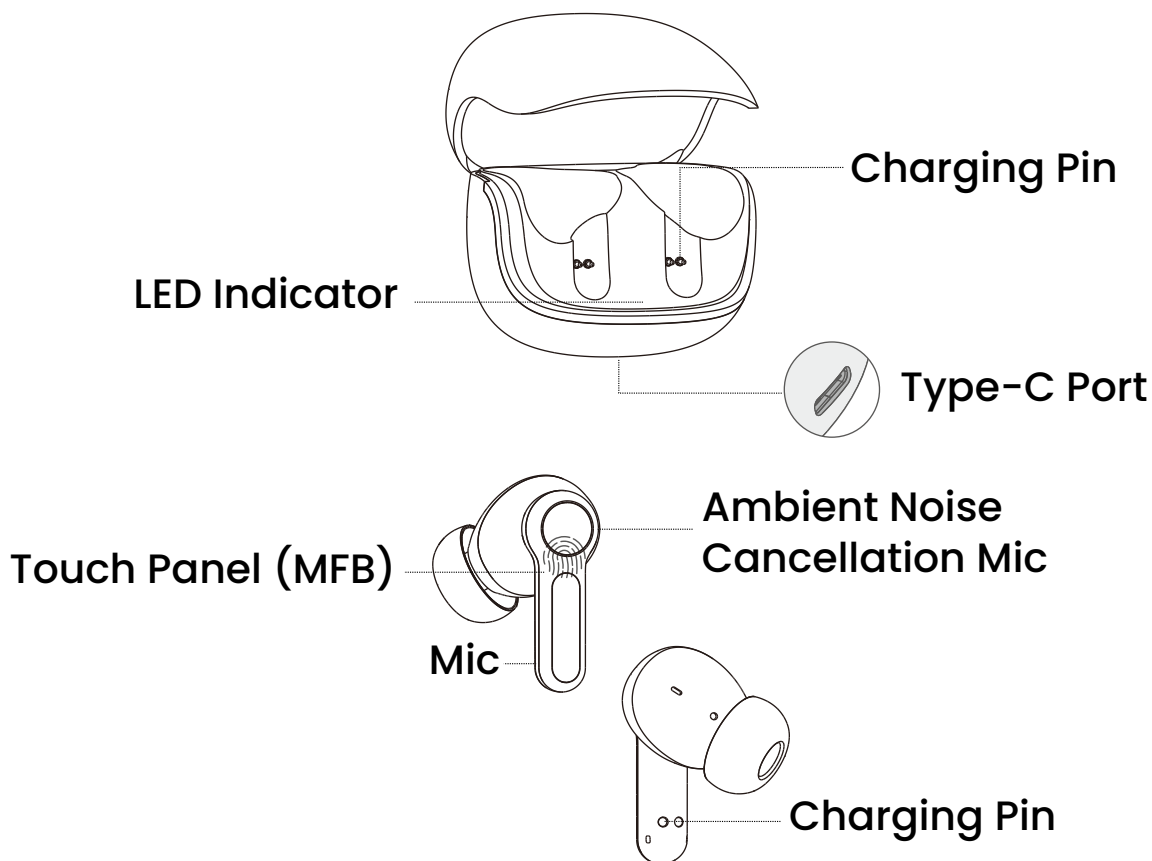

Touch Controls

The touch-sensitive area (MFB Touch Panel) is located on the upper portion of each earbud's handle.

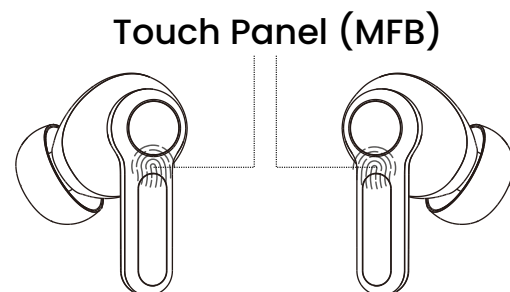

Wearing Earbuds

Ensure the left earbud, marked with an 'L', is worn in the left ear, and the right earbud, marked with an 'R', is worn in the right ear.

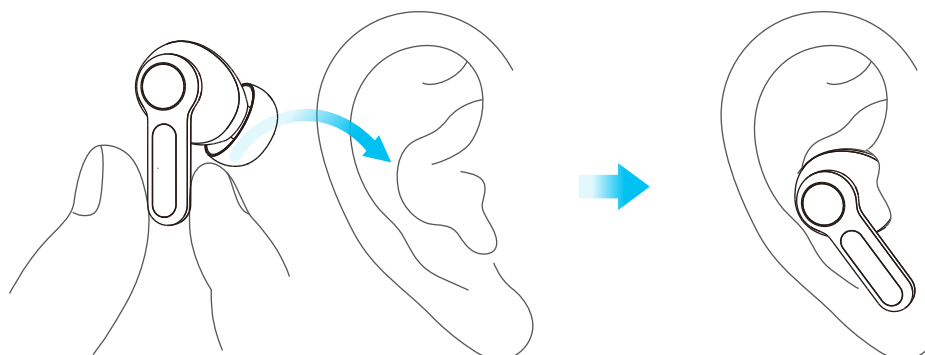

Power ON/OFF

A. Power On

Automatic: Open the charging case to power on.

Manual: Press and hold the MFB (Multi-Function Button) for 3 seconds.

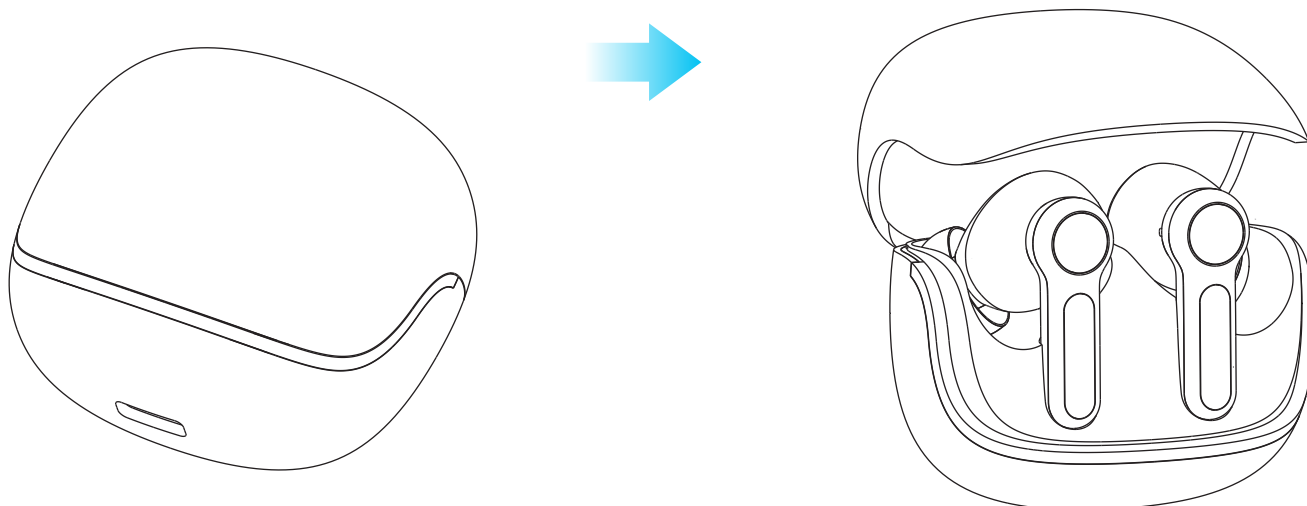

Open the cover to power on.

B. Power Off

Automatic: Place both earbuds in your charging case and close the lid.

Manual: Press and hold the MFB (Multi-Function Button) for 5 seconds.

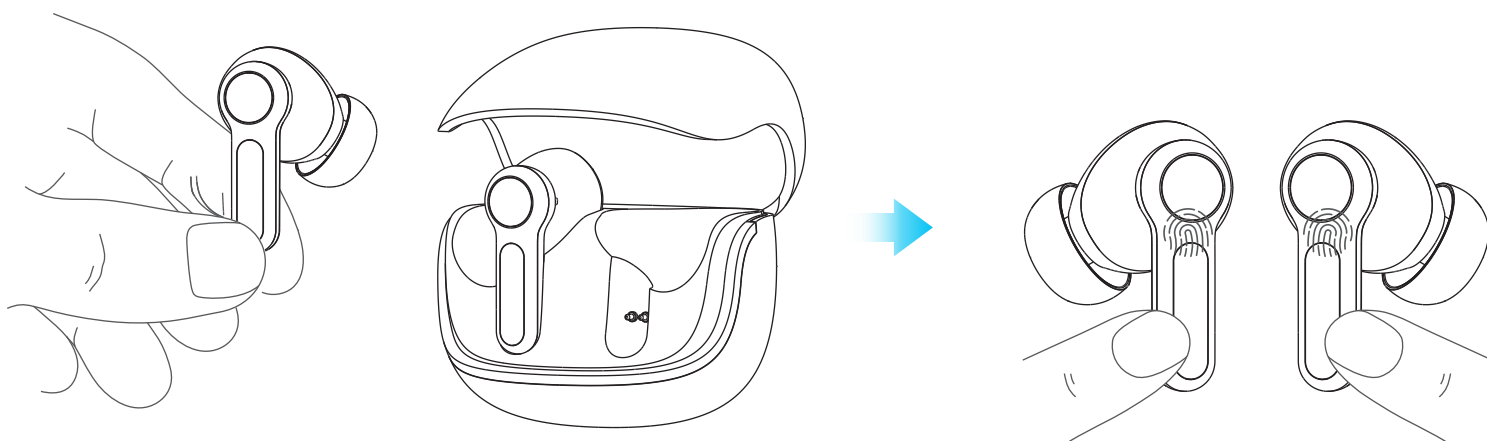

Put the earbuds back in the case to power off.

Touch the sensor to power off.

Pairing

1. Open the charging case and remove the earbuds. The earbuds will pair automatically. One of the earbuds will flash blue and red, while the light on the other earbud will turn off.
2. Activate Bluetooth on your device, search for the pairing name "PWLAU005" and select it to connect.

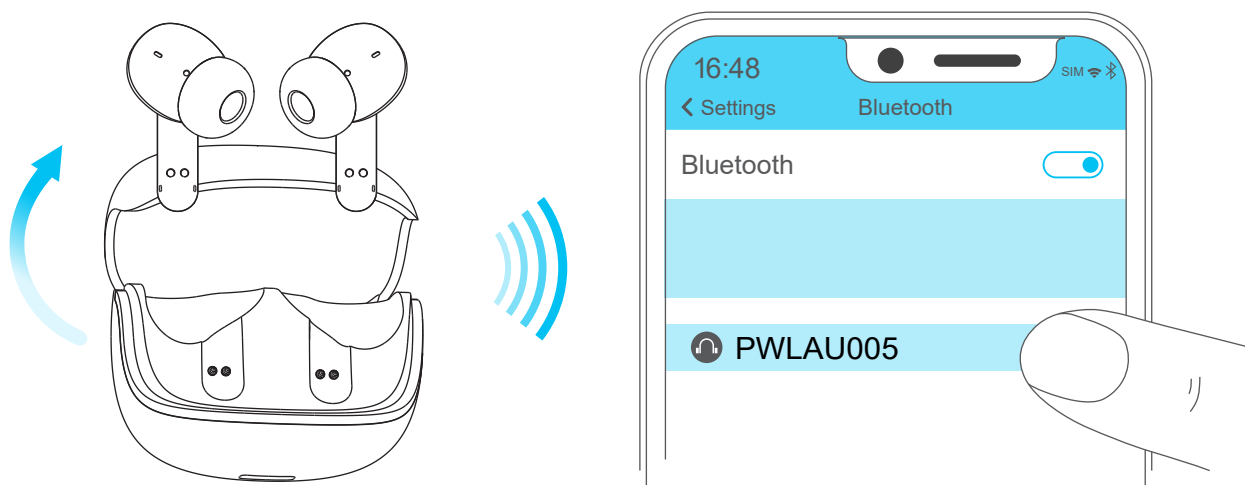

Tips: For subsequent uses, simply open the charging case, and the earbuds will automatically connect to your phone.

Single Mode

To use a single earbud while in dual mode, place one earbud back into the charging case. Then, remove only the earbud you wish to use from the charging case and connect it.

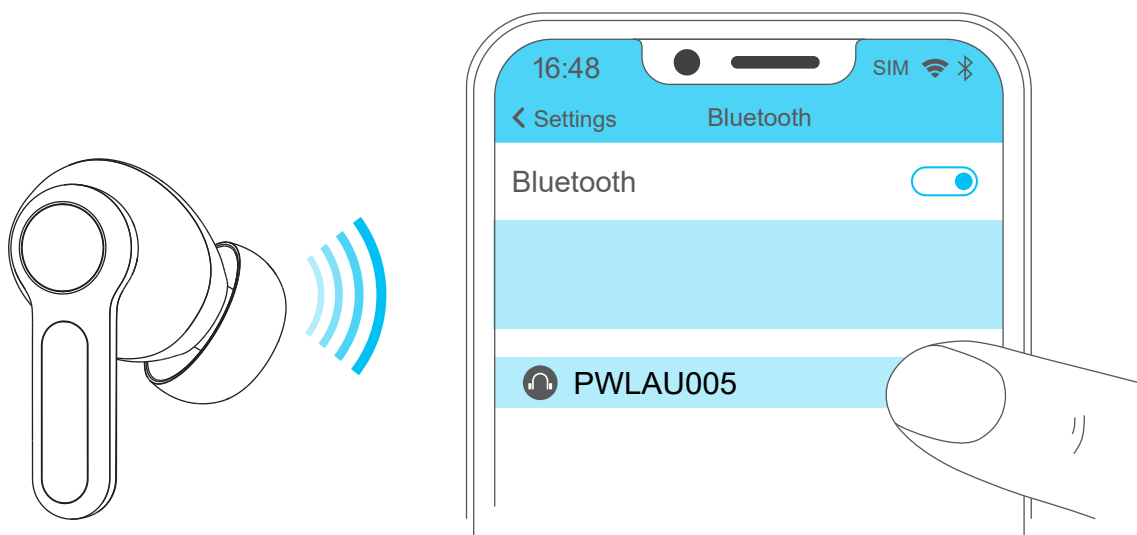

Connection Range

- 1. Re-pairing:** If you turn off your mobile phone's Bluetooth, the earbuds will enter pairing mode, allowing them to connect with other devices.
- 2. Connection Range:** Should the connection range be exceed the preset values, the earbuds will switch to reconnect mode. If no connection is established within 5 minutes, the earbuds will automatically turn off.

For optimal performance, keep your device within a 10-meter range of the earbuds to ensure a stable signal connection. If the distance exceeds 10 meters, the signal will be interrupted and connectivity may be lost.

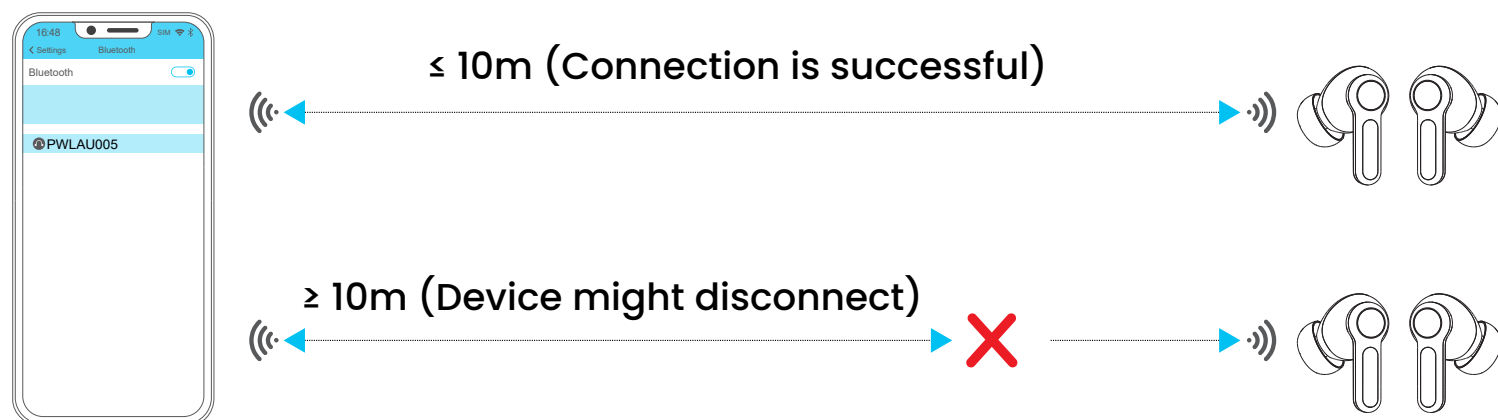

Reset

If only one of your earbuds is working or if they fail to pair, please reset the earphones by following these steps:

- 1.** Delete all "PWLAU005" Bluetooth records from your phone and turn off Bluetooth.
- 2.** Place the earbuds back into the charging case, then remove them to enter pairing mode.
- 3.** Simultaneously tap the Left and Right MFB 5 times and listen for

the "DU" prompt, which confirms that all pairings have been cleared.

4. Return the earbuds to the charging case.

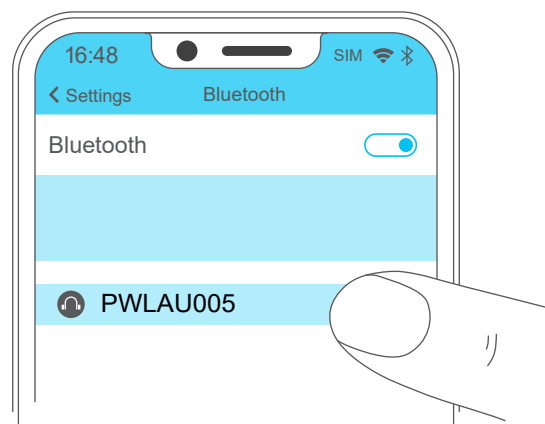

Remove the earbud's name from the list.

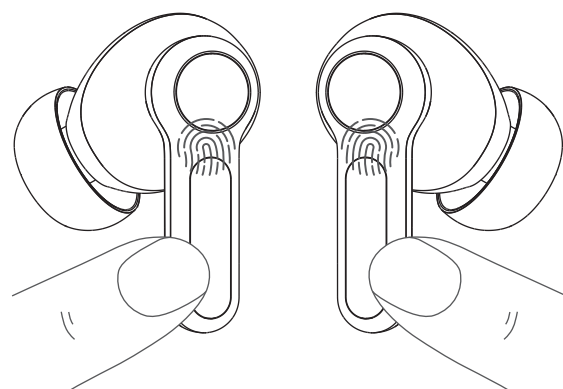

Tap Left and Right buds 5 times, simultaneously.

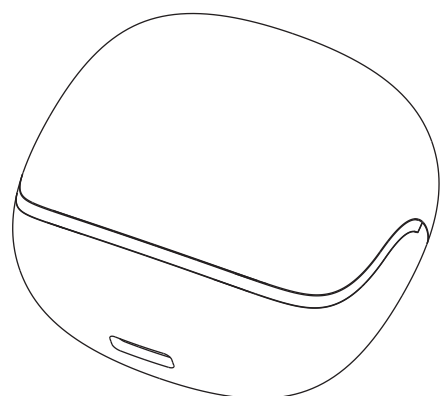



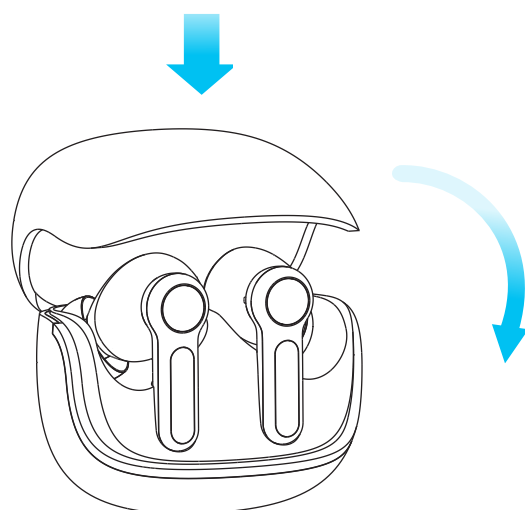

Put the earbuds back in the casing.



Touch Panel Instructions

A. Left Earbud



 **1× Play / Pause**
 Tap the touch sensor once

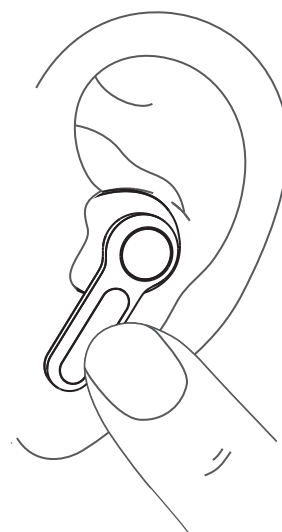

 **2× Previous Track**
 Double tap the left touch sensor



 **3× Volume Down**
 Tap the left touch sensor three times

 **4× Game mode**
 Tap the touch sensor four times

 **1.5sec Voice assistant**
 Press and hold the touch sensor for 1.5sec

 **1× Answer the call**
 Tap the touch sensor once

 **2× End Call/Reject call**
 Double tap the touch sensor

B. Right Earbud

 **1× Play / Pause**
 Tap the touch sensor once



 **2× Next Track**
 Double tap the left touch sensor

 **3× Volume Up**
 Tap the left touch sensor three times

 **4× Game mode**
 Tap the touch sensor four times

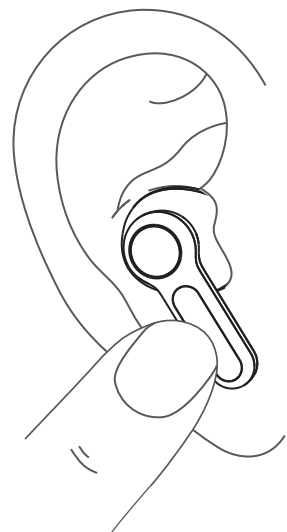
 **1.5sec Voice assistant**
 Press and hold the touch sensor for 1.5sec



 1× Answer the call
 Tap the touch sensor once

 2× End Call/Reject call
 Double tap the touch sensor

Low Battery Alarm

When the battery level is low, the earbuds will issue a voice reminder saying "Lower battery" every minute and the red light will flash twice repeatedly, until the battery is completely depleted and the earbuds turn off.

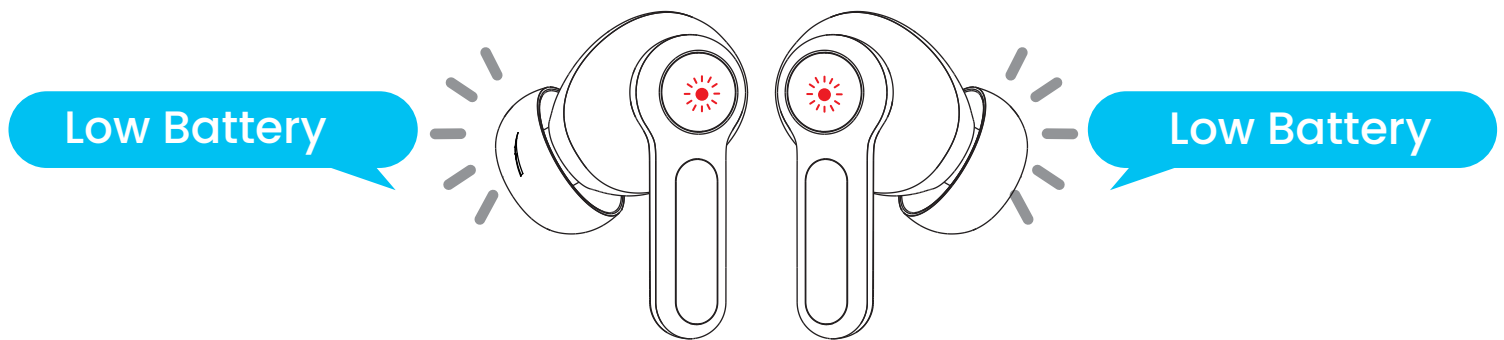

Charge the Buds

Place your earbuds in the charging case and close the lid; the earbuds will automatically charge.

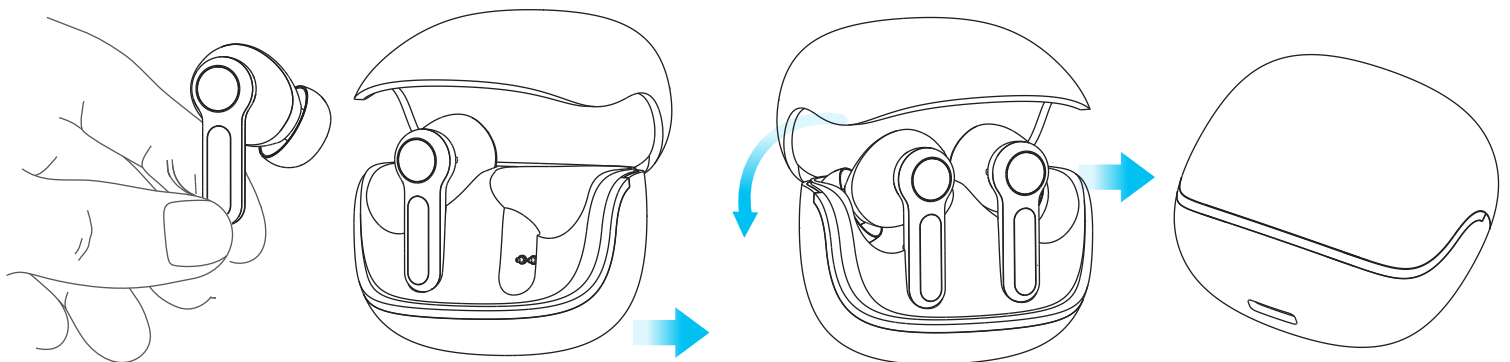

Specifications

Product Name	Powerology Quad ENC True-Wireless Buds
SKU	PWLAU005
Battery: Casing / Earbuds	3.7V/500mAh / 3.7V/40mAh
Bluetooth Version	V5.3
Bluetooth Name	PWLAU005
Bluetooth working frequency	2.402GHz-2.480GHz
Bluetooth range	10M
Speaker	Φ10mm 32Ω
Frequency Response	20Hz~20KHz
MIC	Silicon MIC-42dB+-2,
Charging Time: Casing / Earbuds	≈ 1.5H / ≈0.5H
Battery Life	≥500 times
Music Time	≈6H (100 % Volume)
Talk Time	≈5H (100 % Volume)
Charge Port	Type-C
Light	RGB
Headphone Distortion	< 3 %
Audio S/N	≥90dB
Supported Formats	SBC/MP3/AAC

Safety Warnings



Earbud Warnings

- 1.** Avoid placing the product in environments where the temperature is extremely high (above 45°C) or extremely low (below 0°C).
- 2.** Do not disassemble or repair the earbuds under any circumstances. If necessary, send the product to the seller for repair.
- 3.** Avoid throwing or dropping the earbuds to prevent damage.
- 4.** The earbuds and Bluetooth devices will be disconnected if the distance between them exceeds 10 meters.
- 5.** Keep the device and its accessories out of reach of children and pets.
- 6.** Do not put the earbuds into the washing machine.



Battery Warning

- 1.** Mishandling the battery in this product may lead to a fire disaster or a risk of chemical burns.
- 2.** Only use a charger with the appropriate voltage rating.
- 3.** Battery disposal must comply with local laws; if possible, recycle it. Do not dispose of it as household garbage to prevent the risk of an explosion.
- 4.** Users are not permitted to remove or replace the battery in the product unless explicitly directed by the user manual. Attempting to do so can be extremely hazardous and may cause damage to the product.

Warranty

Products that you buy directly from our **Powerology** website or shop come with a 24-month warranty.

The 24-month warranty applies to products purchased directly from our **Powerology** website or store. If **Powerology** products are bought from any of our verified retailers, then the product is eligible for only a 12-month warranty. To extend your product's warranty, visit our website **powerology.me/warranty** and fill in your details in the provided form along with an uploaded picture of the product to process your request. Once approved, you will receive a confirmation email of the extended product warranty. Upload the required information within 48 hours of purchase to be eligible for a 24-month warranty period.

For more info, please check:
powerology.me/warranty

Contact Us

If you have any questions about this Privacy Policy, please contact us at: **hey@powerology.me**

Website: **powerology.me**

Instagram: **[powerology_official](https://www.instagram.com/powerology_official)**

Facebook: **[powerology.ME](https://www.facebook.com/powerology.ME)**