



**Powerology**

**Cordless Stick Vacuum**

SKU: PPBCHA52

# Table of Contents

Features	2
Important Safety Instructions	2
A. Personal Safety Precautions	2
B. Electrical Safety Precautions	3
C. Battery Safety Precautions	4
Maintenance	4
Intended Use	5
Warning	5
Schematic View	6
Instructions for Use	7
A. Using with Extension Wand	7
B. Storage Guide	8
C. Using as Handheld Vacuum	9
Powering the Vacuum	9
Charging	10
Empty the Dust Cup	11
Filter Maintenance	11
Troubleshooting	12
Specifications	13
Warranty	14
Contact Us	14

## Features

1. The vacuum is equipped with a HEPA filter, designed to capture the smallest particles, ensuring the air expelled is significantly cleaner.
2. Features an electric brush with a motorized head that agitates and loosens dirt and debris.
3. This vacuum includes a dust bin with a 500ml capacity, allowing you to clean for longer periods.
4. Offers a substantial 45 minutes of continuous operation on a single charge.
5. Powered by a 400W Brushless DC motor, this vacuum provides a robust suction power along with increased efficiency and durability compared to traditional motors.
6. Delivers an impressive suction power of 27000Pa, enabling it to effectively remove dirt and debris from various surfaces quickly and efficiently.

## Important Safety Instructions

**WARNING:** Always follow basic safety precautions when using an electrical appliance to reduce the risk of fire, electrical shock, or injury.

### **A. Personal Safety Precautions**

1. Store the appliance indoors in a dry location, out of children's reach.
2. Use the appliance responsibly. It is suitable for children aged 10 years and older under supervision if they have limited physical, sensory, or mental capabilities, or lack experience and knowledge.
3. Do not allow children to play with the appliance; ensure it is used or maintained under adult supervision.

4. Use only the attachments recommended by the manufacturer as specified in this manual; using unauthorized accessories may lead to injuries.
5. Exercise caution when vacuuming stairs.
6. Keep the appliance and its accessories away from hot surfaces.
7. Ensure the air intake and exhaust are not blocked; keep all vents clear of debris such as dust, lint, and clothing.
8. Keep hair and loose clothing away from openings and moving parts to prevent entanglement.

## **B. Electrical Safety Precautions**

1. Use the charger cord carefully to prevent damage.
2. Do not carry the cord by its wire.
3. Always hold the plug itself when disconnecting the charger from a socket.
4. Avoid wrapping the cord around the charger when storing it to prevent damage.
5. Keep the charger cord away from hot surfaces and sharp objects.
6. If the supply cord is damaged, the charger must be discarded and replaced.
7. Never handle the charger or the appliance with wet hands.
8. Do not store or charge the appliance outdoors.
9. Always remove the charger from the socket before removing the battery, cleaning, or performing maintenance on the appliance.
10. Only use batteries and chargers provided by the manufacturer to ensure compatibility and safety.
11. Do not alter the charger in any way to prevent malfunction or hazards.
12. Ensure that the charger's voltage matches the voltage specified on the rating plate.
13. Using a charger intended for a different battery type may increase the risk of fire.

**14.** Inspect the charger cord regularly for damage or wear. A damaged cord could lead to fire or electric shock.

### **C. Battery Safety Precautions**

**1.** This appliance contains Li-ion batteries. Do not incinerate or expose batteries to high temperatures as they may explode.

**2.** Battery liquid can cause irritation or burns.

**3.** In emergencies, seek professional help immediately.

**4.** Battery leaks may occur under extreme conditions. Avoid contact with any leaked fluids.

**5.** If contacted with battery leaks, IMMEDIATELY wash the affected area with soap and water and seek medical attention.

**6.** If battery fluid enters the eyes, flush with clean water for at least 10 minutes and seek medical attention.

**7.** Use gloves when handling batteries and dispose of them in accordance with local regulations.

**8.** Short circuit in the battery terminals can cause burns or fires.

**9.** When not in use, store the battery pack away from items like paper clips, coins, keys, nails, or screws that could create a conductive bridge between terminals.

**10.** Dispose of the appliance and its battery in accordance with local regulations.

## **Maintenance**

**1.** Inspect the appliance for signs of wear or damage before use and after any impact. Repair the device if necessary.

**2.** Do not operate the appliance if any part is damaged or defective.

**3.** Repairs must be performed by a service agent or a qualified technician. Receiving services by unqualified individuals can be dangerous.

**4.** Never alter the appliance in any way as this may increase the risk of injury.

5. Use only accessories recommended or provided by the manufacturer.

## **Intended Use**

1. This appliance is exclusively designed for domestic dry vacuum cleaning.
2. Avoid picking up liquids or using on wet surfaces.
3. Refrain from vacuuming flammable, burning, or smoking materials.
4. Operate the appliance only as instructed in this manual.
5. Do not use on concrete, tarmac, or other rough surfaces.

## **Warning**

1. Do not use water, solvents, or polishes to clean the exterior of the appliance; instead, use a dry cloth.
2. Never submerge the unit in water nor clean it in a dishwasher.



# Schematic View

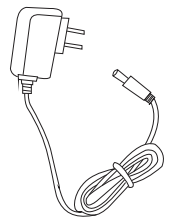
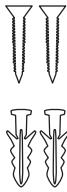
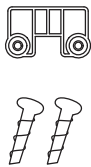
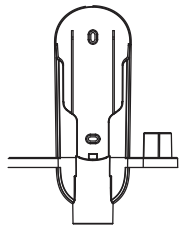
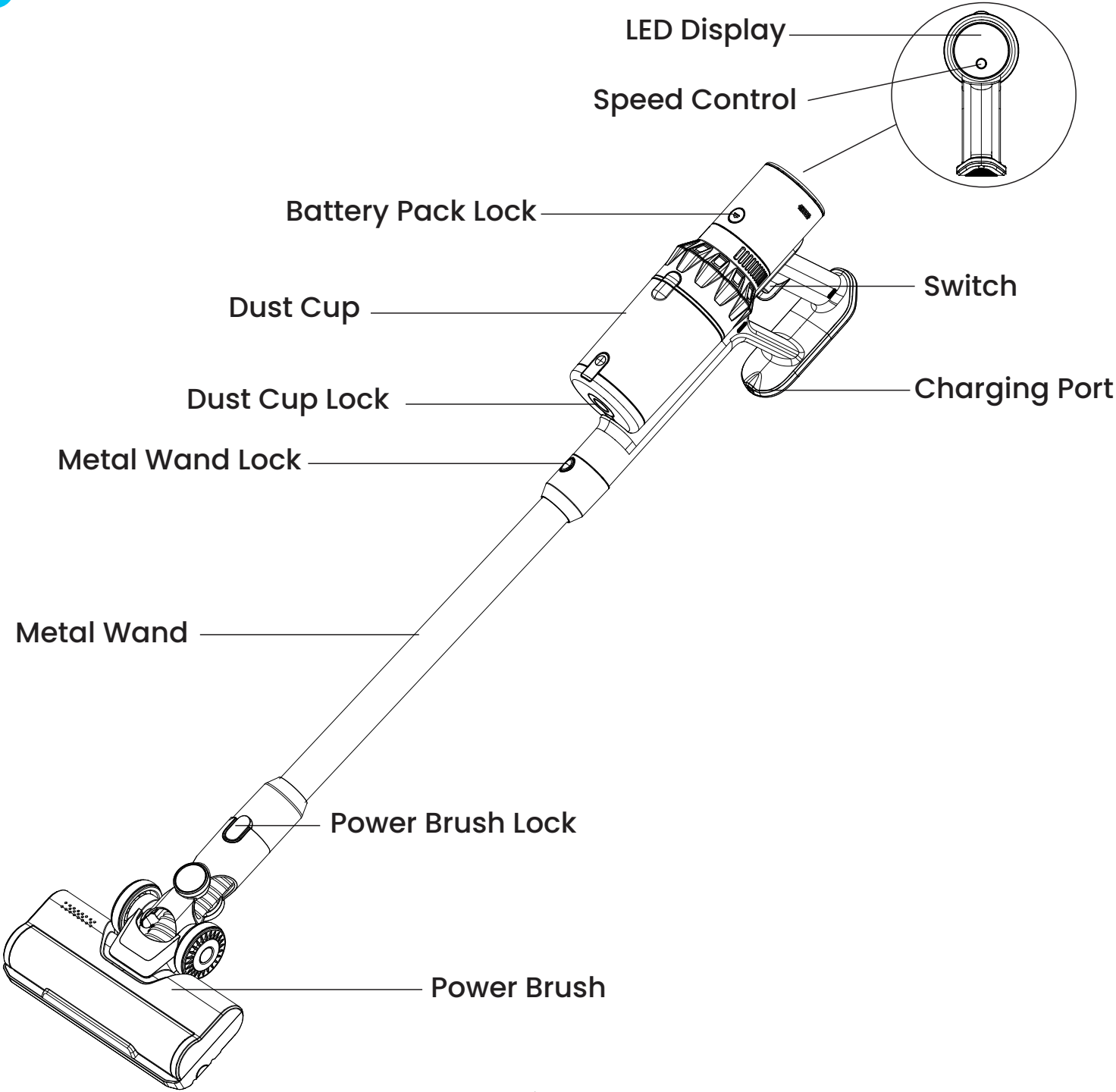

Wall Bracket  
Assembly Accessories

Crevice Brush

2 in 1 Crevice

Adapter

# Instructions for Use

## A. Using with Extension Wand

**1.** Attach the battery pack to the main body until you hear a click, indicating it is securely connected.

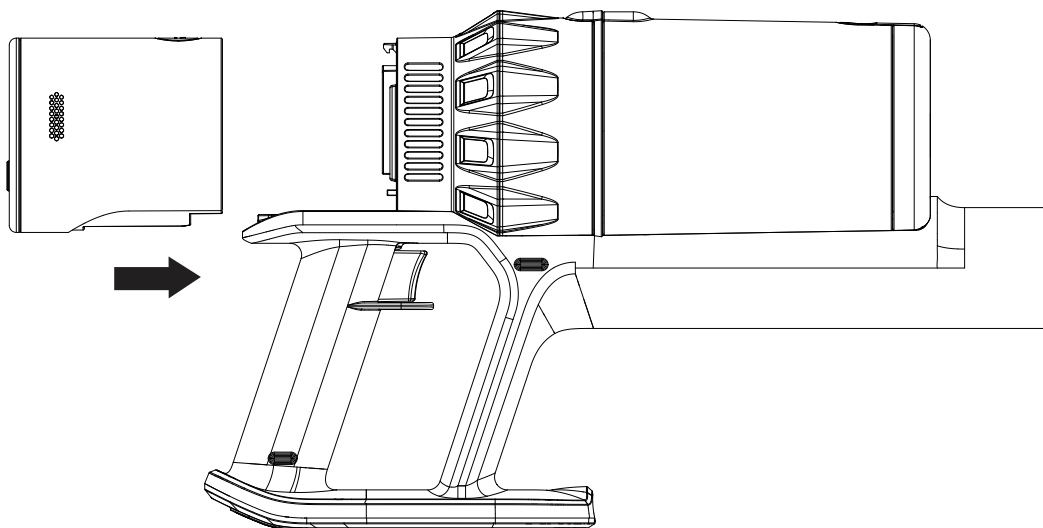

**2.** Connect the metal wand to the main body as shown until you hear a click, confirming it is securely in place.

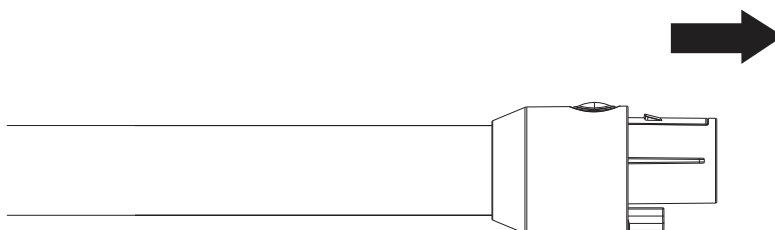

**3.** Attach the brush to the end of the metal wand as illustrated until it clicks into place

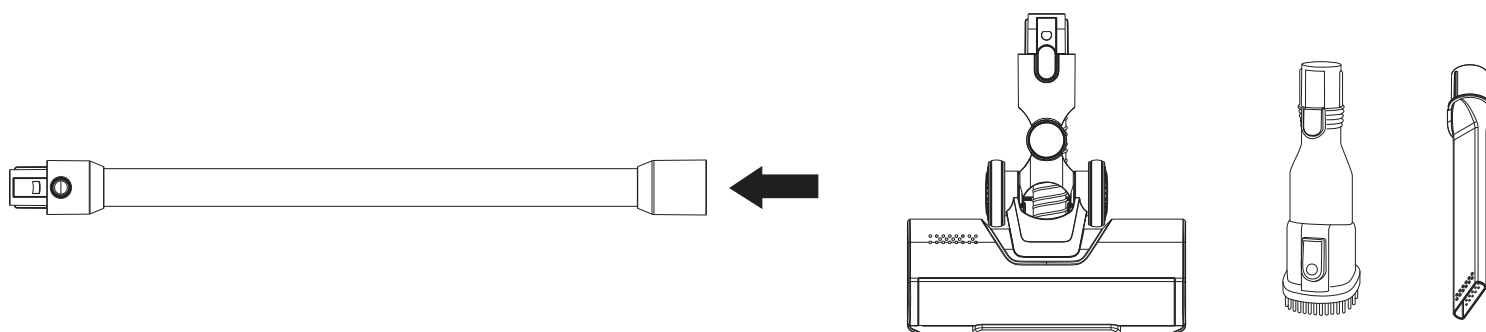

## B. Storage Guide

1. Fix the adapter to the wall bracket as detailed in the instructions.

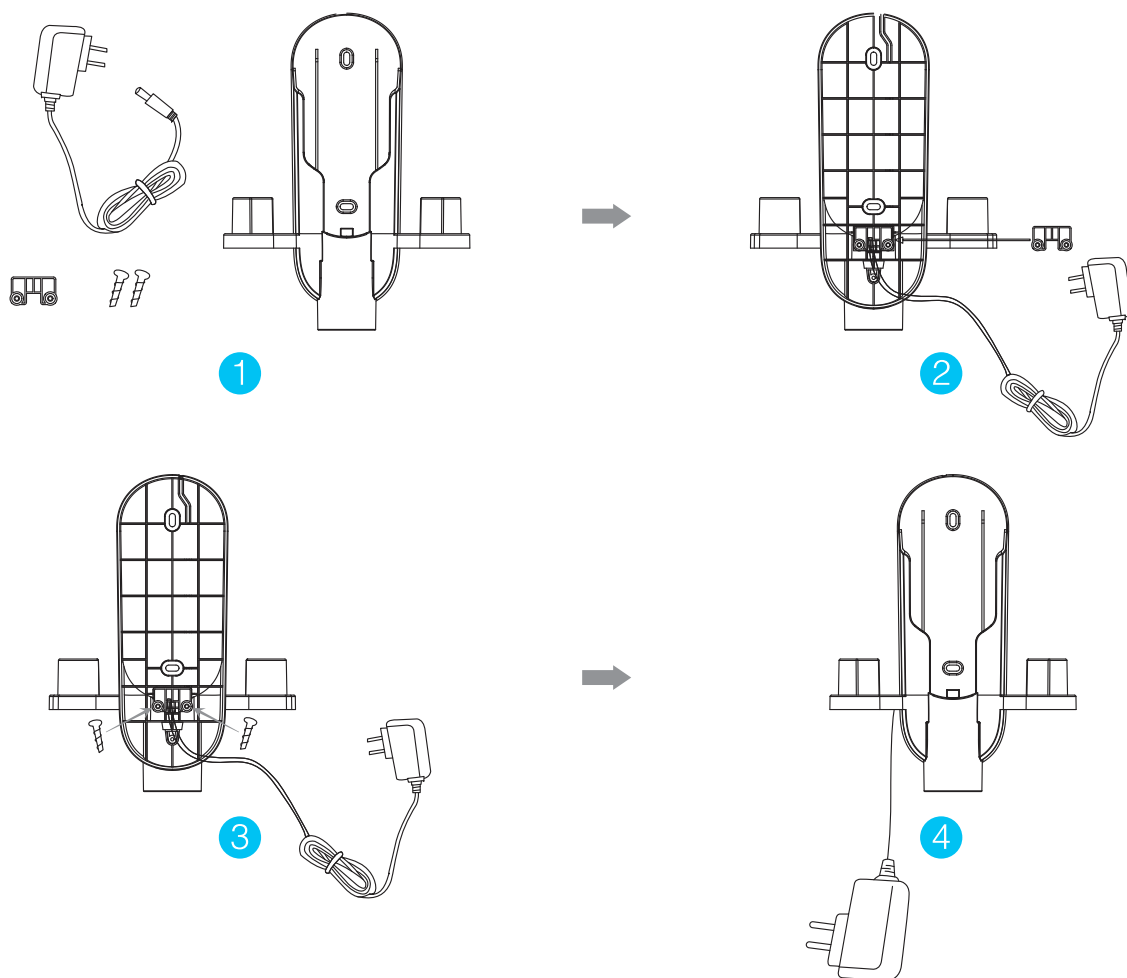

2. Secure the wall bracket to the wall using expansion screws to ensure stability for hanging the vacuum cleaner and its accessories.

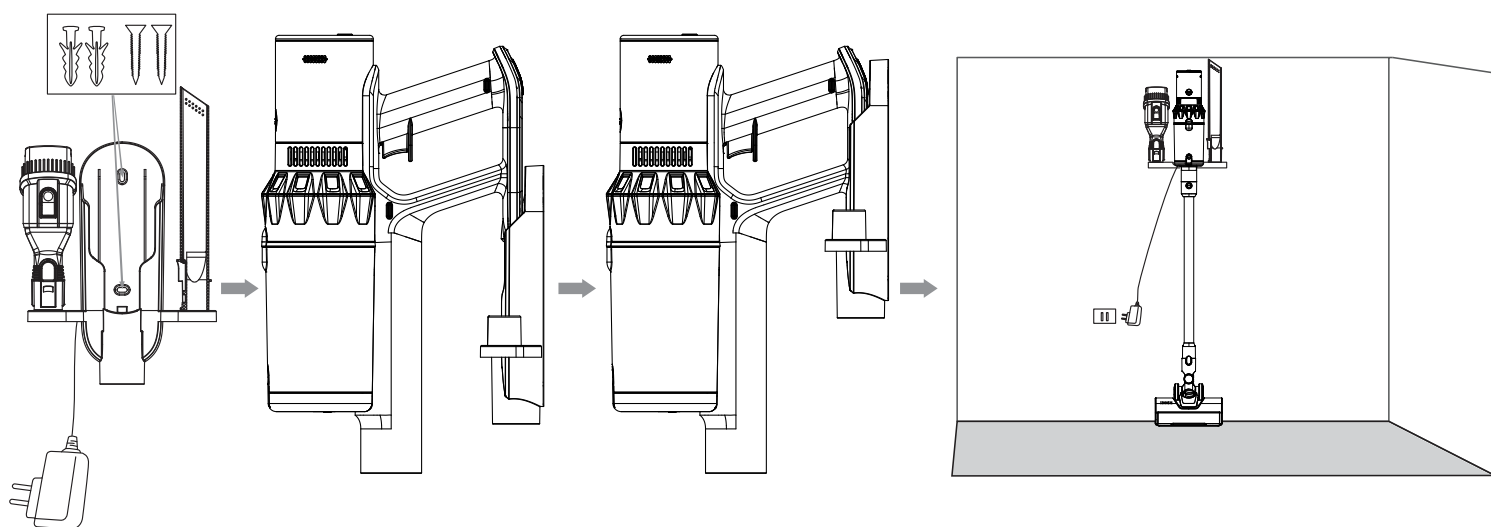

## C. Using as Handheld Vacuum

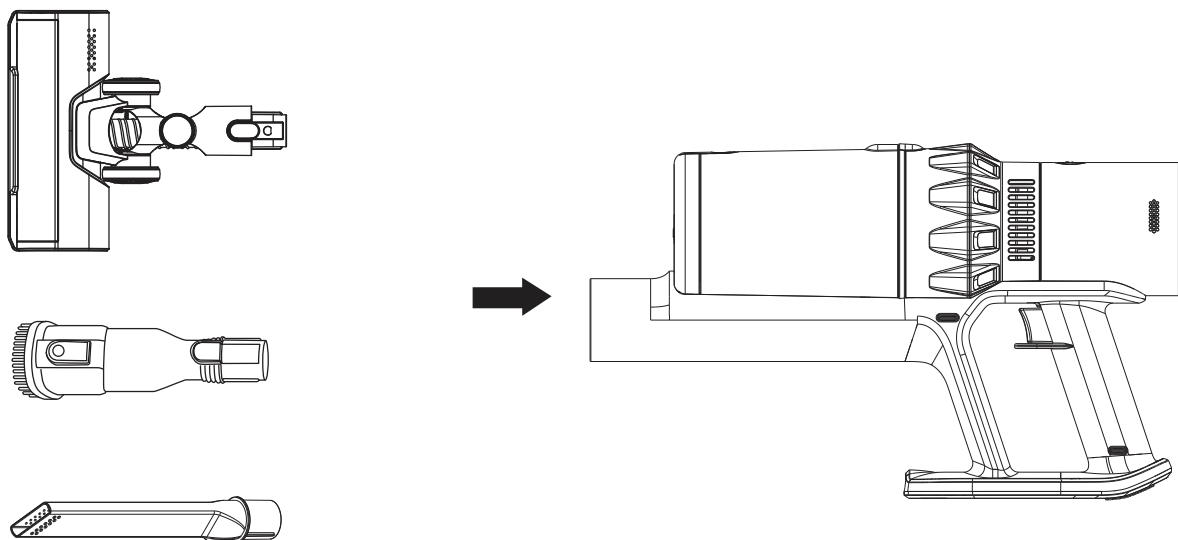

## Powering the Vacuum

**[1]** Press the power switch to turn on the vacuum. The vacuum initially starts in ECO mode.

**[2]** Adjusting the Speed:

1. ECO Mode: Activated upon the initial press of the power switch.

2. AUTO Mode: Engage by pressing the power switch a second time.

3. TURBO Mode: Activate by pressing the power switch a third time.

The cycle then returns to ECO mode with the next press.

**[3]** Press the power switch again after cycling through the modes to power off the vacuum.

Speed Level Indicator

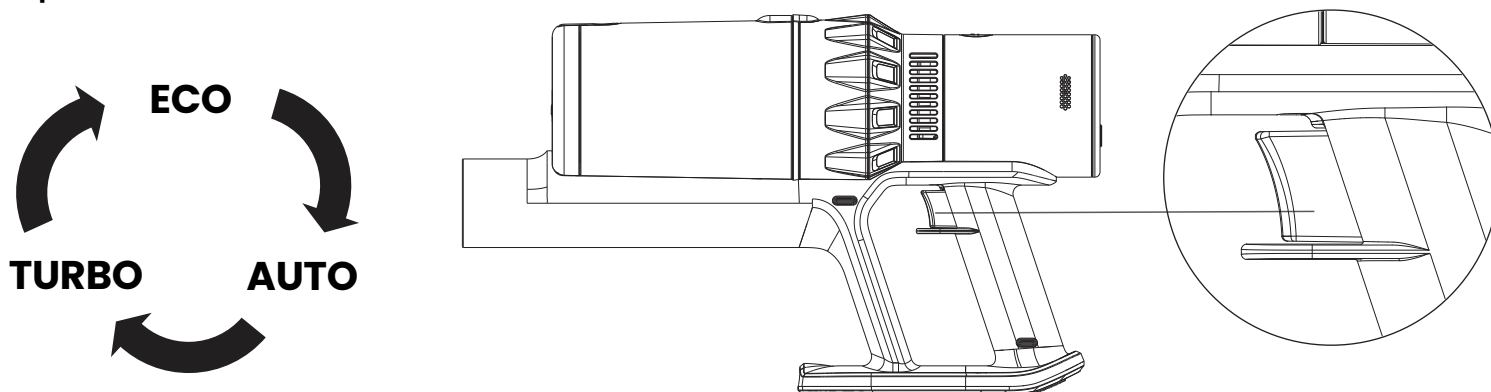

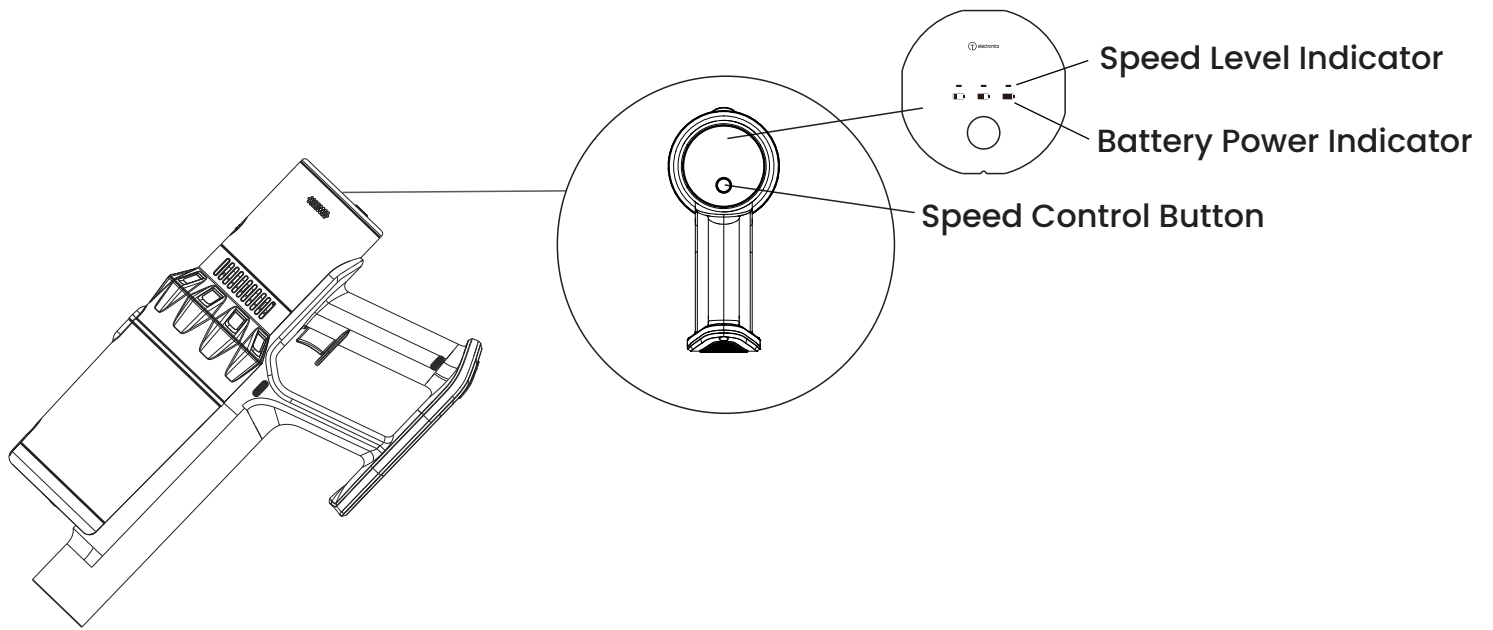

## Charging

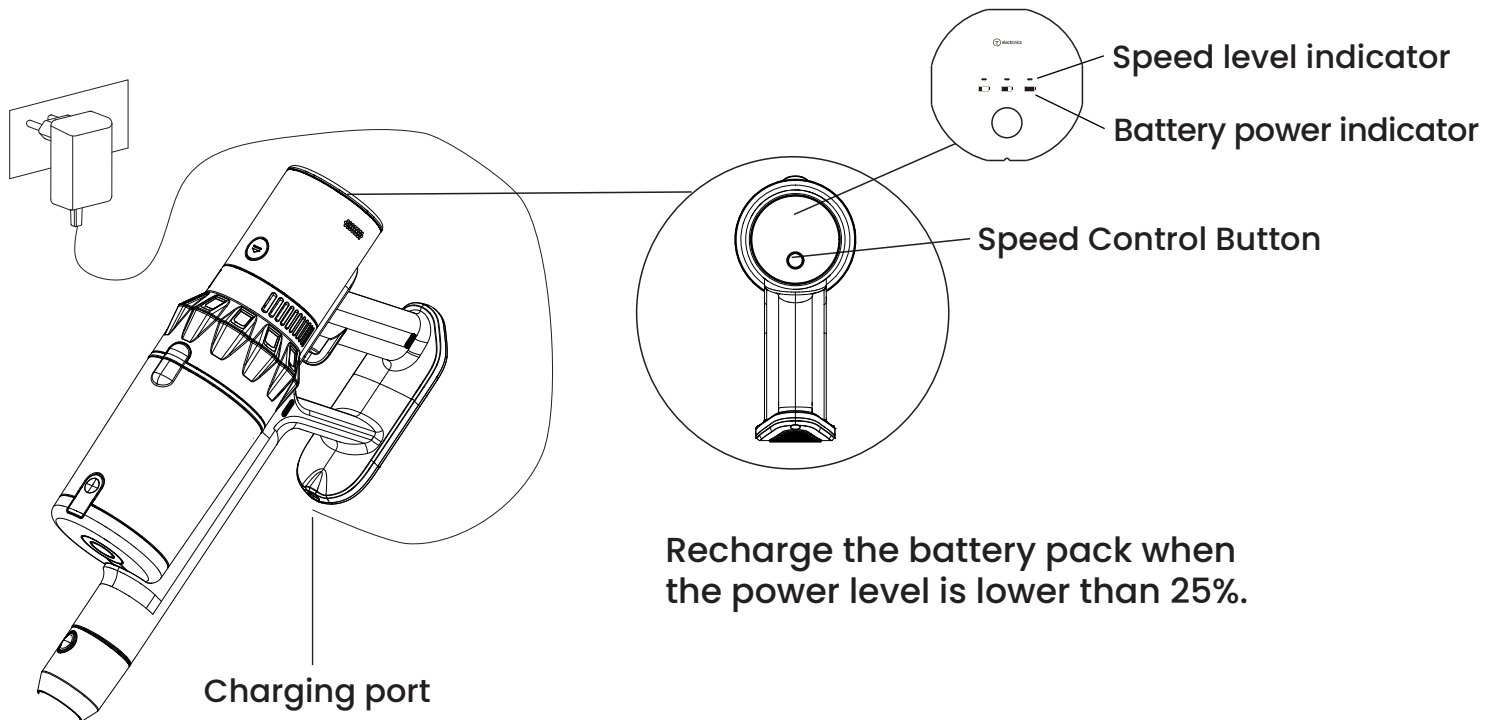

### Warning

To prevent potential safety hazards, only use the charging adapter provided by the manufacturer.

## Empty the Dust Cup

Release the lock on the dust cup.

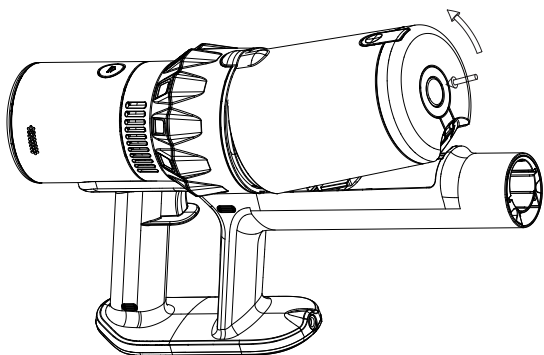

1

Ensure all debris is removed.

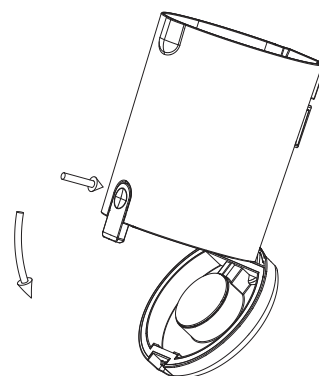

2

## Filter Maintenance

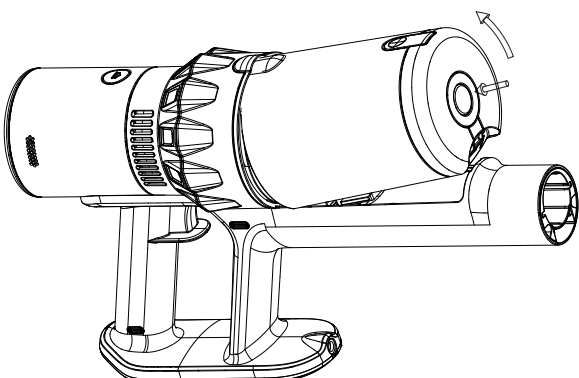

1. Press the release button to detach the dust cup from the main body of the vacuum.

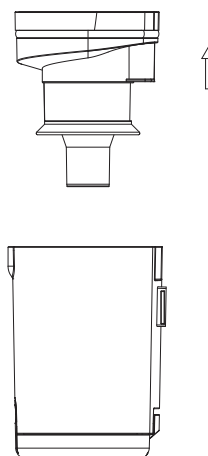

2. Extract the filter case from the dust cup.

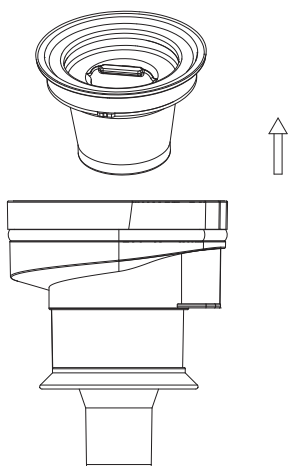

3. Remove the HEPA filter from its case.

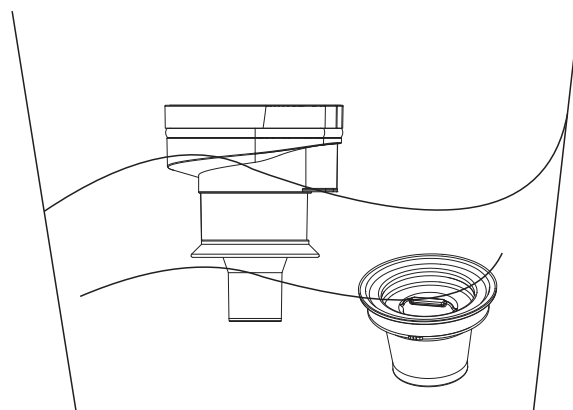

4. Wash both the HEPA filter and its case.

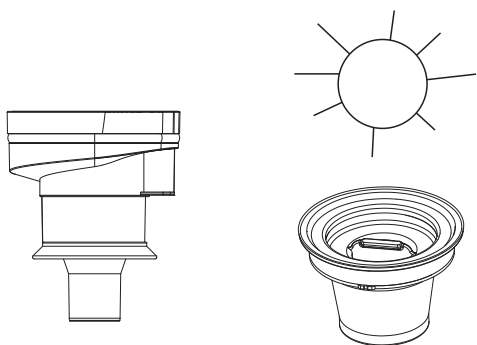

**5.** Thoroughly dry the HEPA filter and its case before reassembly.

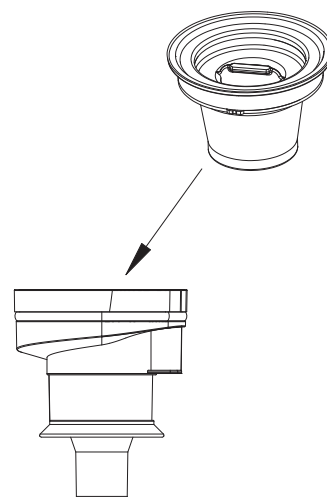

**6.** Reinsert the HEPA filter into its case.

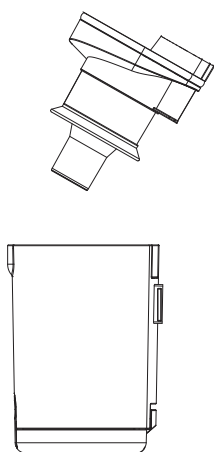

**7.** Place the filter case back into the dust cup.

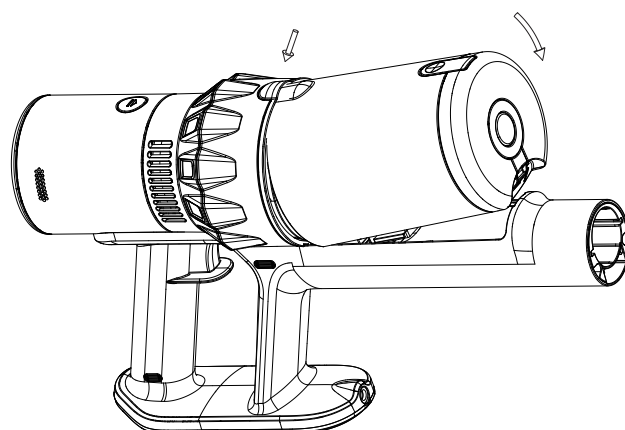

**8.** Attach the dust cup back to the vacuum's main body.

## Specifications

Rated Voltage	100-240V
Rated Frequency	50/60Hz
Battery Capacity	2200mAh, 25.9V Li-ion
Recharge Time	5h
Motor Power	400W
Speed Level	3 Levels
Working Mode	ECO Mode, MED Mode, TURBO Mode
Bin Capacity	500ml
Suction Power	27000Pa
Product Net Weight	2.3kg
Product Dimension	1060×230×218 mm

# Troubleshooting

Error Code	Problem	Solution
E1	Charger voltage is not suitable	Ensure you are using the original charger provided by the manufacturer for optimal charging performance.
E2	The base brush is blocked	Verify that no foreign objects such as dirt, hair, or lint are blocking the brush, preventing it from rotating properly.
E3	Overheated motor	Confirm that the filters are clean, then let the appliance rest for 5 minutes to cool down.
E4	Overheated battery	Let the appliance rest for 5 minutes to prevent overheating.
E5	Overheated brush motor	Allow the appliance to cool for 5 minutes to prevent further damage from overheating.
E9	Overcharged battery	The battery has been charged for too long. Unplug the appliance from the power supply to avoid potential issues.
CF	Filter cleaning reminder	Clean the filter after each use to maintain optimal performance.

## **Warranty**

Products that you buy directly from our **Powerology** website or shop come with a 24-month warranty.

The 24-month warranty applies to products purchased directly from our **Powerology** website or store. If **Powerology** products are bought from any of our verified retailers, then the product is eligible for only a 12-month warranty. To extend your product's warranty, visit our website **[powerology.me/warranty](https://powerology.me/warranty)** and fill in your details in the provided form along with an uploaded picture of the product to process your request. Once approved, you will receive a confirmation email of the extended product warranty. Upload the required information within 48 hours of purchase to be eligible for a 24-month warranty period.

For more info, please check:  
**[powerology.me/warranty](https://powerology.me/warranty)**

## **Contact Us**

If you have any questions about this Privacy Policy, please contact us at: **[hey@powerology.me](mailto:hey@powerology.me)**

Website: **[powerology.me](https://powerology.me)**

Instagram: **[powerology\\_official](https://www.instagram.com/powerology_official)**

Facebook: **[powerology.ME](https://www.facebook.com/powerology.ME)**