



Powerology

**Cordless Stick Vacuum
with Detachable Battery**

SKU: PPBCHA53



Table of Contents

Important Safety Instructions	2
Schematic View	5
Instructions for Use	5
A. Using with Extended Wand	5
B. Using as Handheld Vacuum	6
Button Instructions	6
Battery Assembly	7
Charging Guide	7
Cleaning the Dust Cup	8
Filter Maintenance	8
Troubleshooting	9
Specifications	10
Warranty	11
Contact Us	11

Important Safety Instructions

Warning: Always follow basic safety measures when using this electrical appliance to prevent the risk of fire, electric shock, or injury.

A. Personal Safety

- 1.** Keep the appliance in a dry place indoors, away from children.
- 2.** This appliance is not suitable for individuals (including children) who have impaired physical, sensory, or mental abilities, or lack experience and knowledge, unless they are under the supervision of a responsible adult.
- 3.** Always supervise children to ensure they do not play with the appliance.
- 4.** Use only the attachments recommended by the manufacturer as specified in this manual to avoid injury.
- 5.** Exercise extra caution when cleaning stairs.
- 6.** Keep the appliance and its accessories away from hot surfaces.
- 7.** Do not block the appliance's air openings. Ensure these openings are free from dust, lint, clothing, and body parts including fingers and hair.
- 8.** Be especially careful to keep hair away from openings and moving parts.

B. Electrical Safety

- 1.** Use only the batteries and charger supplied by the manufacturer. Ensure the appliance is connected only to the power supply unit provided.
- 2.** Do not modify the charger in any manner.
- 3.** The charger is designed for a specific voltage. Always verify that the voltage matches that stated on the rating plate.
- 4.** Use the charger only with the battery type for which it is specified. Using it with a different battery may pose a fire risk.

5. Before use, inspect the charger cord for any signs of damage or wear. A damaged or tangled cord can increase the risk of fire and electric shock.
6. Treat the charger cord with care to prevent damage.
7. Do not carry the charger by the cord.
8. To disconnect the charger, hold the plug and pull. Do not pull the cord.
9. Do not wrap the cord around the charger when storing.
10. Keep the charger cord away from hot surfaces and sharp edges to prevent damage.
11. The supply cord is non-replaceable. If damaged, the charger should be discarded and replaced.
12. Avoid handling the charger or appliance with wet hands to prevent electric shock.
13. Do not store or charge the appliance outdoors.
14. Always remove the charger from the socket before removing the battery, cleaning, or performing any maintenance on the appliance.

C. Battery Safety

1. This appliance uses Li-ion batteries. Do not incinerate or expose them to high temperatures, as they may explode.
2. If battery liquid contacts skin or eyes, it can cause irritation or burns. If contact occurs, wash skin with soap and water. If eyes are affected, flush with clean water for at least 10 minutes and seek medical attention.
3. In case of a battery emergency, contact professional help immediately.
4. If the battery leaks, avoid touching the liquid. Wash any skin contact areas with soap and water. For eye contact, flush with water for 10 minutes and wear gloves. Dispose of the battery following local regulations.
5. Short-circuiting the battery terminals can cause burns or start a fire.

6. When not in use, store the battery pack safely away from items like paper clips, coins, and keys that can create a conductive path and possibly cause a short circuit.
7. When disposing of the appliance, remove and dispose of the battery according to local regulations.
8. The batteries in this appliance are not replaceable.

D. Service

1. Inspect the appliance for signs of wear or damage before use and after any impact. Repair as necessary.
2. Do not use the appliance if any part is damaged.
3. All repairs should be conducted by a service center. Repairs by unqualified individuals could pose risks.
4. Do not modify the appliance in any way as this could increase the risk of injury.
5. Use only replacement parts or accessories provided by the manufacturer.

E. Intended Use

1. This appliance is specifically designed for domestic dry vacuum cleaning.
2. Do not use the vacuum to pick up liquids or on wet surfaces.
3. Avoid picking up anything that is flammable or emitting smoke.
4. Operate the appliance only as directed in this manual.
5. Do not use the appliance on concrete, tarmac, or other rough surfaces.

F. Warning

1. Clean the exterior of the appliance only with a dry cloth. Do not use water, solvents, or polishes.
2. Never immerse the unit in water nor attempt to clean it in a dishwasher.

Schematic View

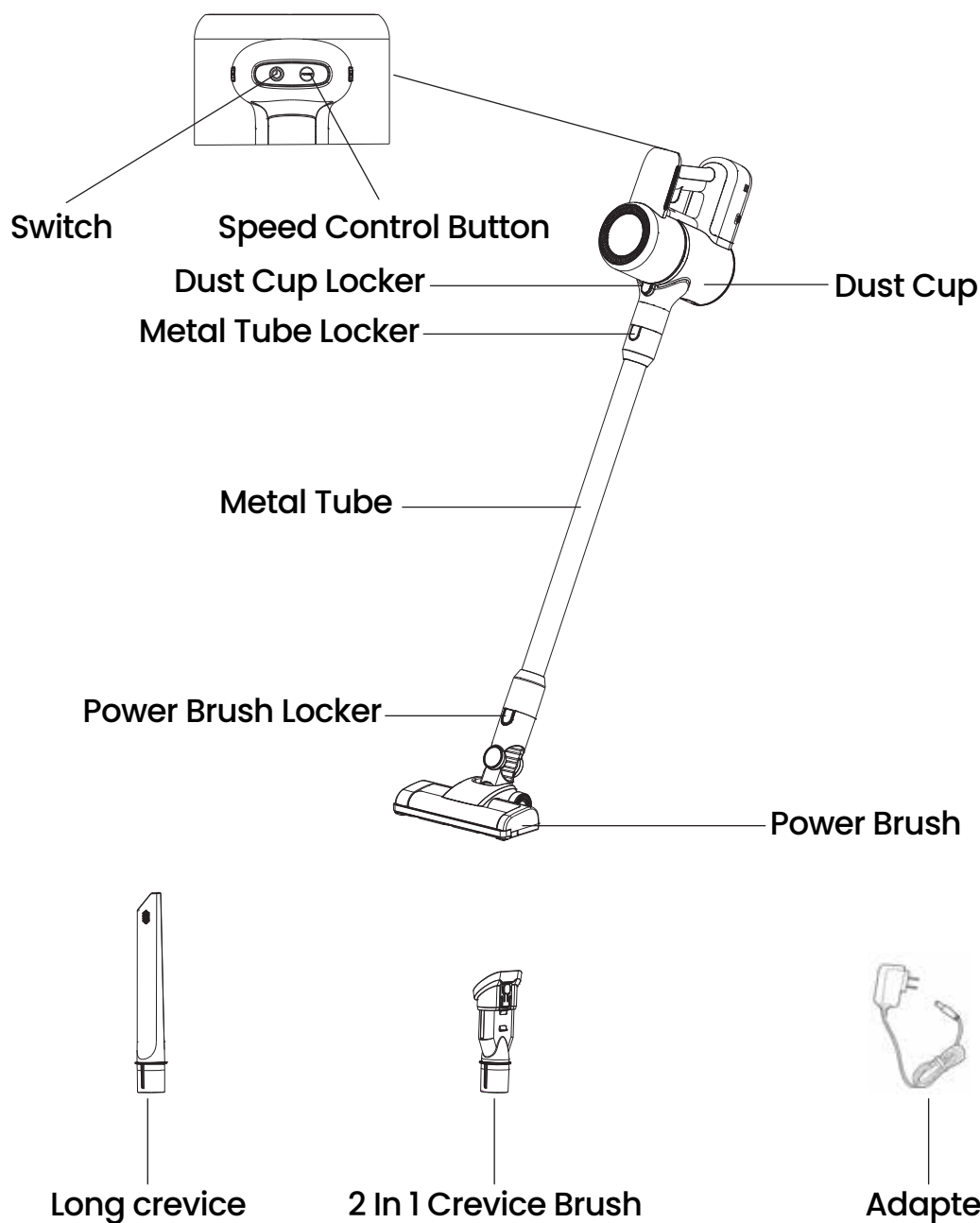

Instructions for Use

A. Using with Extended Wand

1. Insert the handle into the dust cup slot, ensuring that the battery bolt head is properly aligned as shown.

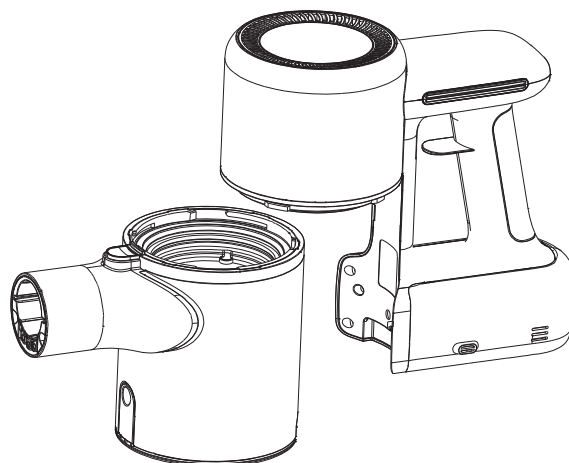

2. Connect the metal tube to the vacuum body until you hear a click, indicating it is securely attached.

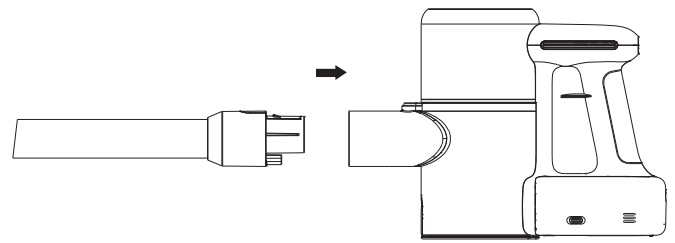

3. Attach the brush to the other end of the metal tube.

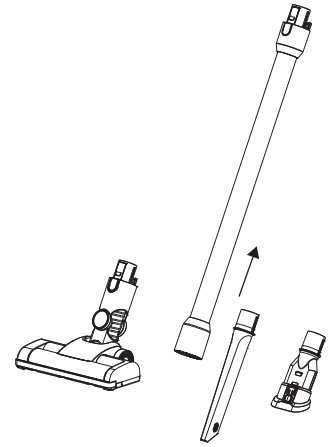

B. Using as Handheld Vacuum

Connect the brush to the body of the vacuum cleaner as shown in the illustration. Ensure it is securely attached by pushing it into place until you hear a clicking sound.

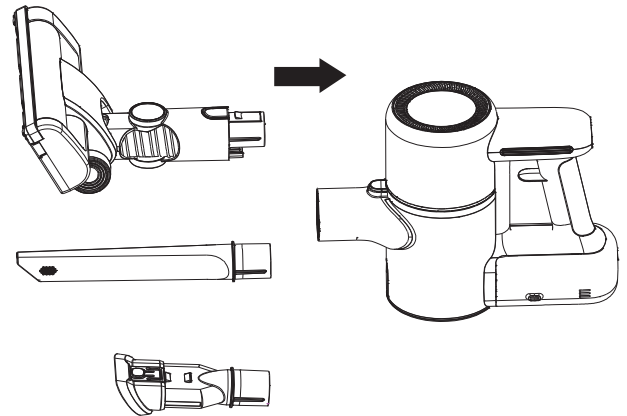

Button Instructions

[A] Power On/Off: To turn the vacuum on or off, press the switch button.

[B] Three-Level Speed Control:

Low Power: When you press the switch button for the first time, the vacuum operates at low power.

Medium Power: Press the speed control button once to switch to medium power.

High Power: Press the speed control button a second time to switch to high power. Pressing it again will return the vacuum to low power.

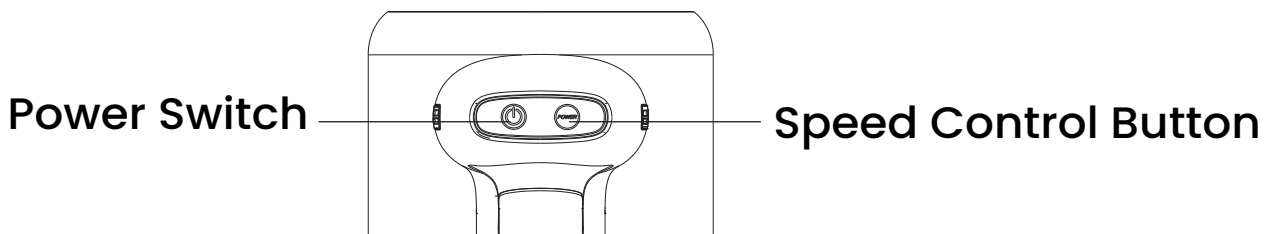

Battery Assembly

1. Insert the battery pack into the main body of the vacuum until you hear a clicking sound, indicating it is securely in place.

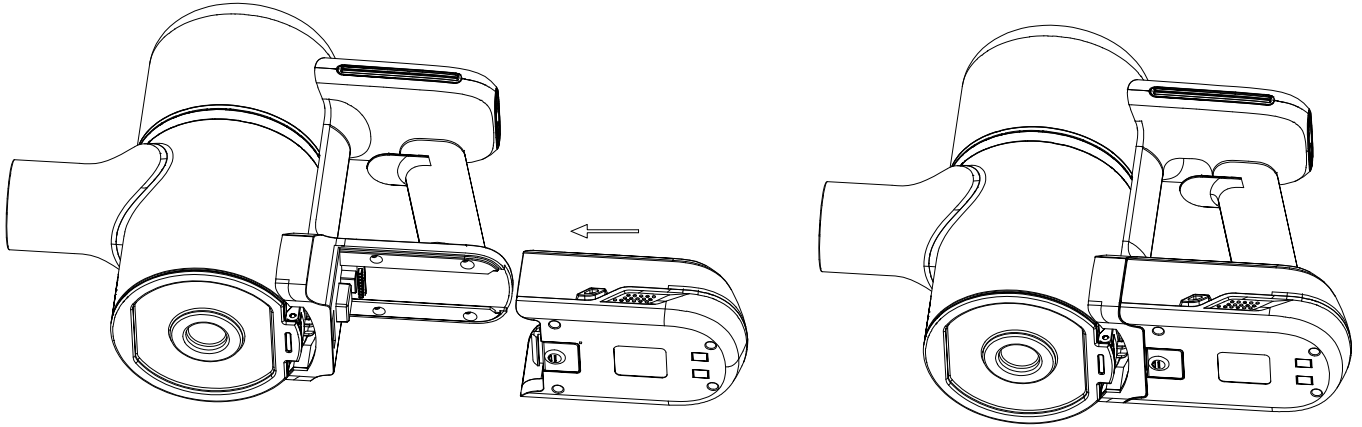

2. To remove the battery pack, simply slide it out from the main body as shown in the diagram.

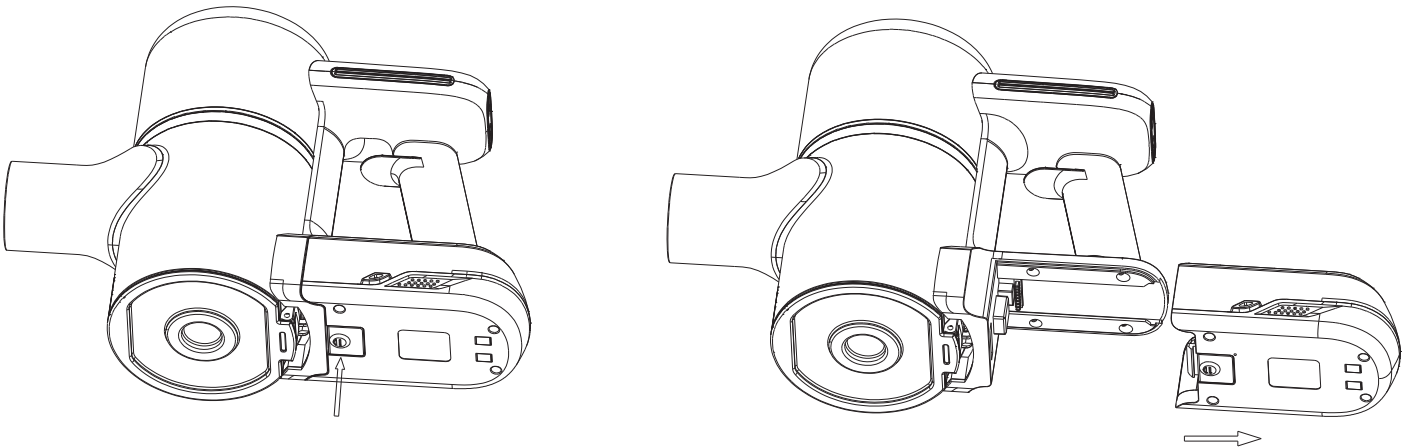

Charging Guide

When the last indicator light on the screen is flashing, this indicates that the battery power is low and needs to be charged. Connect the charger to a power supply and to the charging port. The charging process is active while the indicator lights continue to flash.

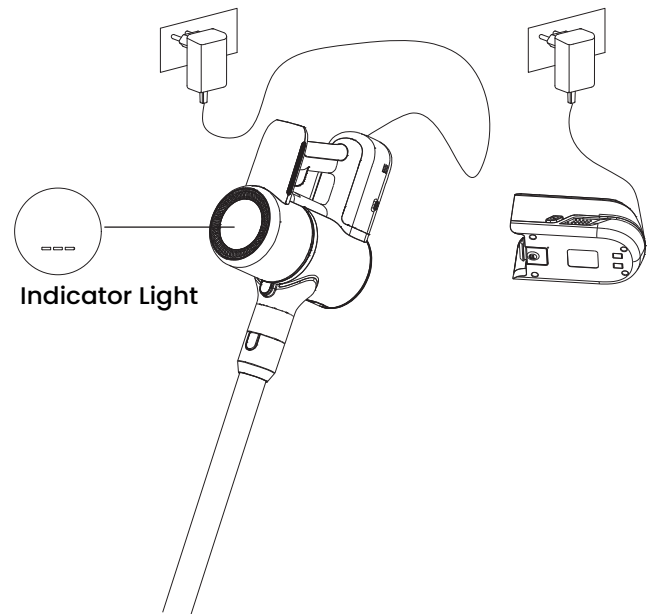

The battery is fully charged when the indicator lights remain steadily on. The battery pack is charging when the indicator light is red. The charging process is complete when the battery pack indicator light turns blue.

Cleaning the Dust Cup

Press the metal tube locker then take out the metal tube

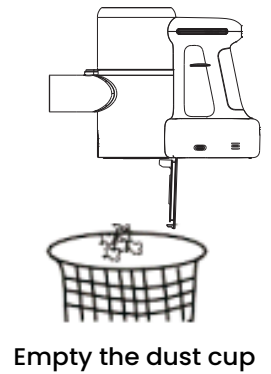
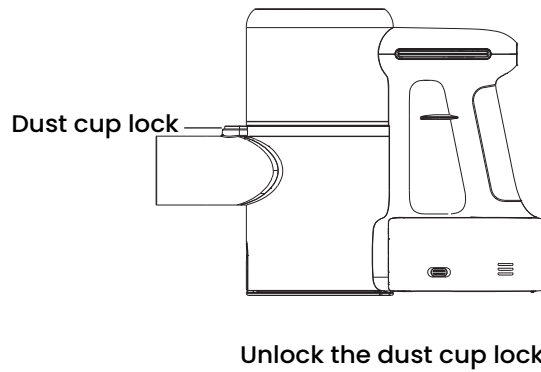
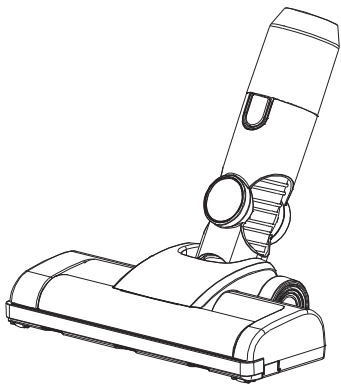
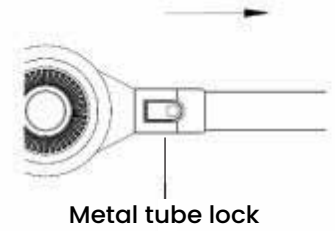

Filter Maintenance

1. Press the release button to detach the handle from the dust cup.

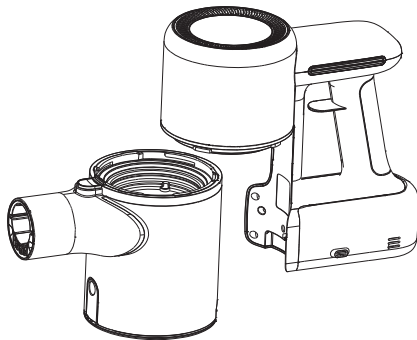

2. Take out the filter case, then remove the HEPA filter from the case.

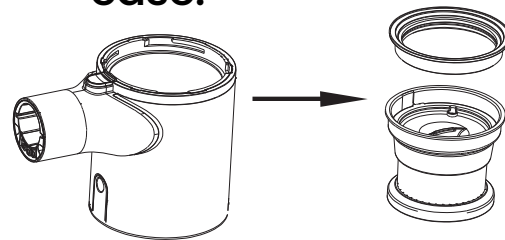

3. Clean both the filter case and the HEPA filter thoroughly.

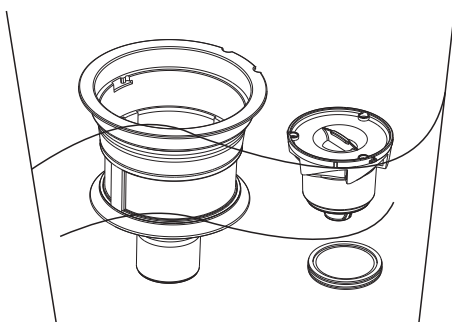

4. Allow the filter and filter case to dry completely.

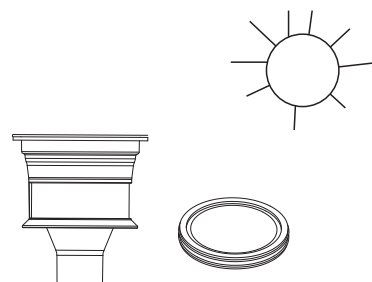

5. Insert the HEPA filter back into the filter case.

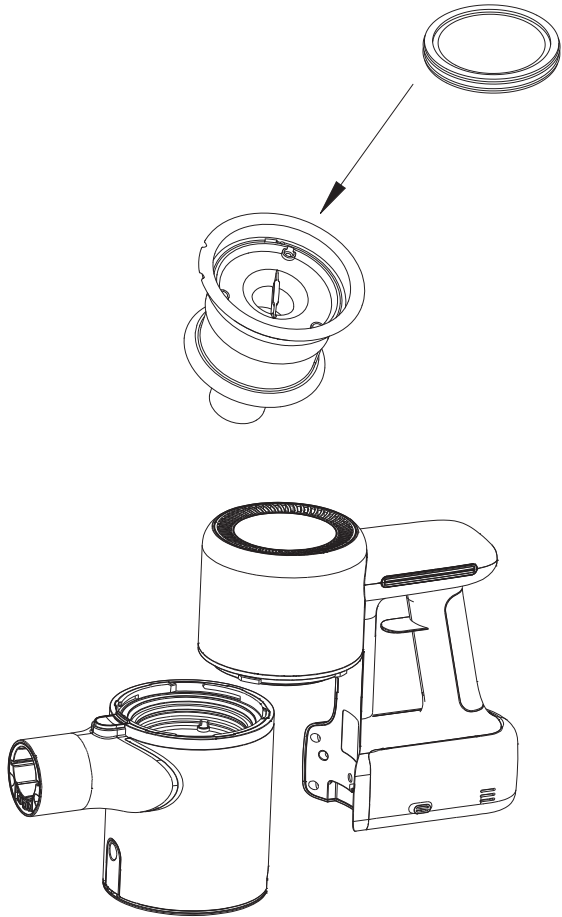

6. Place the filter case back into the dust cup.

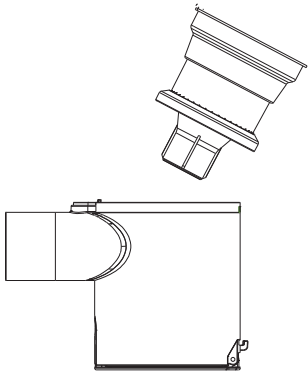

7. Assemble the dust cover onto the dust cup securely.

Troubleshooting

Problem	Solution
Weak Suction	1. Regularly remove and empty the dust cup to maintain suction power. 2. Ensure the HEPA filter is clean to optimize performance. 3. Verify that the dust cup is installed correctly.
Vacuum Stops Working	1. Ensure the battery is fully charged for optimal performance. 2. Regularly clean the brush to prevent clogs and maintain suction.
Roller Brush Stops Spinning and Produces Unusual Noise	1. Check if the brush, especially the bearing area, is clogged with hair or debris. 2. Ensure that the filter cup is properly installed in its designated position. 3. Detach the tube and use the handheld part only. If it does not function, contact the service center for assistance.
Battery Does Not Hold a Charge	1. Ensure that the charger and charging base are connected properly. 2. If there is no indicator light while charging, contact the professionals service centers.

Specifications

Rated Voltage	100–240V
Rated Frequency	50/60Hz
Battery Capacity	2000mAh, 22.2V Li-ion
Recharge Time	5H
Motor Power	350W
Speed Level	3 Levels
Working Mode	ECO Mode, MED Mode, Turbo Mode
Bin Capacity	500ml
Suction Power	25000Pa
Net Weight	2.3 KG
Dimension	218×230×1060mm

Warranty

Products that you buy directly from our **Powerology** website or shop come with a 24-month warranty.

The 24-month warranty applies to products purchased directly from our **Powerology** website or store. If **Powerology** products are bought from any of our verified retailers, then the product is eligible for only a 12-month warranty. To extend your product's warranty, visit our website **powerology.me/warranty** and fill in your details in the provided form along with an uploaded picture of the product to process your request. Once approved, you will receive a confirmation email of the extended product warranty. Upload the required information within 48 hours of purchase to be eligible for a 24-month warranty period.

For more info, please check:
powerology.me/warranty

Contact Us

If you have any questions about this Privacy Policy, please contact us at: **hey@powerology.me**

Website: **powerology.me**

Instagram: **powerology_official**

Facebook: **powerology.ME**