



**Powerology**  
**Cordless Spot Cleaner**  
SKU: PPBCHA50





# Table of Contents

Warning	2
Battery Pack Maintenance	3
Important Note	4
Usage Prohibitions	4
Usage Precaution	5
Schematic View	6
Preparation Before Use	7
Instructions for Use	8
Cleaning Stubborn Stains	9
Clean the Dirty Water Tank	9
Charging Method	10
Troubleshooting	11
Specifications	12
Warranty	13
Contact Us	13

## **Warning**

- 1.** Use water at temperatures below 40°C to remove dirt from the unit.
- 2.** Avoid using the unit to clean arts and crafts, fibers, or items that are sensitive to water damage such as floors and tables.
- 3.** Do not tilt the unit with water in the tank to prevent spills and floor wetting.
- 4.** Stop the machine and empty the dirty water tank once it is full.
- 5.** Ensure the detergent used is safe for the items being cleaned.
- 6.** The machine may stop if it encounters long hair on carpets or excessive foam; if this happens, clear the air outlet and empty the dirty water tank before reuse.
- 7.** Do not use foam-based detergents.
- 8.** Ensure that all users, including children, are supervised when using the machine.
- 9.** Avoid using liquids like pesticides, hair dyes, and lubricants.
- 10.** Do not use the machine to pick up flammable or combustible materials, including cigarettes.
- 11.** Avoid using the machine to pick up oil, hot substances, or dry dust.
- 12.** Do not block the air outlet as it can affect the machine's ability to dissipate heat.
- 13.** Stop using the machine if you notice any unusual noises or smells.
- 14.** Do not disassemble, repair, or alter the machine yourself.
- 15.** Avoid using the machine in very wet conditions to prevent water damage to the unit.
- 16.** Do not immerse the unit in water or other liquids to avoid risks of fire or electric shock.
- 17.** Avoid using the unit to pick up dust that poses infectious risks.
- 18.** Ensure the dirty water tank is properly installed before use.

- 19. If the supply cord is damaged, it must be replaced by the manufacturer or their certified service agent to prevent hazards.
- 20. Children aged 8 years and older, and persons with reduced physical, sensory, or mental capabilities, may use this appliance if they have been given proper supervision and instructions on safe use.
- 21. Children must not use the appliance without supervision, and they should not perform cleaning or maintenance tasks.
- 22. Only use the power supply unit provided with the appliance.
- 23. Charge the Li-ion battery only within the ambient temperature range specified in the battery instructions.
- 24. Charging in temperatures below 0°C or above 45°C can lead to serious battery safety issues.

Correct Disposal	
 	<p>Here's a refined and formal version of the recycling notice for the cordless spot cleaner manual:</p> <p>This symbol indicates that this product should not be treated as household waste within the EU. To avoid potential environmental or health risks associated with uncontrolled waste disposal, please recycle this product responsibly to support the sustainable reuse of material resources. If you wish to dispose of your used device, utilize the return and collection systems available or contact the retailer where the product was purchased. They will ensure that the product is recycled in an environmentally safe manner.</p>

## Battery Pack Maintenance

- 1. If the battery leaks, avoid contact with your eyes or skin. Should contact occur, wash immediately with clean water and seek medical attention.
- 2. Use only the provided battery pack, adapter, and charging base with the vacuum cleaner.

3. Do not disassemble, repair, or modify the battery pack, adapter, or charging base yourself. If maintenance is needed, contact customer service.
4. Avoid installing the wall rack and charging station near heat sources or damp areas.
5. Do not clean the adapter or charging base with a damp cloth or while your hands are wet. Dispose of used batteries properly; do not expose them to fire or water.
6. If you do not intend to use the product for an extended period, disconnect the power adapter after fully charging. Store the device in a cool, dry place and recharge the battery at least every three months to prevent over-discharge.
7. If the battery pack needs to be replaced, contact customer service for assistance. Do not repurpose the old battery for other uses.
8. If the power adapter cord is damaged, contact customer service for repair or replacement.

## Important Note

1. This machine is designed primarily for wet cleaning; do not use it to pick up large quantities of dust.
2. In cold temperatures, ensure the dirty water tank, clean water tank, and the inside of the hose are dried to prevent freezing.
3. If the hose becomes blocked, remove any foreign objects before using the machine again.

## Usage Prohibitions

Do not vacuum the following material:

1. Dry dust
2. Large quantities of powder
3. Significant amounts of sand and stones
4. Large amounts of rubbish

5. Metal objects such as needles and pins
6. Large plastic bags and stockings
7. Items that are easily dumped inside the unit

## **Usage Precaution**

1. This machine is intended for cleaning purposes only.
2. It is designed for household use exclusively.
3. Keep the machine away from fire or heating equipment.
4. Cease operation if the water spray nozzle becomes blocked.
5. Stop using the machine if any foreign objects are drawn into it.
6. Empty the tanks if they are blocked before using the machine again.
7. Do not tilt or ride on the machine.
8. Keep the machine out of reach of children.
9. This machine is not intended for outdoor use.
10. Do not continue operating the machine if the suction hole is blocked.



# Schematic View

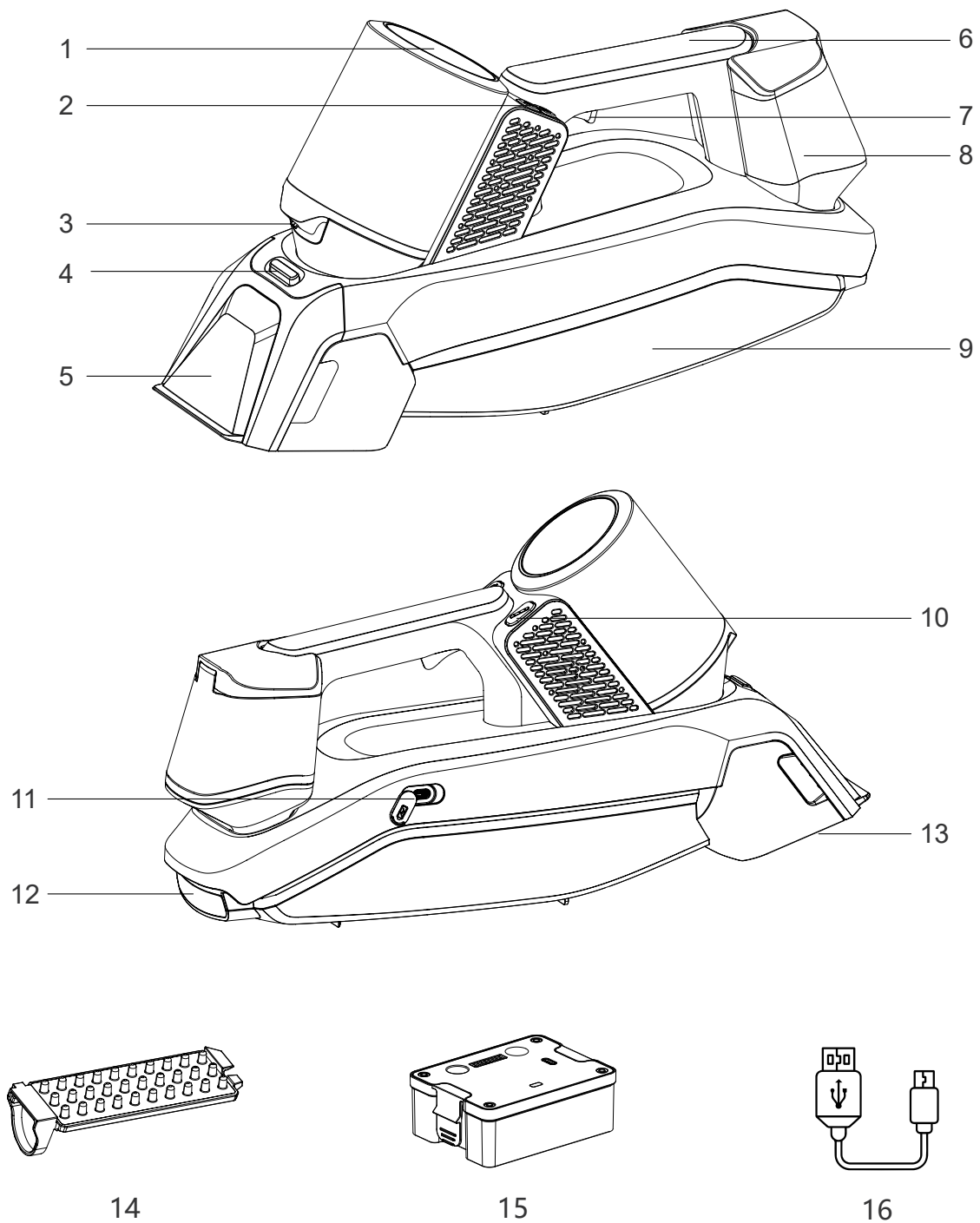

<b>1.</b> Display Screen	<b>9.</b> Wastewater Tank
<b>2.</b> Suction Button	<b>10.</b> Rolling Brush Button
<b>3.</b> Spraying Nozzle	<b>11.</b> Charging Port
<b>4.</b> Releasing Button	<b>12.</b> Wastewater Releasing Button
<b>5.</b> Suction Cover	<b>13.</b> Electric Rolling Brush
<b>6.</b> Handle	<b>14.</b> Soft Rubber Scrub Brush
<b>7.</b> Spraying Button	<b>15.</b> Battery Pack
<b>8.</b> Cleaning Water Tank	<b>16.</b> USB Cable

## Preparation Before Use

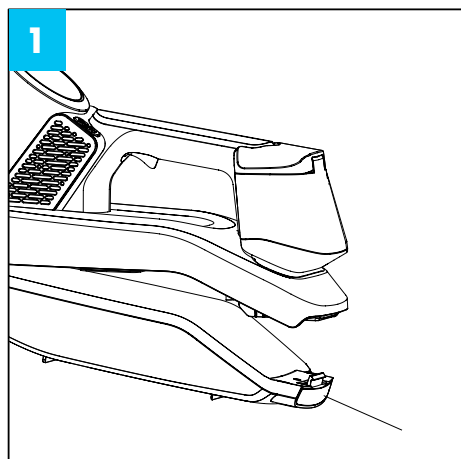

**1.** Press the Wastewater Releasing Button to remove the wastewater tank.

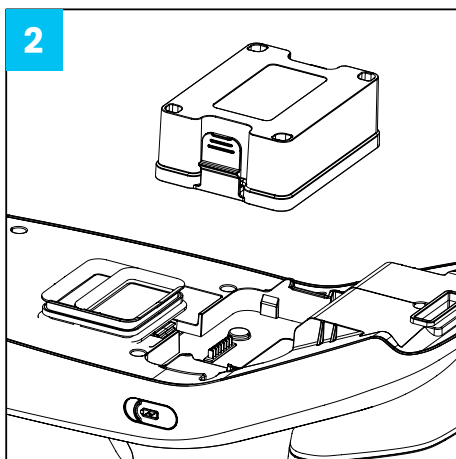

**2.** Insert the Battery Pack into the designated compartment, then secure the wastewater tank back into place.

**Note:** Ensure the battery pack is fully charged before first use.

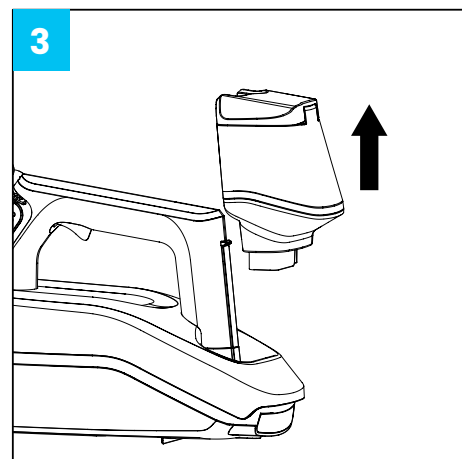

**3.** Lift the Cleaning Water Tank to prepare for filling.

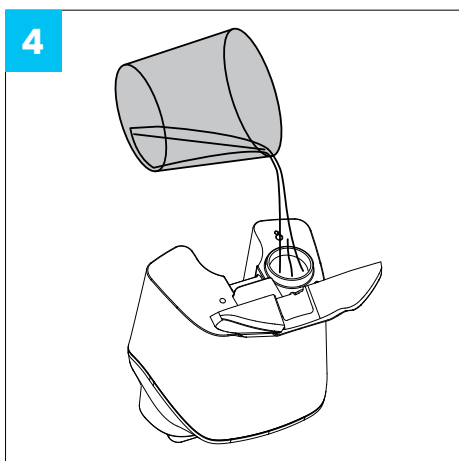

**4.** Open the lid of the cleaning water tank and fill it with water.

**Note:** Do not exceed the maximum water level indicated.

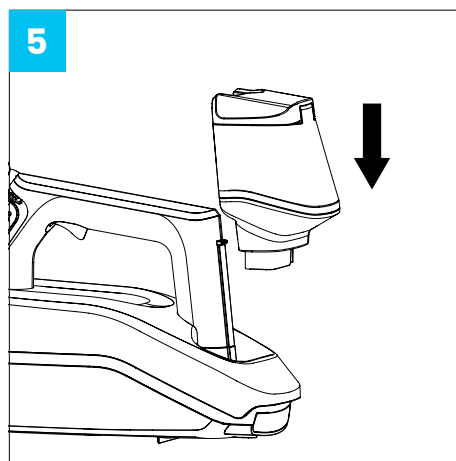

**5.** Install the Cleaning Water Tank back into the machine to complete the setup.



## Warnings

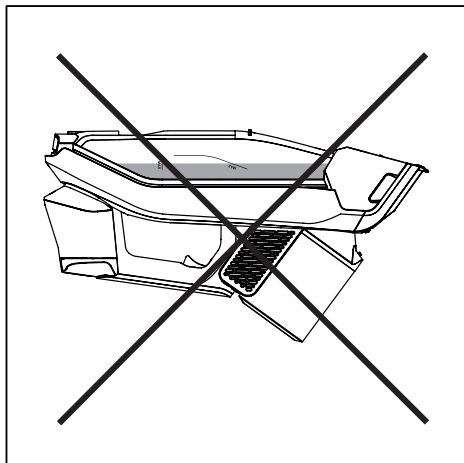

**1.** Do not invert the machine.

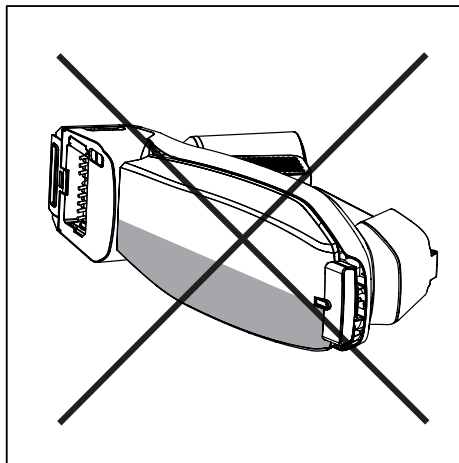

**2.** If the machine turns over, the full recovery tank may leak water.

## Instructions for Use

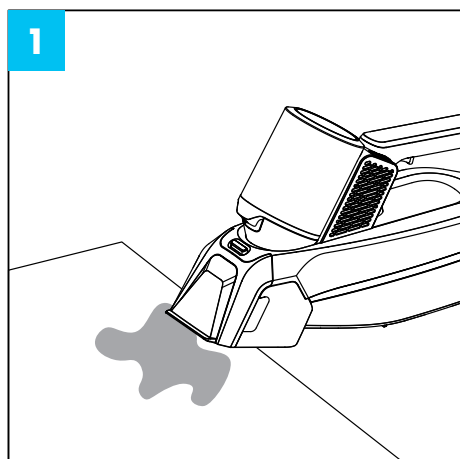

**1.** Grip the cleaner and aim it at the stains.

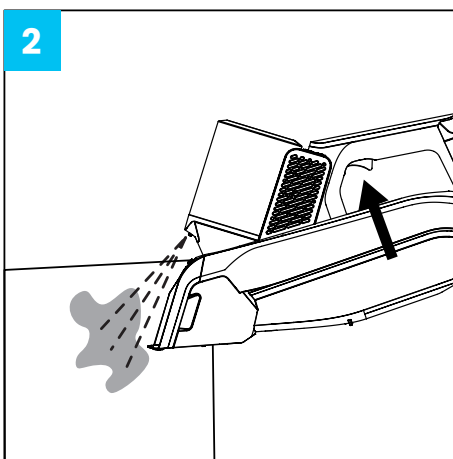

**2.** Press the spraying button to apply the cleaning solution.

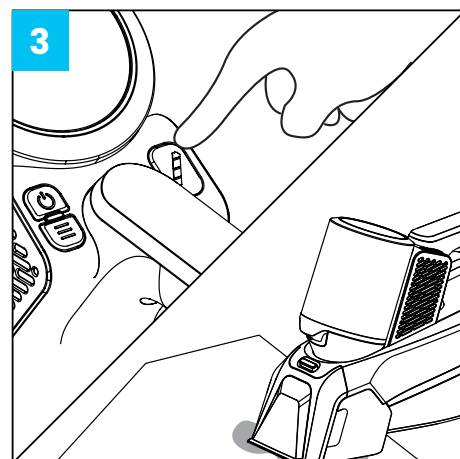

**3.** Activate the rolling brush by pressing the corresponding button to help remove the stains.

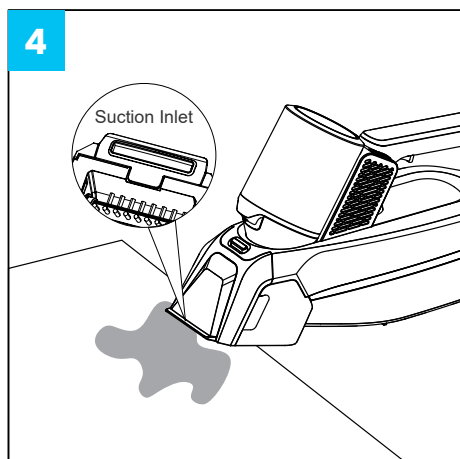

**4.** Direct the suction inlet to the spot you wish to clean.  
**Note:** Ensure the suction inlet is positioned horizontally to maintain effective suction.

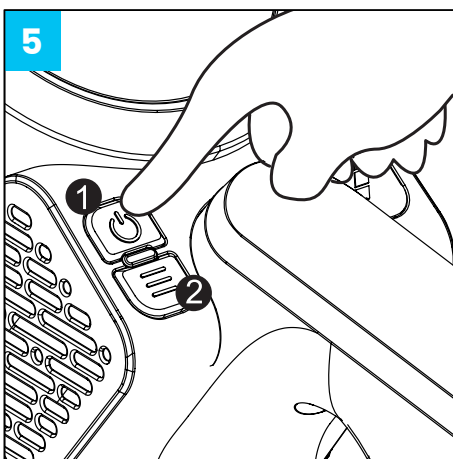

**5.** Engage the water suction to remove wastewater. Press the high and low switch to adjust the suction strength as needed.

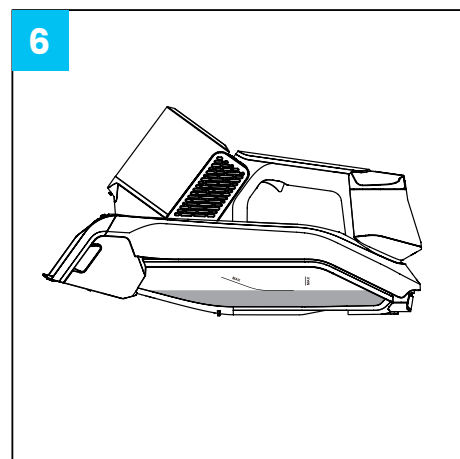

**6.** Stop using the cleaner when the wastewater tank reaches its maximum capacity. Empty the tank and clean it before further use.

## Cleaning Stubborn Stains

Use fabric detergent to effectively clean stubborn stains. Mix the water and detergent in the appropriate proportions to fill the tank up to the maximum line mark. Then, install the clean water tank back onto the machine.

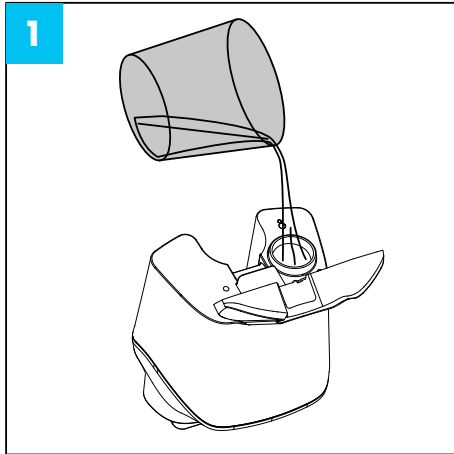

**1.** Open the cleaning water tank cover and fill the tank with water.

**Note:** Do not exceed the maximum water level indicated.

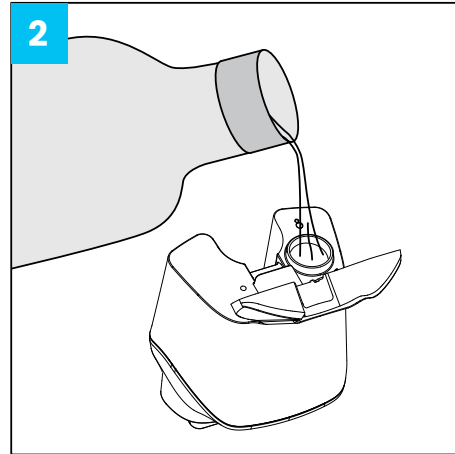

**2.** Pour the fabric detergent into the tank, ensuring the correct proportion of water to detergent for effective cleaning.

## Clean the Dirty Water Tank

It is important to clean the dirty water tank after each use to prevent unpleasant odors.

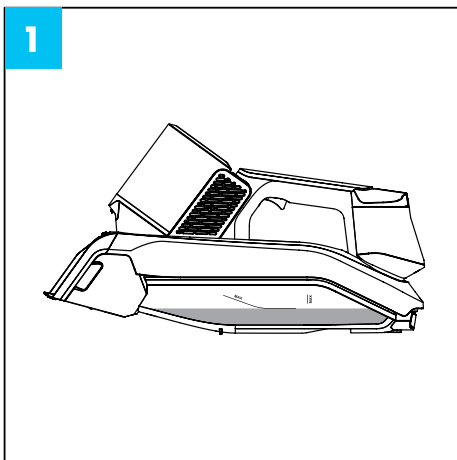

**1.** Please pour out the wastewater before exceeding the maximum water level.

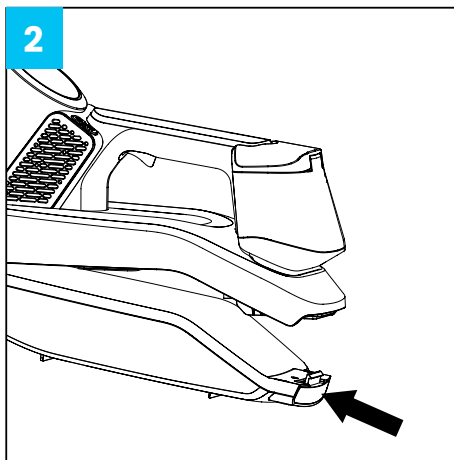

**2.** Press the Wastewater Releasing Button to remove the tank from the machine.

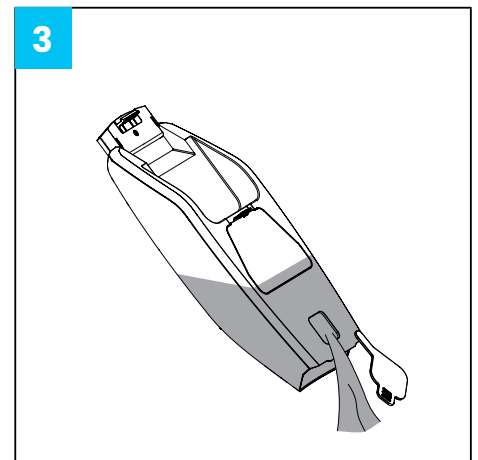

**3.** Open the cap and empty out the wastewater. Clean the tank thoroughly.

## Charging Method

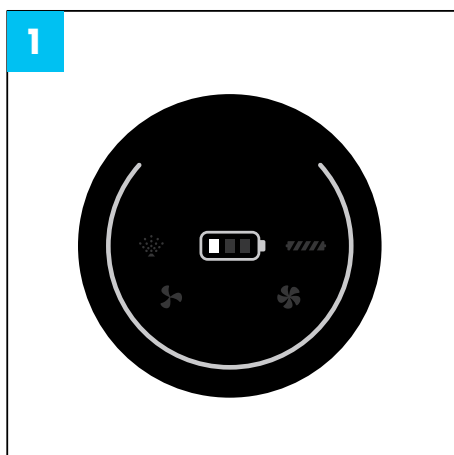

**1.** Charge the device when the low battery indicator is displayed on the screen.

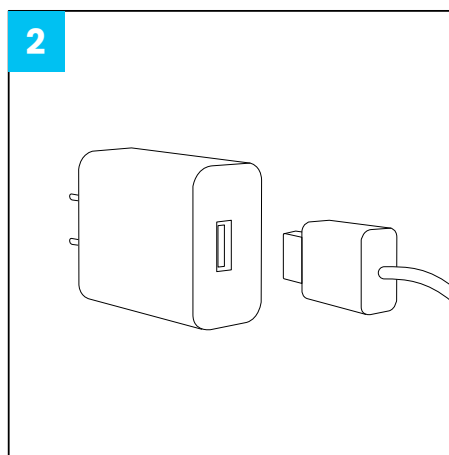

**2.** Use an adapter with a maximum output of 5V/2A. Plug one end of the USB cable into the adapter.

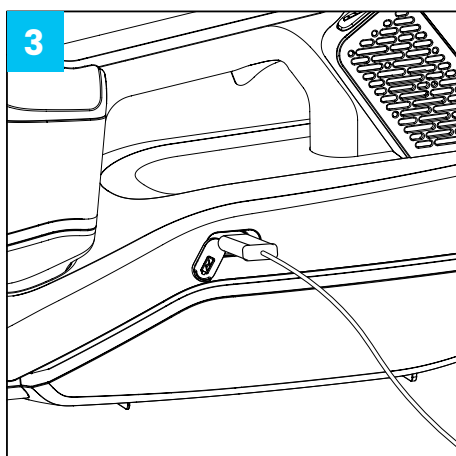

**3.** Connect the Type-C end of the cable to the machine to begin charging.

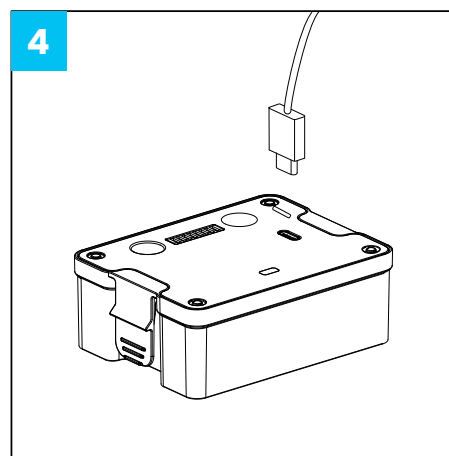

**4.** The battery pack can also be detached and charged separately.

### Note:

Do not use an adapter that is not compatible with the international standard home adapter specifications of 5V/2A.

## Troubleshooting

Please read the table below carefully before contacting the authorized service professionals.

Problem	Possible Cause	Solution
Device does not work upon powering on	<ul style="list-style-type: none"><li>• Out of power</li><li>• Overheating protection activated</li><li>• No battery installed</li></ul>	<ul style="list-style-type: none"><li>• Charge the device</li><li>• Reboot after cooling</li><li>• Install the battery</li></ul>
The suction power is reduced.	<ul style="list-style-type: none"><li>• Wastewater tank is full</li><li>• Suction inlet is blocked</li></ul>	<ul style="list-style-type: none"><li>• Clean out the wastewater tank</li><li>• Rinse the suction inlet</li></ul>
Short operational time	<ul style="list-style-type: none"><li>• The device is not fully charged</li><li>• Battery is old</li></ul>	<ul style="list-style-type: none"><li>• Recharge the battery pack</li><li>• Purchase a new battery</li></ul>
The rolling brush does not rotate	<ul style="list-style-type: none"><li>• The rolling brush is blocked by hair</li><li>• Incorrect installation</li></ul>	<ul style="list-style-type: none"><li>• Clean out the rolling brush</li><li>• Ensure proper installation</li></ul>
The battery indicator LED is flashing.	<ul style="list-style-type: none"><li>• Low battery</li><li>• Battery temperature protection is active</li></ul>	<ul style="list-style-type: none"><li>• Charge before use</li><li>• Allow the device to cool before charging or use</li></ul>
The amount of sprayed water has reduced.	<ul style="list-style-type: none"><li>• Spraying nozzle is blocked</li><li>• Handle or pump is damaged</li></ul>	<ul style="list-style-type: none"><li>• Rinse the nozzle</li><li>• Consult professional staff</li></ul>

## Specifications

Battery Capacity	2000mAh, 11.1V
Input	5V/2A
Recharge Time	3H
Working Time	Up to 20min
Rated Power	60W
Charging Port	Type-C
Suction Power	8000Pa
Noise Level	≤76
Clean Tank Capacity	300ml
Dirty Tank Capacity	500ml

## **Warranty**

Products that you buy directly from our **Powerology** website or shop come with a 24-month warranty.

The 24-month warranty applies to products purchased directly from our **Powerology** website or store. If **Powerology** products are bought from any of our verified retailers, then the product is eligible for only a 12-month warranty. To extend your product's warranty, visit our website **powerology.me/warranty** and fill in your details in the provided form along with an uploaded picture of the product to process your request. Once approved, you will receive a confirmation email of the extended product warranty. Upload the required information within 48 hours of purchase to be eligible for a 24-month warranty period.

For more info, please check:  
**powerology.me/warranty**

## **Contact Us**

If you have any questions about this Privacy Policy, please contact us at: **hey@powerology.me**

Website: **powerology.me**

Instagram: **powerology\_official**

Facebook: **powerology.ME**