



Powerology

**Tilt and Oscillating Fan with
Mist Spray and Humidifier**

SKU: PMFAN75W



Table of Contents

Safety Precautions	2
Initial Setup	4
[A] Unpacking	4
[B] Assembly Guide	4
[C] Water Tank Assembly	6
[D] Filling the Water Tank	6
[E] Important Notes	6
Remote Control Guide	7
Mist Button Guide	8
Timer Button	8
Wind Speed Button	9
Mode Button	9
ON/OFF Button	10
Cleaning and Maintenance	10
Oscillation Button	10
Specifications	11
Compliance and Disposal	11
Warranty	12
Contact Us	12

Safety Precautions

- 1.** Carefully read all instructions before use.
- 2.** When using electrical appliances, always follow basic safety precautions.
- 3.** Connect only to a main power supply of 240-220V~ 50 Hz.
- 4.** This appliance is intended for domestic use only.
- 5.** For indoor use only.
- 6.** Operate the product only when it is fully assembled.
- 7.** Do not use the product if it has been dropped, damaged, or shows signs of malfunction. Do not operate it with a damaged plug or cord.
- 8.** This appliance can be used by children aged 8 years and older, as well as by persons with reduced physical, sensory, or mental capabilities, or those lacking experience and knowledge, provided they have received supervision or instruction on how to use the appliance safely and understand the hazards involved.
- 9.** Children must be supervised to ensure they do not play with the appliance.
- 10.** Cleaning and maintenance should not be performed by children without supervision.
- 11.** Do not operate the fan if the plug or cord is damaged, if there has been a malfunction, or if the fan has been dropped or otherwise damaged.
- 12.** If the power cord is damaged, it must be replaced by a professional service agent to avoid any risk.
- 13.** Do not insert any objects through the grille while the fan is in use.
- 14.** Always operate the fan on a stable, flat, horizontal surface.
- 15.** Keep the fan away from heat sources and areas with corrosive gases.
- 16.** Do not use the fan in combination with or directly next to an air freshener or similar product.
- 17.** To prevent electrical shock, do not immerse the fan, plug, or cord

in water or any other liquids, and do not spray with liquids.

18. Do not leave hair, tissues, tablecloths, clothing, or curtains near any openings of the fan, as they may be drawn into the internal moving parts, causing injury or damage.

19. Ensure the appliance is turned OFF before connecting it to the main power supply.

20. Always ensure your hands are dry before operating or adjusting any switch on the product or touching the plug and power connections.

21. Do not leave the appliance unattended while in use. Turn off and disconnect the appliance when leaving the room for an extended period.

22. Switch off the appliance and unplug it from the power socket when not in use, or before filling, cleaning, or performing any maintenance.

23. Be aware that high humidity levels may promote the growth of biological organisms in the environment.

24. Do not allow the area around the appliance to become damp or wet. If dampness occurs, reduce the humidifier's output. If the output cannot be reduced, operate the appliance intermittently. Do not let absorbent materials, such as carpets, curtains, drapes, or tablecloths, become damp.

25. Unplug the appliance during filling and cleaning.

26. Never leave water in the reservoir when the appliance is not in use.

27. Empty and clean the humidifier before storage, and clean the humidifier before the next use.

28. Microorganisms that may be present in the water or the surrounding environment can grow in the water reservoir and be released into the air, posing serious health risks if the water is not renewed. To prevent this, remove any residual water from the equipment and water tank every three days of use.

29. Empty the tank and refill it every 72 hours. Before refilling, clean

it with fresh tap water or approved cleaning agents as recommended by the manufacturer. Remove any scale, deposits, or film from the sides of the tank and other surfaces, and wipe all surfaces dry.

30. Warning! Never use the appliance without the guards in place. After assembly, do not remove the guards during use or cleaning.

Initial Setup

[A] Unpacking

- 1.** Carefully unpack the mist fan and remove all packing materials.
- 2.** Ensure all parts are present, as the fan can only be assembled if all components are complete.

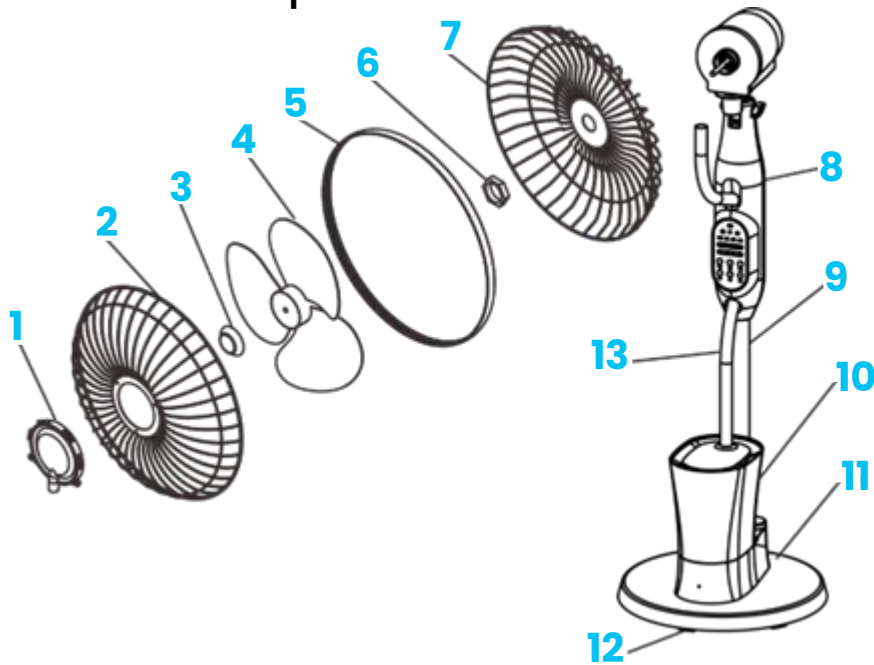

- 3.** Use a soft cloth to remove any dust from the surface that may have accumulated during packing and transport.
- 4.** Place the mist fan on a flat and stable surface.

[B] Assembly Guide

- 1.** Unscrew the screw from the short iron pipe, then pass the wire through the long iron pipe. Place the long iron pipe over the short iron pipe. Align the screw hole of the iron pipe with the base, and secure it using the screws you removed earlier.

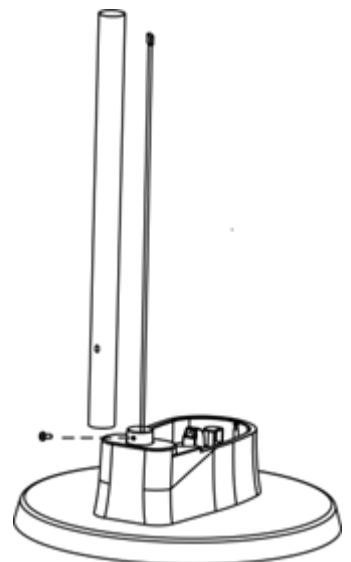

2. First, install the weight plate on the base and fasten it using the M5x25 screws. Cover the metal rods of the five wheels with the black plastic sleeves, then insert them into the holes under the base.

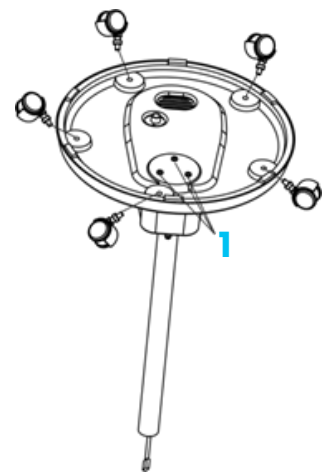

3. Loosen the fixing screw on the fan body, then connect the fan body terminal to the terminal wire on the iron pipe. Tighten the screw to secure the connection.

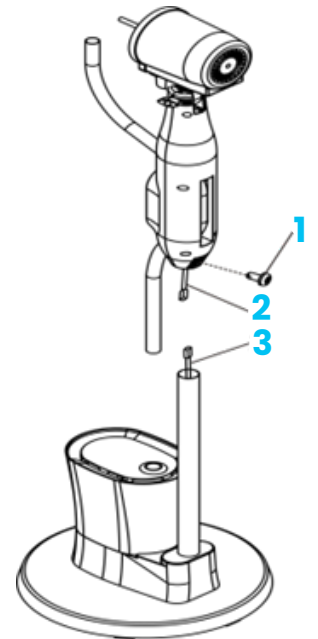

4. Attach the rear grid, plastic nut, blades, and blade spinner to the motor shaft, then secure them in place.

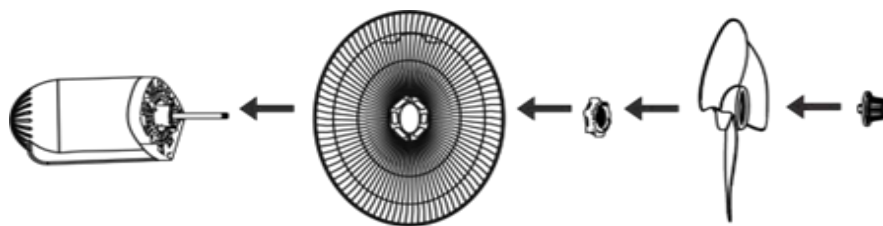

5. Attach the front grid and net frame, and secure them using the screw on the net frame. Insert the upper flexible hose into the mist vent located at the front of the fan grid, ensuring that the hose is not bent or twisted.

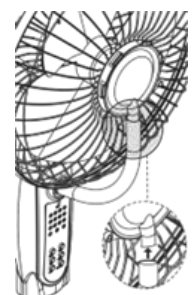
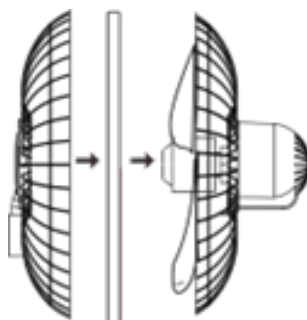

4. If the power cord is damaged, for your safety, please have it replaced by a professional.
5. If the fan makes unusual noises, emits smoke, or stops unexpectedly, disconnect the power immediately and seek professional assistance for maintenance.
6. Except for the maintenance procedures described in this manual, non-professionals should not attempt to repair or maintain the fan.

[C] Water Tank Assembly

1. Place the water tank on the mist generator, ensuring it fits securely into the recess.
2. Attach the cover to the top of the water tank.
3. Insert the lower flexible hose of the fan body into the water tank cover, making sure the hose is not kinked.

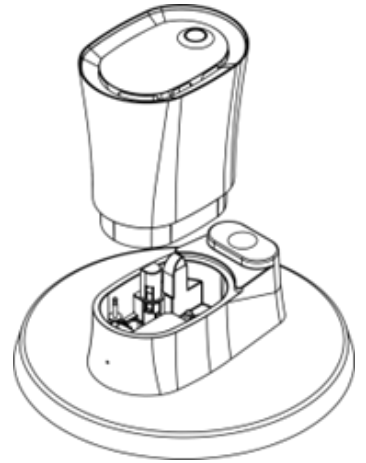

[D] Filling the Water Tank

1. Remove the cover of the water tank.

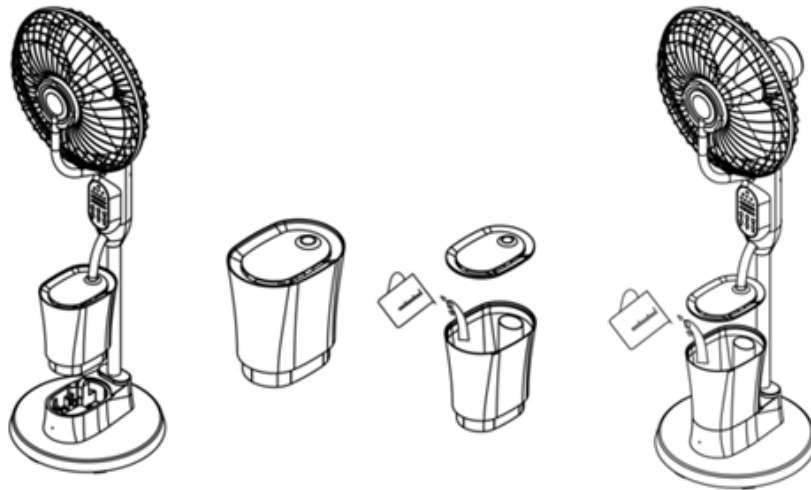

2. Fill the tank with cold and clean water, ensuring not to overfill it.
3. Replace the cover on the tank and then place the tank back on the mist generator

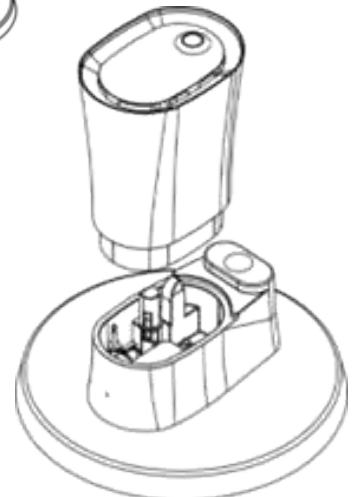

[E] Important Notes

1. Ensure the product is unplugged from the mains power before filling or refilling the water tank.
2. Only use water in the water tank and avoid adding any chemicals, oils, or other additives.
3. Ensure the water temperature does not exceed 50°C.
4. When connected to the power supply, the fan is in standby mode. You can control the fan using the control buttons or the remote.

Remote Control Guide

Note: To operate the remote control, insert two AAA 1.5V batteries into the battery compartment.

1. Remote Control Signal Reception Indicator Light

2. Normal Mode

3. Sleep Mode

4. Natural Mode

5. Timer settings: 0.5H, 1H, 2H, 4H

6. Speed settings: Low, Medium, High

7. Oscillation

8. Maximum Mist

9. Medium Mist

10. Minimum Mist

Control Buttons:

A. Mist

B. Timer

C. Wind Speed

D. Mode

E. Power ON/OFF

F. Oscillation

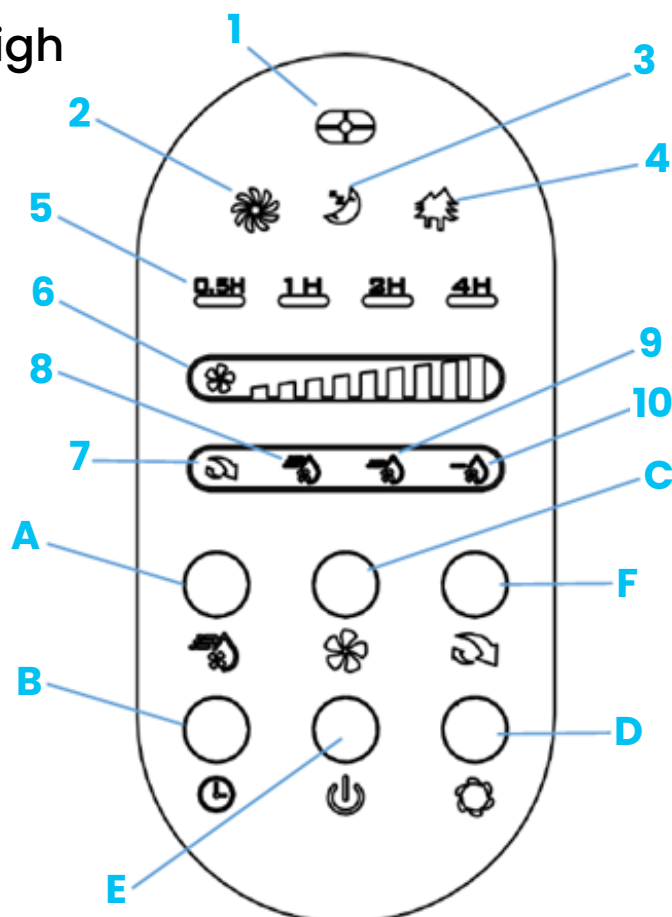

Mist Button Guide

1. Press the Mist button to toggle the ultrasonic mist on or off.
2. Adjust the mist volume (maximum, medium, minimum) by pressing the Mist button multiple times.
3. When the mist function is active, the water tank indicator light will turn green.
4. If the water tank is empty or running low, the indicator light will turn red.
5. The mist function and fan function can be operated independently or simultaneously.

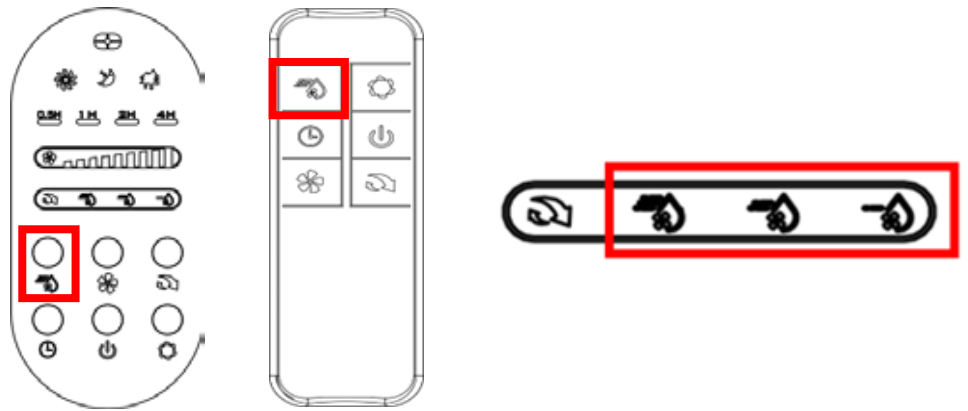

Timer Button

1. Press the Timer button when the fan is on.
2. The indicator will show the time remaining until the fan is scheduled to turn off.
3. Set the operation duration from 0.5 to 7.5 hours in 0.5-hour increments.
4. Repeatedly press the Timer button, and the cumulative value of the lights will display the remaining time until the fan shuts down.

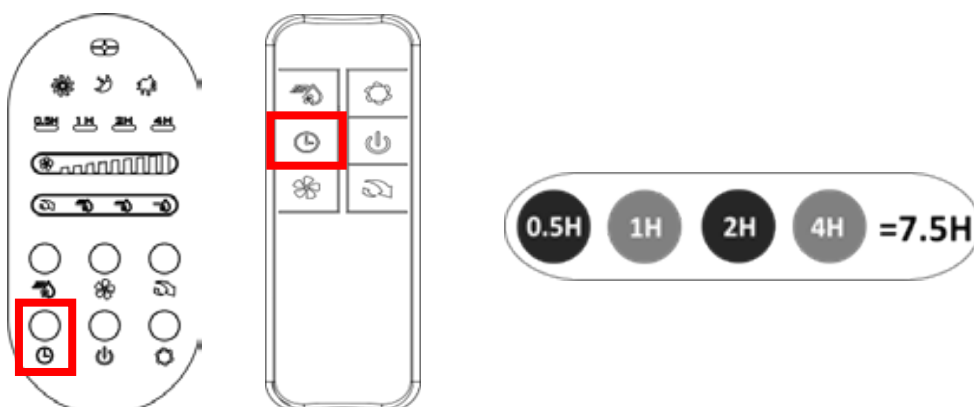

Wind Speed Button

1. Press the Power button to turn the fan on.
2. Adjust the fan speed by selecting from three settings (low, medium, high) using the "Wind Speed" button.
3. Press the button multiple times to cycle through the options.
4. The LED light will indicate the current speed setting: low, medium, or high.

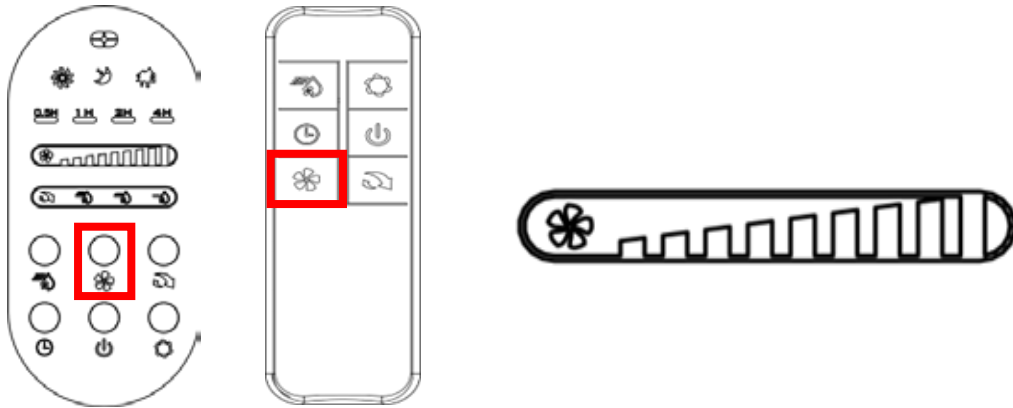

Mode Button

1. Adjust the wind mode by pressing the "Mode" button.
2. Normal Mode: The fan will operate at high, medium, or low settings as selected.
3. Natural Mode: The fan will vary speeds in different patterns to mimic natural airflow.
4. Sleep Mode: The fan will gradually reduce speed following a set pattern, eventually operating at a low speed until it turns off.



ON/OFF Button

1. Press the "ON/OFF" button to turn the fan on or off.
2. Every 72 hours, the control panel lights will flash to indicate that the water tank requires cleaning.
3. Hold the "ON/OFF" button for five seconds to reset.

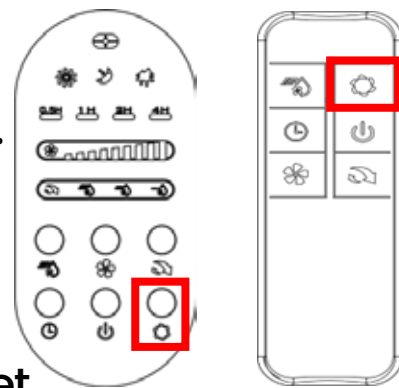

Cleaning and Maintenance

Press the Oscillation button to make the mist fan head oscillate from side to side. Press the button again to stop the oscillation.

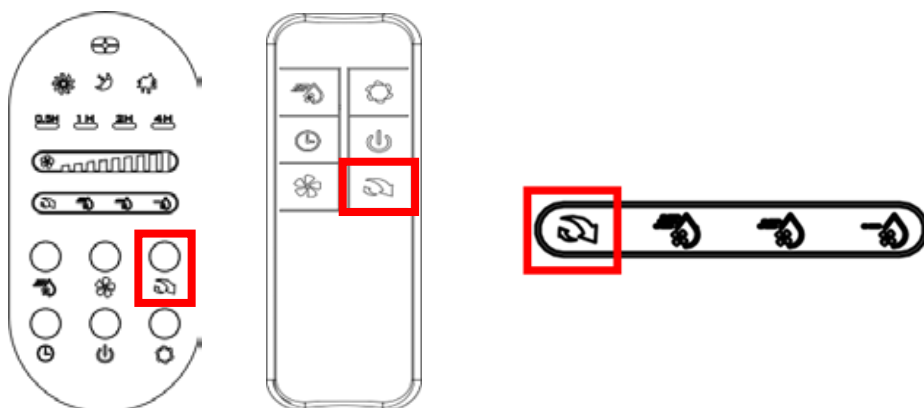

Oscillation Button

1. Always unplug the fan before cleaning.
2. Clean the water tank and change the water every 72 hours to prevent the buildup of scale, algae, or bacteria.
3. If the fan will not be used for an extended period, drain and dry the water tank using a microfiber cloth.
4. Remove the rubber stopper to drain water from the humidifier base.

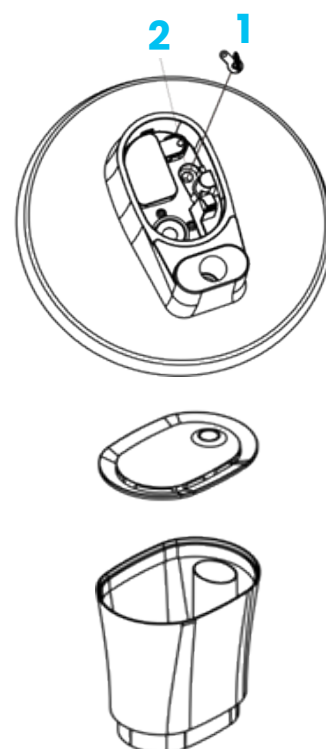

- 5. If storing the fan for a prolonged period, such as over winter, ensure it is kept in a safe location free from dust or damage.
- 6. To prevent damage to the plastic and indicator lights, avoid using abrasive cleaners or chemicals.
- 7. The fan should not be opened by unauthorized individuals.

Caution

- [1] Disconnect the fan from the power source before cleaning.
- [2] After maintenance, ensure all parts, including grilles and blades, are correctly reinstalled as they were before.
- [3] Clean with a soft, damp cloth and then dry with another cloth.
- [4] Avoid using harsh detergents and do not bend the blades.

Specifications

Rated Voltage	220-240V
Rated Frequency	50Hz
Rated Power	75W
Power Plug	UK 3-Pin Plug
Water Tank Capacity	2.8L
Timer Settings	30 Min, 1h, 2h, 4h
Mist Output	< 220ml/h
Diameter	16"
Continuous Mist Time	12h

Compliance and Disposal

 This product complies with relevant European directives.

 The Class II symbol means this appliance has double insulation and does not require an earth connection.

 Regularly clean the water tank every 72 hours to maintain optimal performance.



The crossed-out wheeled bin symbol means that this product should be disposed of separately from household waste. Please recycle this item in accordance with local environmental regulations. Proper disposal helps reduce waste processed by incinerators or landfills and minimizes the potential negative impact on the environment and human health.

Warranty

Products that you buy directly from our **Powerology** website or shop come with a 24-month warranty.

The 24-month warranty applies to products purchased directly from our **Powerology** website or store. If **Powerology** products are bought from any of our verified retailers, then the product is eligible for only a 12-month warranty. To extend your product's warranty, visit our website **powerology.me/warranty** and fill in your details in the provided form along with an uploaded picture of the product to process your request. Once approved, you will receive a confirmation email of the extended product warranty. Upload the required information within 48 hours of purchase to be eligible for a 24-month warranty period.

For more info, please check:
powerology.me/warranty

Contact Us

If you have any questions about this Privacy Policy, please contact us at: **hey@powerology.me**

Website: **powerology.me**

Instagram: **[powerology_official](https://www.instagram.com/powerology_official)**

Facebook: **[powerology.ME](https://www.facebook.com/powerology.ME)**