



**Powerology**

**HIFI Speaker Fridge  
Coffee Table**

SKU: P93CTFBK

# Table of Contents

Safety Precautions	2
Specifications	4
Unpacking and Setup Guide	4
Warnings	6
[A] Power Supply	6
[B] Grounding	6
[C] No Repair	6
[D] Storage	7
[E] Wireless Charger	7
[F] USB	7
[G] Speaker	0
[H] Environment	8
Features	9
Schematic View	10
Control Panel	10
Fridge Operation Guide	11
Speaker Operation Guide	12
Charging Feature Guide	14
Cleaning and Maintenance	15
Cleaning Drawers	16
Transporting the Fridge	17
Troubleshooting	18
Disposal	18
Warranty	19
Contact Us	19

## Safety Precautions

- 1.** Read unpacking instructions carefully. Thoroughly read all instructions and warnings prior to first use. Failure to do so may result in damage to the unit, personal injury, and/or property damage.
- 2. Warning:** You must leave the fridge sitting topside up for a minimum of 2 hours prior to plugging it in and turning it on.
- 3. Warning:** Do not place the fridge upside down, on either end or on any sides.
- 4.** If the power cable is damaged, it must be replaced by the manufacturer, its service agent, or similarly qualified persons to avoid a hazard.
- 5.** Children should be supervised to ensure that they do not play with the appliance.
- 6.** This appliance is not intended for use by persons (including children) with reduced physical, sensory, or mental capabilities or lack of experience and knowledge, unless they have been given supervision or instruction concerning use of the appliance by a person responsible for their safety.
- 7.** Do not store explosive substances such as aerosol cans with a flammable propellant in this appliance.
- 8. Caution:** Changes or modifications to this unit not expressly approved by the party responsible for compliance could void the user's authority to operate the equipment.
- 9.** To satisfy RF exposure requirements, a separation distance of 20 cm or more should be maintained between the antenna of this device and persons during device operation.
- 10.** To ensure compliance, operations closer than this distance are not recommended.
- 11. Warning:** Ensure that all ventilation openings in the appliance

enclosure or the built-in structure remain free from obstructions.

**12. Warning:** Only utilize mechanical devices or other means recommended by the manufacturer to accelerate the defrosting process.

**13. Warning:** Do not damage the refrigerant circuit.

**14. Warning:** Only use electrical appliances within the food storage compartments that are recommended by the manufacturer.

**15.** Adhere to local regulations concerning the disposal of appliances that contain flammable refrigerants and gases. Prior to discarding the appliance, remove the doors to prevent entrapment of children.

**16.** Disposal of the appliance should be conducted by the manufacturer or their service agent, or another qualified individual, to prevent risks of fire and other hazards.

**17.** This equipment has been tested and found to comply with the limits for a Class B digital device, according to Part 15 of the FCC Rules. These limits aim to offer reasonable protection against harmful interference in a residential installation. This equipment generates, uses, and can radiate radio frequency energy. If it is not installed and used according to the instructions, it may cause interference to radio communications. There is no assurance that interference will not occur in a particular installation. If this equipment does cause harmful interference to radio or television reception which can be determined by turning the equipment off and on, the user is encouraged to attempt to rectify the interference through one or more of the following measures:

- Reorient or relocate the receiving antenna. Increase the separation between the equipment and the receiver.
- Connect the equipment to an outlet on a circuit different from that to which the receiver is connected.
- Seek assistance from a dealer or an experienced radio/TV technician.

## Specifications

Voltage	220-240V, 50-60Hz
Consumption	0.35KWh / 24h
USB-A Output	5V/1.5 A
USB-C Output	5V/1.5 A
Wireless Charging	15W
Refrigerant	R600a/25g
Speakers	20W x1
Bluetooth	V 5.0
Net Weight	44Kg
Gross Weight	50Kg
Power Cord	UK 3pin Plug

## Unpacking and Setup Guide

1. Remove all packaging materials.

**Warning:** Remove the table from the foam base before use. Operating it on the foam base may cause personal injury and/or property damage.

2. Peel off the transparent film from the surface of the table.

3. Ensure all accessories are included.

4. Place the table in its intended location.

**Warning:** Position the table ensuring there is more than 40 cm clearance on the front side (speaker side) and at least 50 cm on the back side (furniture side).

**Note:** The table should be on a flat, solid surface.

5. Clean the unit before using it (refer to Maintenance Instructions).

6. Do not connect the power cord to a power source yet. Allow the unit to sit for 2 hours.
7. After 2 hours, the unit is ready to be plugged in and powered on.

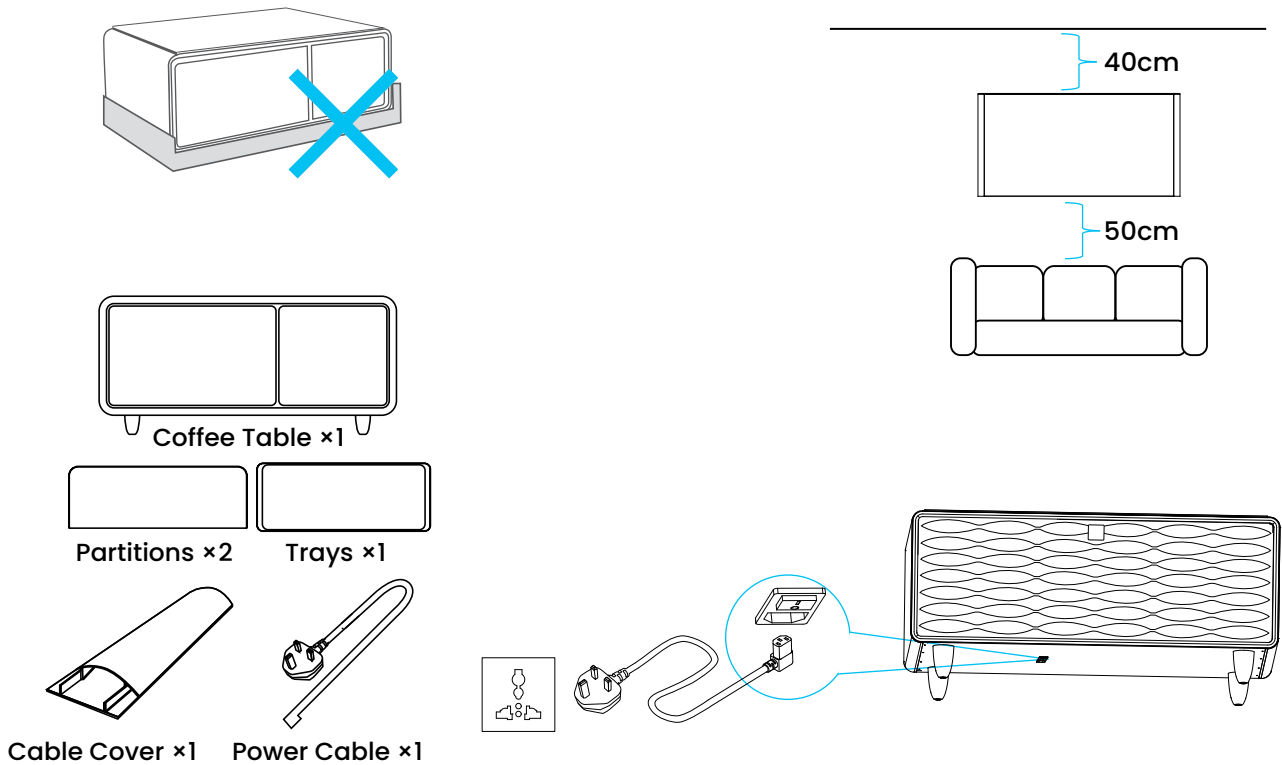

## 8. Warning Notes

- 8.1 Before initially powering on the unit, install the cable cover to protect the cable from damage.
- 8.2 Ensure that the power cord maintains firm contact with the power source to avoid property damage, personal injury, or fire.
- 8.3 To prevent damage to the cable, avoid stepping on it.
- 8.4 Do not roll over the power cord when moving the fridge.
- 8.5 When unplugging the fridge, grasp the plug firmly rather than pulling on the cable to disconnect it from the power source.
- 8.6 Before cleaning, repairing, or replacing any parts, unplug the fridge to prevent electric shock.
- 8.7 Do not use the fridge if the power cable or plug is damaged.

## Warnings

### [A] Power Supply

The fridge should be powered by AC 220V. If the voltage fluctuation is out of the specified range, it may lead to unit failure, property damage, and/or personal injury.

### [B] Grounding

Use an independent power source that is grounded. The fridge power cable is equipped with a grounded plug and socket. Never remove or cut off the third pin.

### [C] No Repair

#### **Warning**

No repairs or modifications should be made to the fridge. Failure to adhere to this warning may result in property damage, personal injury, and/or death.

#### **Note**

The new refrigerant type R600a must be repaired by a trained professional. Improper handling during repair may lead to a fire. Damaged units should be recycled by a professional company or as specified by the state of residence.

### [D] Storage

1. The fridge should not be used to store blood or other biological products.

**2.** The fridge should not be used to store any products that are inflammable, explosive, or dangerous, as well as any chemicals.

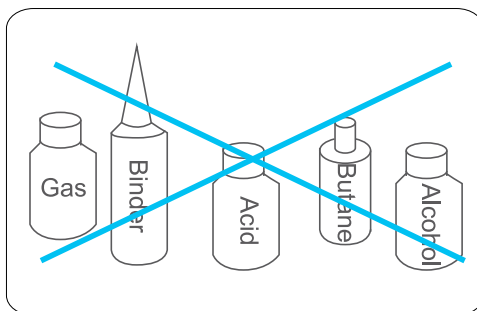

## **[E]** Wireless Charger

**1.** If the device is equipped with a thick, protective shell, a metal protective shell, or a battery shell, the charging efficiency may be affected. Remove the shell and try again.

**2. Warning:** The wireless charger may generate heat during charging. If the battery overheats, the software may limit the charging speed or stop charging until the temperature drops.

**3.** When the wireless charger is in use, USB charging should not be utilized. Conversely, when using USB charging, the wireless charger should not be used.

## **[F]** USB

Keep liquids away from USB ports and avoid using a wet cloth to clean the ports.

## **[G]** Speaker

**1.** The fridge should not be in contact with equipment that is damp hot, or has a strong magnetic or electric current.

**2.** If damage occurs, disengage the fridge from the power supply and remove those items before powering back up.



**3.** Use the fridge only on a horizontal and stable surface with good ventilation.

## **[H]** Environment

**1.** The fridge should be placed far away from any heat source and out of direct sunlight.

**2.** It should be placed in a well-ventilated area, with at least 16 inches of clearance around all sides.

**3.** Do not place the fridge in damp areas or where it may encounter water.

**4.** Do not place power sockets, regulated power supplies, or small appliances on the fridge.

**5.** Avoid placing unstable objects on the fridge to prevent damage to the top surface.

**6.** Exercise caution when placing objects containing liquids on the table; spilling liquid can result in property damage, personal injury, and/or electric shock.

**7.** Do not store gas or any other flammable materials in or near the fridge to avoid potential fire hazards.

**8.** If there is a leak of gas or other flammable materials around the unit, close the gas valve, and open all doors and windows immediately. Do not pull or touch the fridge until the area is clear.

### **Warning**

Do not use the fridge if it has been subjected to any shock or damage. Do not attempt to repair the fridge yourself. Repairing or modifying your fridge may result in property damage, fire personal injury, and/or death.

## Features

**1. Refrigerated Drawers:** The Smart Coffee Table is equipped with two drawers featuring a control panel for temperature adjustments. The refrigerator drawer includes two partitions and one tray, perfect for organizing all your favorite beverages and snacks.

### **Note:**

- a.** Only store fresh food in the fridge.
- b.** Avoid storing foods that require colder environments than the fridge can provide.
- c.** Do not put hot food into the fridge, as it will increase the internal temperature and affect other stored items.
- d.** Avoid opening the drawers frequently or leaving them open, as this will cause the temperature inside to rise.
- e.** Ensure items are securely sealed to prevent excess moisture helping to keep your fridge clean and free of odors.

**2. High Efficiency Compressor:** The fridge is outfitted with a high-efficiency compressor to maintain optimal performance.

**3. Chargers:** The unit features three types of chargers: a 15W wireless charger on the top, two USB Type A chargers, and one USB Type C charger, all located on the side.

**4. Bluetooth Speaker V5.0:** Equipped with Bluetooth v5.0 technology this speaker boasts a transmission distance of 33 feet, allowing easy connectivity to cell phones, computers, laptops, or your TV.

**5. Partition Storage:** To more effectively utilize storage space, the left drawer includes two partitions and one tray, offering flexible use.

**6. Removable Door Seal:** The door seal of the refrigerated drawers ensures longevity and is removable for easy cleaning, helping to reduce energy consumption.

**7. Shelf Storage:** Designed with shelf storage, this feature allows you to place small items and personalize your space.

## Schematic View

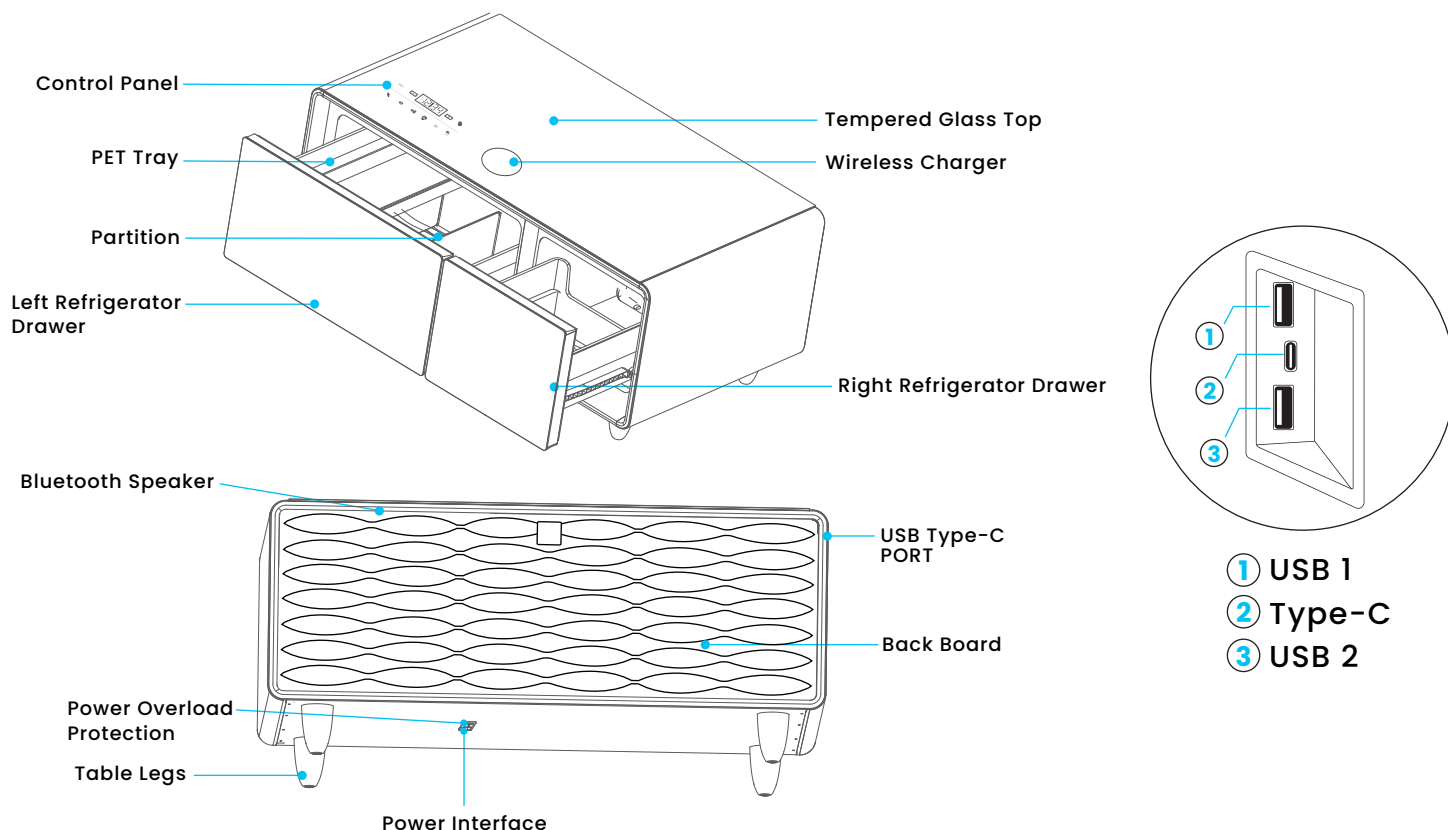

## Control Panel

The Control Panel is thoughtfully divided into two sections by a horizontal line. The area above the line is dedicated to controlling the refrigeration settings, while the area below the line manages the speaker functions.

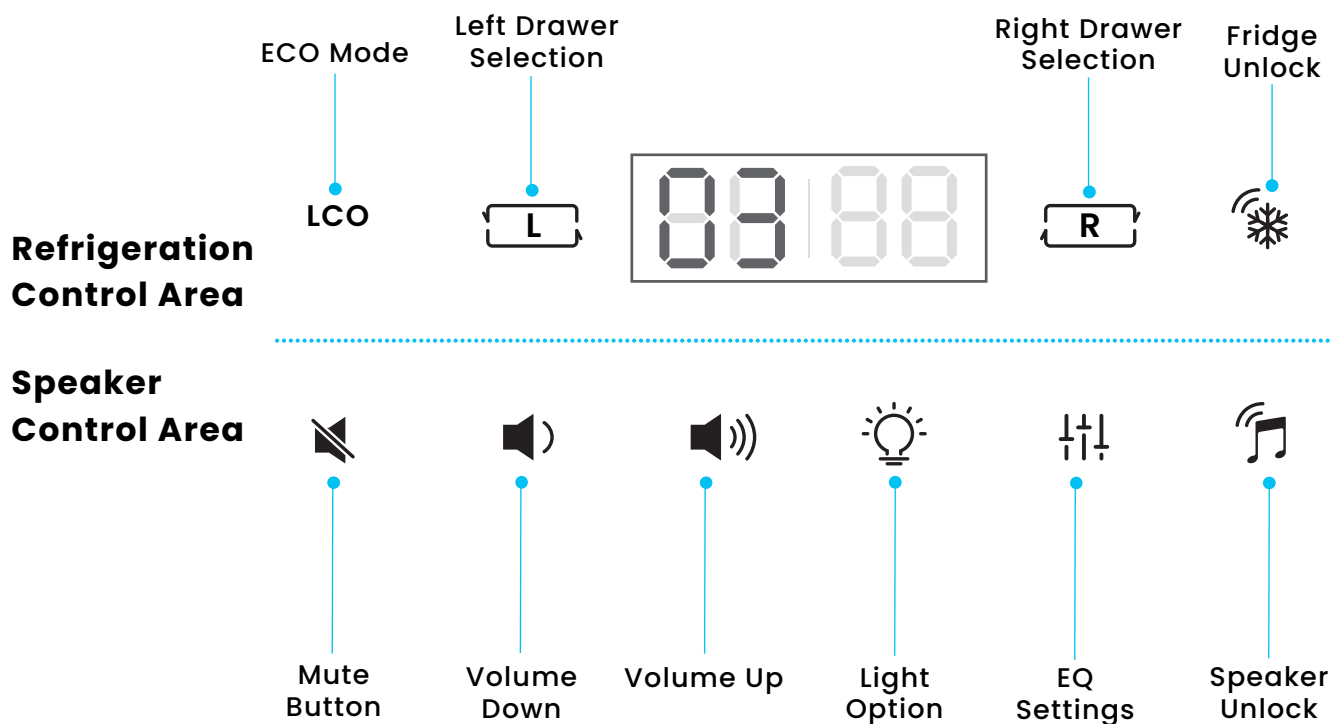

## Fridge Operation Guide

**1.** Upon initial power-on, the fridge automatically enters unlock mode. If there is no operation within 10 seconds, the control panel will automatically lock. When the control panel is in lock mode no information will be displayed.

**Note:** In Locked Mode, no buttons can be used except the Unlock buttons.

**2.** Accessing Refrigeration Settings: Double tap on the Fridge Unlock (❄️). The current drawer temperatures will appear on the display.

**3.** Left Drawer Adjustment:

**3.1** Double tap on the Fridge Unlock (❄️). After unlocking the control panel, tap on the Left Drawer (L) icon.

**3.2** Tap on the Left Drawer (L) icon until the preferred temperature is displayed.

**4.** Right Drawer Adjustment

**4.1** Double tap on the Fridge Unlock (❄️). After unlocking the control

panel, tap on the Right Drawer (  ) icon.

**4.2** Tap on the Right Drawer (  ) icon until the preferred temperature is displayed.

**5.** Eco Mode: Tap the Eco. The display will show "ECO." This setting will adjust both drawers to the most efficient power-saving settings.

**6.** Door Alarm: When a drawer is opened, the temperature of the drawers will be shown on the display. If the drawer is left open, an alarm will beep to remind you to close the drawer.

**7.** Power Off Memory: When the fridge is powered off, the power settings will be memorized and revert to the last settings when powered back on.

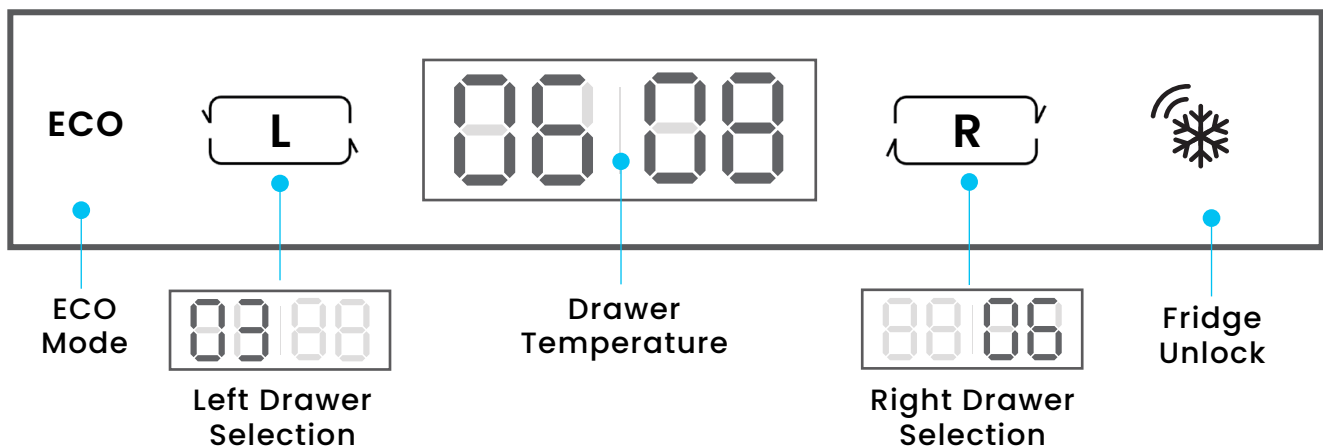

## Speaker Operation Guide

**1.** Accessing Speaker Settings:

**1.1** Double tap on the Speaker Unlock (  ) icon. The speaker will turn on and enter Bluetooth mode.

**1.2** On your device, navigate to Bluetooth settings and select the device "Pow90L." The speaker will announce when the device has been successfully paired. Once paired, you can utilize the Speaker Control Panel.

**2.** Using the Atmosphere Light: Press the Atmosphere Light (  ) icon to turn the light on. To turn it off, press the Atmosphere

Light (💡) icon again.

**3. Music Play:** Double tap the Speaker Unlock (🎵) icon to access the Control Panel.

**4. Mute Music:** Double tap the Speaker Unlock (🎵) icon to access the Control Panel. Press the Mute (🔇) icon.

**Note:** The music will be muted, but the song will continue.

**5. Volume Adjustment:**

**5.1** Double tap the Speaker Unlock (🎵) icon to access the Control Panel. There are 16 levels of volume.

**5.2** Tap the Volume Up (🔊) icon to increase the volume.

**5.3** Tap the Volume Down (🔇) icon to decrease the volume.

**6. Light Option**

Double tap the Speaker Unlock (🎵) icon to access the Control Panel. Press the Light Option (💡) icon to turn the light on. Press the Light Option again to turn the light off.

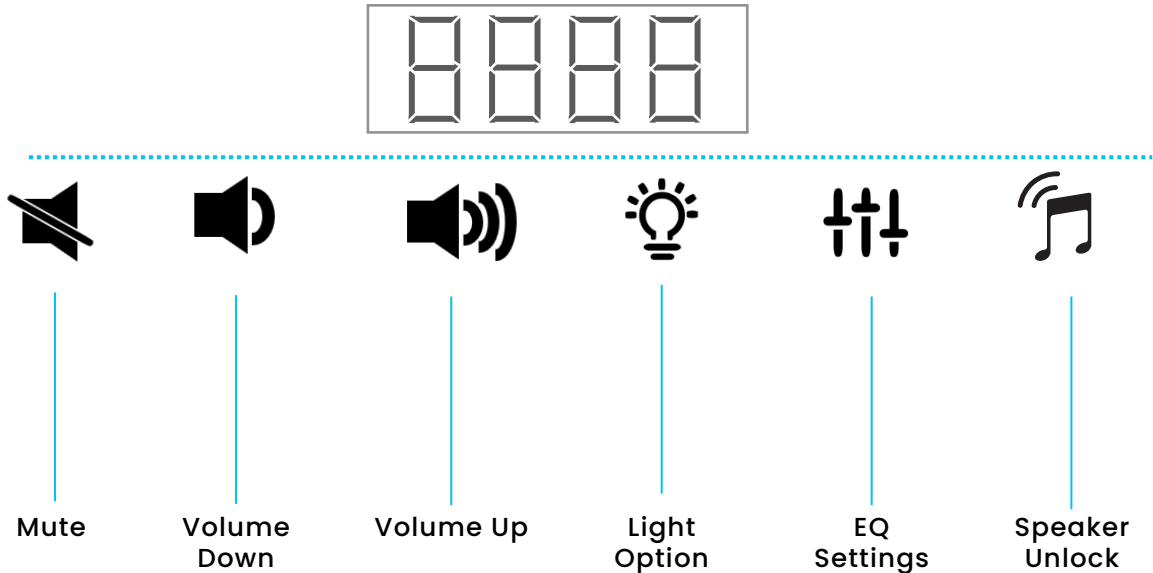

**7. EQ Settings**

Double tap the Speaker Unlock (🎵) icon to access the Control Panel. Tap the EQ Settings (🔊) icon and continue tapping until the desired preset EQ option is displayed on the screen. Preset options include: Auto, Film, Jazz, Pop, Rock

**Note:** If the light option is enabled, the light effects will change based on the selected EQ setting.

**8. Speaker Lock:** If no operation is performed within 10 seconds the Speaker Control Panel will automatically lock.

**9. Speaker Off:** Double click the Speaker Unlock (🎵) icon to access the Control Panel. Long press the Speaker Unlock (🎵) icon until the speaker turns off. The display panel will indicate "OFF."

## Charging Feature Guide

### 1. Wireless Charging

**Note:** The wireless charger only works for devices equipped with wireless charging that meet the Qi standard.

**1.1** Wireless charging is enabled once the table has been plugged in.

**1.2** Place the device at the center of the wireless charging area.

**1.3** Ensure no metal barrier exists between the charger and the phone to prevent overheating.

**1.4** If the charging surface overheats, remove the device and stop charging.

**1.5** The wireless charger and USB charger should not be used simultaneously, as the USB charger will not function.

### 2. USB-A or Type C Charging

**2.1** There are two USB-A chargers that can connect devices to the speaker and charge them.

**2.2** There is one Type C charger that can connect devices to the speaker and charge them.

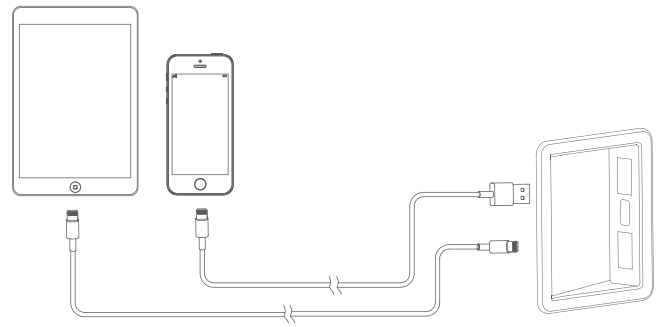
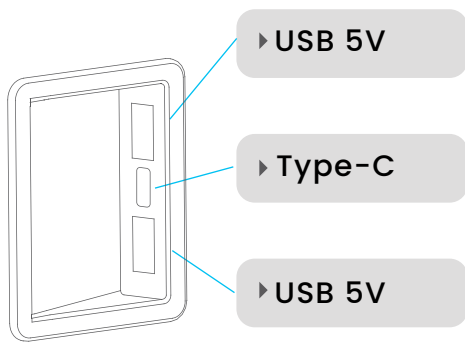

### 3. Charger Specifications

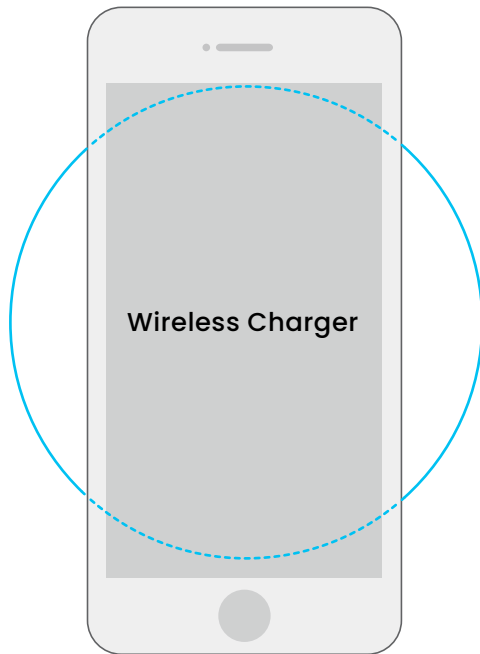

Voltage	12V Input
Output	15W (max)
Sensing Distance	≤4mm
Work Frequency	105-205KHz
Work Temperature	-10°C to 65°C
Work Humidity	10%RH to 75%RH

## Cleaning and Maintenance

1. Clean drawers regularly. Do not leave old food stored in drawers.
2. Unplug the fridge prior to cleaning.
3. Do not disassemble the unit with force, as it may cause damage.
4. Clean the unit with a soft, damp cloth. Dry the unit with a soft cloth.
5. Avoid excessive liquid use, as it may cause deformation or short-circuit the unit. No free-flowing liquid should be used.
6. Clean drawers with a soft, damp cloth and mild detergent. Dry thoroughly with a soft cloth.



7. Inspect the unit after cleaning. Do not use it if any damage is found.
8. Ensure the unit is completely dry before plugging it back in.  
**Note:** Clean the door seal thoroughly to maintain a long-lasting seal and optimize power consumption.
9. The fridge is heavy. Protect the floor when cleaning the unit.
10. When moving the fridge, avoid shaking it.
11. Do not use hot water to clean the glass top or any other part of the fridge, including drawers, trays, and partitions.

## Cleaning Drawers

1. Before removing the drawers, remove the trays and partitions.
2. Pull the drawer as far as it will go, then lift and pull gently.
3. Clean the drawers, trays, and partitions, as they can be washed.
4. Clean the door seals.
5. Ensure all parts are thoroughly dried before placing the drawers back into the unit.

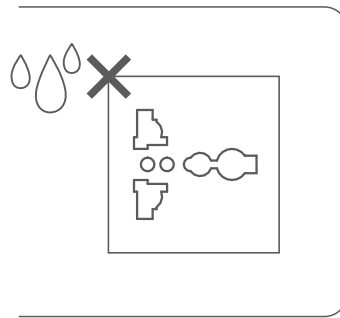
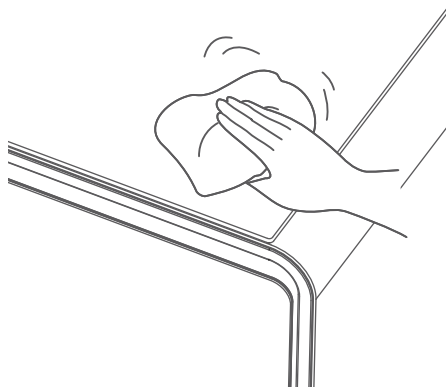

### Warning

1. Do not spray water onto or into the unit.
2. Ensure the unit is completely dry before reconnecting it to the power source.
3. Avoid using the following substances: Acidic or alkaline solutions or powders, Benzene, sodium bicarbonate, alcohol, carious acids

or petroleum, Abrasive cleaners, Abrasive sponges or hard brushes  
Hot water.

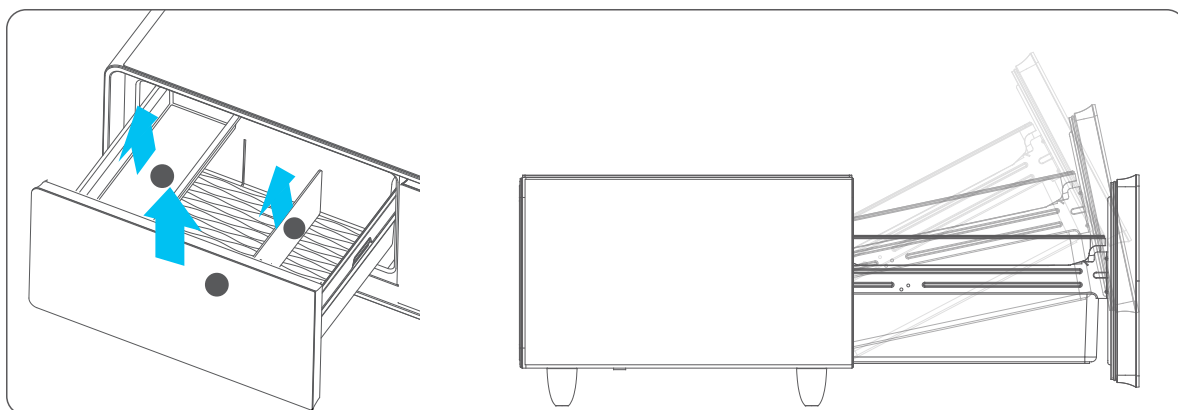

## Transporting the Fridge

1. Unplug the fridge.
2. Secure the trays and partitions.
3. Do not tilt or stand the fridge upright. The maximum incline should be less than  $45^\circ$ , as inclining more can cause damage to the refrigeration system.
4. Refrigerated drawers will remain cool for 1 to 2 hours without power. However, once the power is shut off, do not open the drawers to preserve the internal temperature.

### Warnings

1. Any power failure can cause temperatures to rise, shortening the lifespan and quality of stored food. If the fridge is without power for an extended period, unplug the unit and thoroughly clean it.
2. If leaving your home for an extended vacation, power off the fridge and remove all perishable items from the unit.

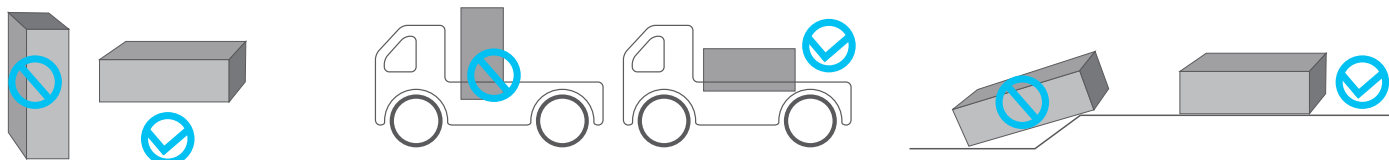

## Troubleshooting

Problem	Possible Cause	Solution
The power light is on, and the compressor is working but making a "humming" sound.	The power voltage is lower than 187V.	Stop using the refrigerator and wait for the voltage to stabilize within the normal range.
The compressor starts but stops after about one minute then continues to start and stop repeatedly.	The power voltage is higher than 242V.	
The compressor runs for a long time, but the evaporator surface is frost-free.	There is a leak.	Arrange for a professional inspection to identify the issue.
	There is a blockage.	Consult a professional for further inspection and necessary repairs.
There is frost on the surface, but the compressor keeps working.	There is excessive frost on the evaporator.	Defrost the refrigerator to address the issue.
	The drawers have been opened for a long time.	Avoid opening the drawers frequently to maintain the internal temperature.
	The drawers are filled with too many items.	Remove excess items from the drawers to improve airflow and efficiency.
	The condenser has poor heat dissipation.	Move the refrigerator to a well-ventilated area.
	The thermostat is failing, or the sensor is missing.	Seek professional assistance for a thorough inspection.
The refrigerator is not working or refrigerating.	The fuse is blown, and the power light is off.	Replace the blown fuse to restore power.
	The input controlling circuit has a fault and the power light is off.	Contact a professional to inspect and resolve issues with the control circuit.
There is excessive noise coming from the refrigerator.	The machine is placed unevenly.	Adjust the refrigerator's feet to ensure it is level.
	An inner fastener is loose.	Tighten any loose fasteners inside the refrigerator.
	There is a collision between pipes.	Request a professional inspection to address any potential safety concerns.
The refrigerator can refrigerate, but touching the surface causes a slight tingling sensation, and an electroprobe test shows a bright light.	Induced electricity is leaking.	Check and repair the grounding wire to ensure safety.

## Disposal

This product must not be disposed of as unsorted household waste. It is important to separate such waste for proper treatment and recycling, in compliance with local waste management regulations.

## **Warranty**

Products that you buy directly from our **Powerology** website or shop come with a 24-month warranty.

The 24-month warranty applies to products purchased directly from our **Powerology** website or store. If **Powerology** products are bought from any of our verified retailers, then the product is eligible for only a 12-month warranty. To extend your product's warranty, visit our website **[powerology.me/warranty](https://powerology.me/warranty)** and fill in your details in the provided form along with an uploaded picture of the product to process your request. Once approved, you will receive a confirmation email of the extended product warranty. Upload the required information within 48 hours of purchase to be eligible for a 24-month warranty period.

For more info, please check:  
**[powerology.me/warranty](https://powerology.me/warranty)**

## **Contact Us**

If you have any questions about this Privacy Policy, please contact us at: **[hey@powerology.me](mailto:hey@powerology.me)**

Website: **[powerology.me](https://powerology.me)**

Instagram: **[powerology\\_official](https://www.instagram.com/powerology_official)**

Facebook: **[powerology.ME](https://www.facebook.com/powerology.ME)**