



Powerology 150W Inverter AC

Universal USB A 2*Type-C DC Car 12V 10A

SKU: P150INV

Table of Content

Product Overview 2

Schematic View of the Inverter 2

Dimensions 3

Specifications 3

Operation 3

Warnings 4

Warranty 5

Contact Us 5

Before installing and using the product, please carefully read this User Manual to guarantee correct usage and keep it secure for future reference.

Product Overview

This product is designed to be connected to a 12V car cigarette lighter port. When connected, it provides a 110V electrical supply and USB capability.

Schematic View of the Inverter

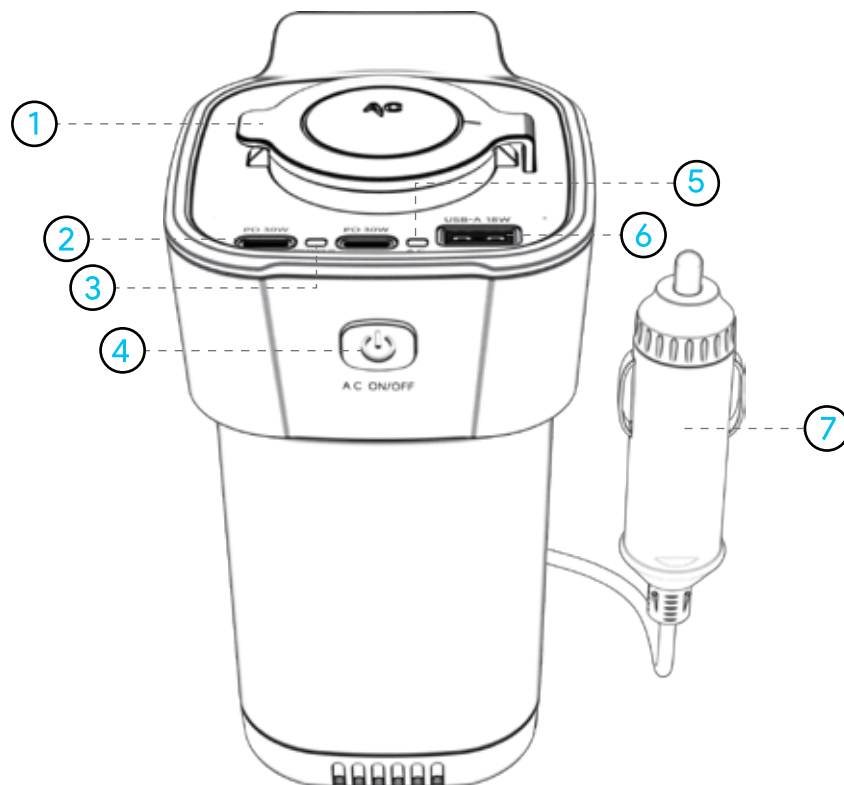

- 1 . AC Output
- 2 . PD 30W *2
- 3 . Power Indicator Light
- 4 . AC Switch

- 5 . AC Indicator Light
- 6 . USB-A PD 18W
- 7 . Cigarette Lighter Plug

Dimensions

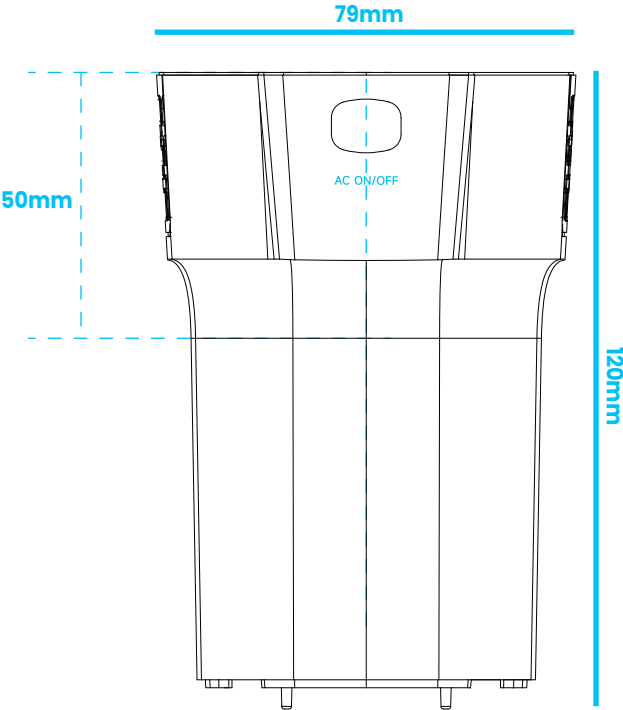

Specifications

Model	P150INV
USB Type-C Output	2* 30W PD
Size	142.7×81.5×79.2mm (5.6×3.2×3.1 inch)
Input	12V
USB Type-A Output	18W PD
AC Output	150W (Max.) / 230V

Operation

- 1 . Start the car.
- 2 . Connect the cigarette lighter plug to the car's cigarette lighter socket.

- 3 . The indicator light should activate, signaling that the inverter is operational.
- 4 . Ensure the total power usage of the devices connected does not exceed 150W.
- 5 . Connect the device to the AC socket and plug any USB devices into the available USB ports.
- 6 . Proceed with usage.

Warnings

- 1 . Ensure that the combined power usage of all devices does not exceed 150W in total.
- 2 . When using the AC socket, the female cigarette lighter port, and USB simultaneously, verify that their total power does not surpass 150W, as this is the maximum power input for the inverter's line.
- 3 . Do not initiate the car's engine while devices are connected to the inverter.
- 4 . Please adhere strictly to the product specifications when using this device.
- 5 . It is designed exclusively for a 12V car cigarette lighter plug. It is not recommended to use the product with a 24V car cigarette lighter plug as it contravenes the product's design parameters.
- 6 . Do not connect devices that require more electricity than this product's specified power capacity. Exceeding the recommended power usage may result in damage to the product or the connected devices.
- 7 . Keep the product dry as exposure to moisture can lead to combustion and explosion. Should you observe smoke or sparks emanating from the product, maintain a safe distance from your vehicle and promptly contact emergency services.

Warranty

Products that you buy directly from our **Powerology** website or shop come with a 24-month warranty. The 24 months warranty applies to products purchased directly from our **Powerology** website or store. If **Powerology** products are bought from any of our verified retailers, then the product is eligible for only 12 months warranty. To extend your product's warranty, visit our website **powerology.me/warranty** and fill your details in the provided form along with an uploaded picture of the product to process your request. Once approved, you will receive a confirmation email of the extended product warranty. Upload the required information within 48 hours of purchase to be eligible for 24 months of warranty period.

For more info, please check:

powerology.me/warranty

Contact Us

If you have any questions about this Privacy Policy, please contact us at: **hey@powerology.me**

Website: **powerology.me**

Instagram: **powerology_official**

Facebook: **powerology.ME**