



Powerology

**Adjustable Long Arm 360°
Rotatable Suction Phone Holder**

SKU: PLARSPH

Table of Contents

Features.....	2
Caution.....	2
Schematic View of the Product.....	3
Dimensions.....	4
Product Adjustment.....	4
Warranty.....	5
Contact Us.....	5

Before installing and using the product, please carefully read this User Manual to guarantee correct usage and keep it secure for future reference.

Features

1. Combination of Plastic, Metal, and Aluminum Alloy; The entire structure is crafted from high-quality aluminum alloy for a sophisticated and minimalist design.
2. Accommodates mobile phones or tablets ranging from 4.7 to 12.9 inches.
3. Foldable design easy storage.
4. Features a 360-degree rotatable head for versatile positioning.
5. Equipped with an extendable arm for comprehensive maneuverability.
6. Part of the quick-release series, compatible with various bases for flexible use.
7. The base is engineered with powerful suction capabilities, ensuring a secure grip on smooth glass surfaces.
8. The base can accommodate to the Apple pencil.

Caution

1. The holder is rated for a maximum weight of 1 kg; exceeding this limit is not recommended.
2. Children should operate the holder only under adult supervision.
3. Ensure the base is attached to a surface that is dry, clean, and flat for optimal security.
4. The user is held responsible for any issues arising from misuse, disassembly, or unauthorized alterations.

Schematic View of the Product

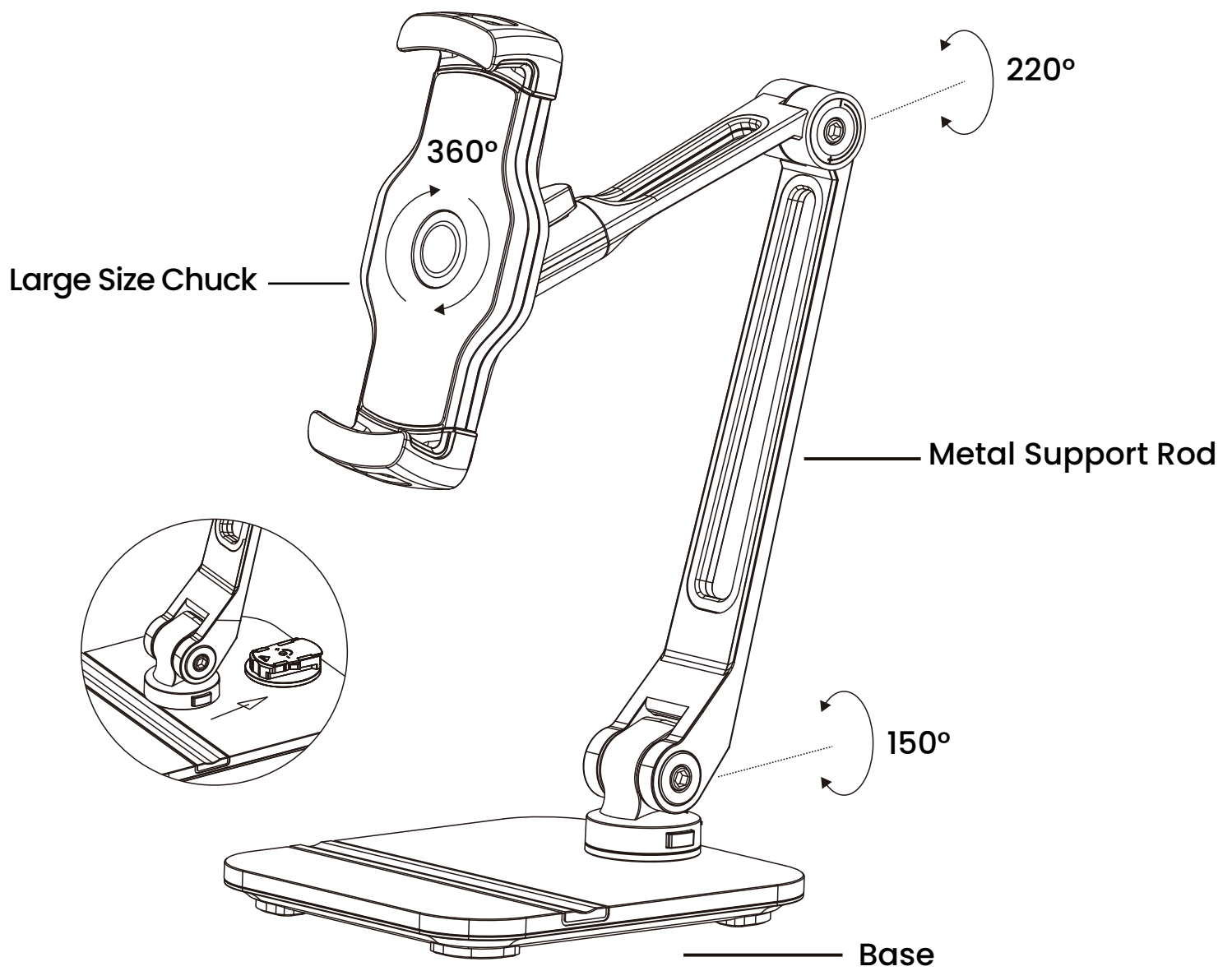

Optional

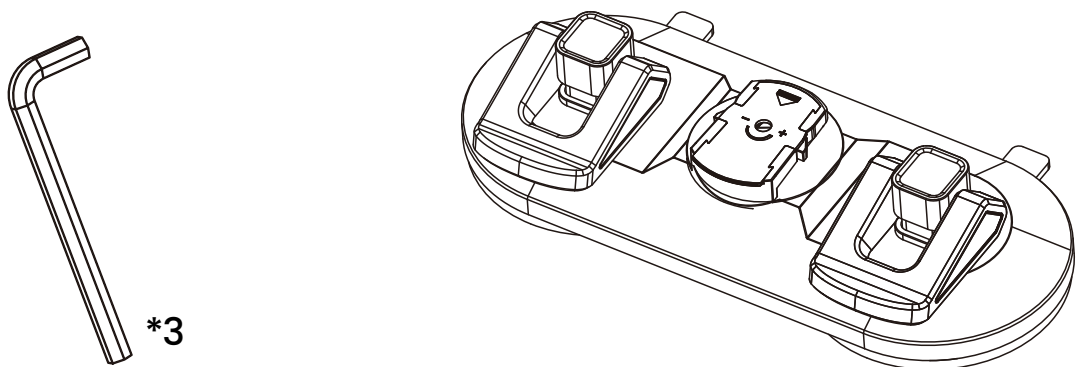

Dimensions

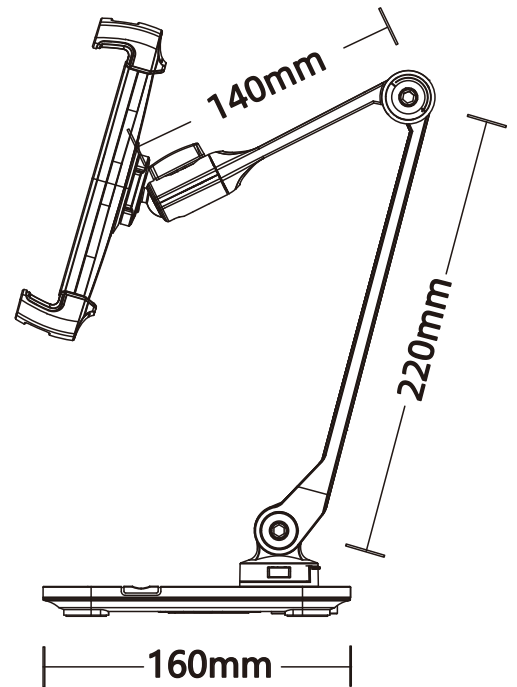
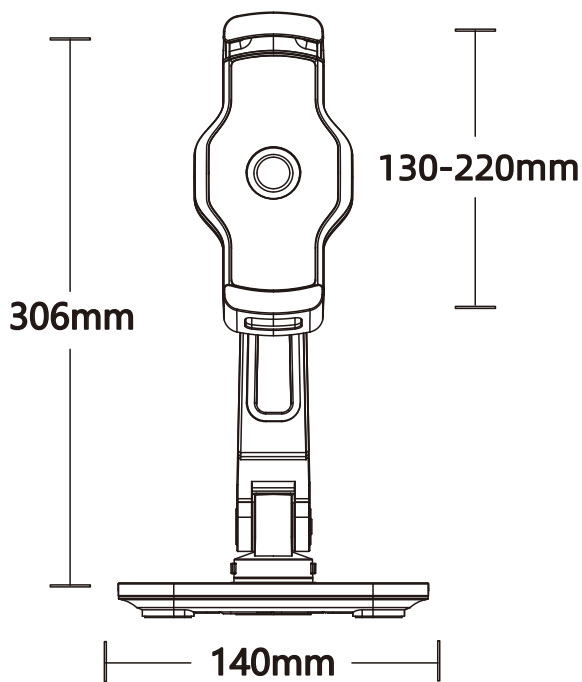

Product Adjustment

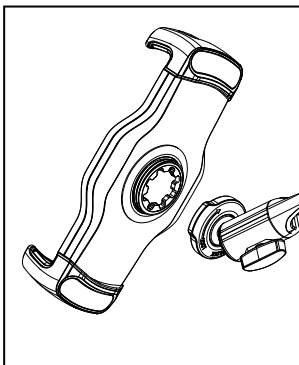

Step 1: To install the collet, rotate it in the direction indicated by the arrow.

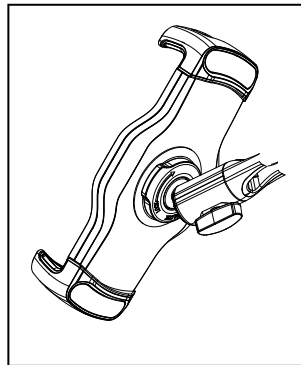

Step 2: Adjust the tightness of the collet's rotation by turning it to the desired resistance level.

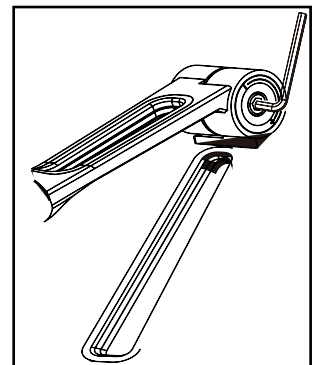

Step 3: Use a large Allen key to fine-tune the vertical tightness for secure positioning.

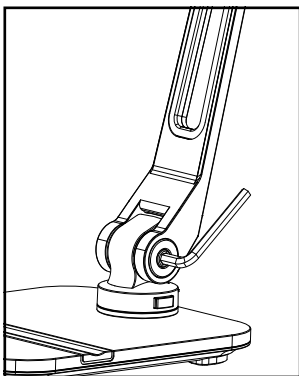

Step 4: Utilize a large Allen wrench to adjust vertical tension.

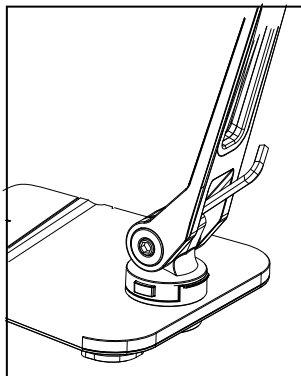

Step 5: Employ a medium Allen wrench to fine-tune vertical tension.

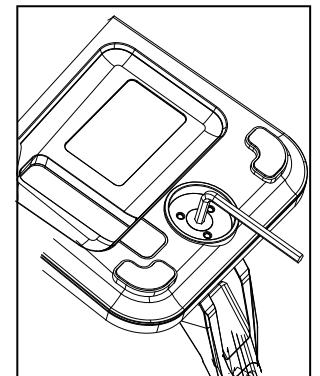

Step 6: Use a large Allen wrench for base tension adjustment.

Warranty

Products that you buy directly from our **Powerology** website or shop come with a 24-month warranty.

The 24-month warranty applies to products purchased directly from our **Powerology** website or store. If **Powerology** products are bought from any of our verified retailers, then the product is eligible for only a 12-month warranty. To extend your product's warranty, visit our website **powerology.me/warranty** and fill in your details in the provided form along with an uploaded picture of the product to process your request. Once approved, you will receive a confirmation email of the extended product warranty. Upload the required information within 48 hours of purchase to be eligible for a 24-month warranty period.

For more info, please check:
powerology.me/warranty

Contact Us

If you have any questions about this Privacy Policy, please contact us at: **hey@powerology.me**

Website: **powerology.me**

Instagram: **powerology_official**

Facebook: **powerology.ME**